

PARTIAL BOUNDARY SURVEYS - AREA "C"
WISTER LAKE

POTEAU RIVER, OKLAHOMA

Performed Under Contract Number DACW 56-71-G-0213

SEC. 16 T-5N R-22E COUNTY LeFlore

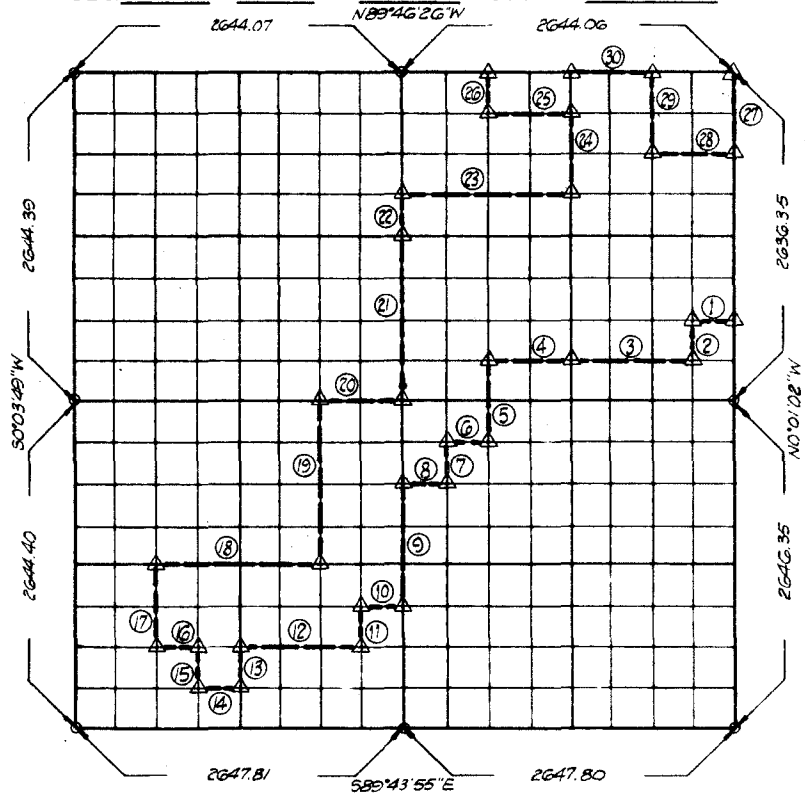

Course No.	Distance	Bearing
1	330.68	N89°45'29"W
2	330.78	S0°00'44"E
3	992.13	N89°45'20"W
4	661.43	N89°45'20"W
5	661.40	S0°00'46"W
6	330.77	N89°45'07"W
7	330.69	S0°01'06"W
8	330.83	N89°44'51"W
9	992.01	S0°01'23"W
10	330.89	N89°44'23"W
11	330.65	S0°01'41"W
12	992.76	N89°44'14"W
13	330.61	S0°02'36"W
14	330.95	N89°44'04"W
15	330.60	N0°02'54"E
16	330.92	N89°44'14"W
17	661.16	N0°03'13"E

Course No.	Distance	Bearing
18	1323.44	S89°44'36"E
19	1322.57	N0°02'08"E
20	661.49	S89°45'10"E
21	1322.69	N0°01'23"E
22	330.67	N0°01'23"E
23	1322.40	S89°45'58"E
24	661.46	N0°00'10"E
25	661.08	N89°46'17"W
26	330.70	N0°00'47"E
27	661.59	S0°01'02"E
28	661.13	N89°46'07"W
29	661.53	N0°00'26"W
30	661.02	N89°46'26"W

CERTIFICATE OF SURVEY Field Book No. 1-200 Date 12/28/71

I HEREBY CERTIFY THAT THE ABOVE PLAT IS A TRUE AND CORRECT REPRESENTATION OF THE SURVEY MADE IN SECTION 16, T-5N, R-22E LeFlore COUNTY, OKLAHOMA

PHILLIPS & STONG ENGINEERING CO.
Under the Supervision of
U.S. ARMY ENGINEER DISTRICT, TULSA
CORPS OF ENGINEERS

LEGEND
▲ MONUMENT
□ ORIGINAL CORNER
○ IRON PIN

Edwards M. Coon