

PARTIAL SURVEYS

EUFAULA RESERVOIR

CANADIAN RIVER, OKLAHOMA

Performed Under Contract Number DACW 56-70-C

SEC. 4 T. 11N R. 15E COUNTY MCINTOSH

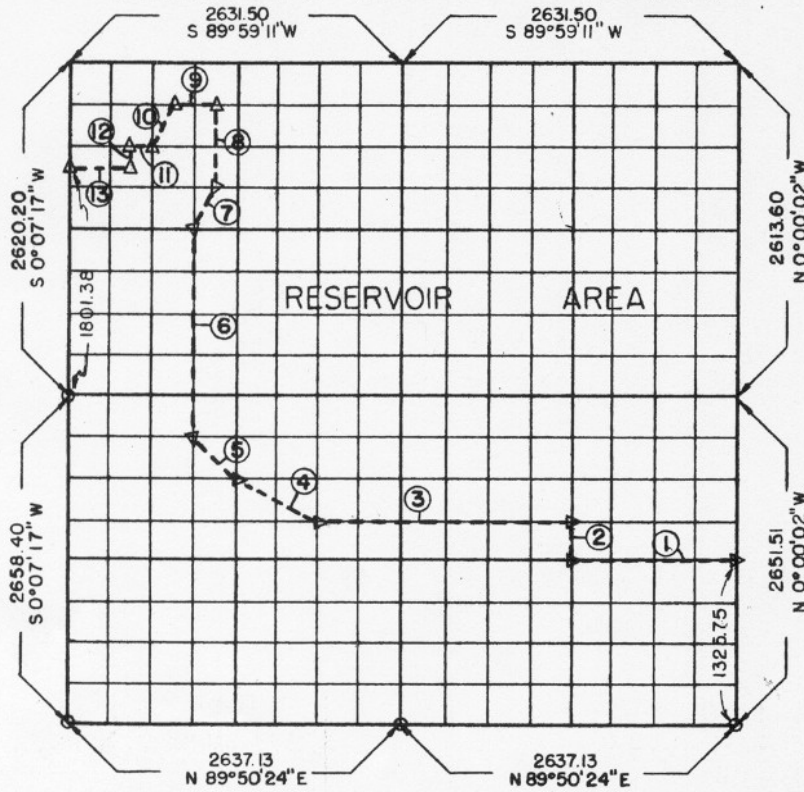

Course No.	Distance	Bearing	Course No.	Distance	Bearing
1 *	1317.86	S 89°52'38" W			
2	331.65	N 0°01'47" E			
3	1976.52	S 89°53'12" W			
4	736.74	N 63°19'19" W			
5	466.94	N 44°45'45" W			
6	1641.62	N 0°05'54" E			
7	366.75	N 26°45'15" E			
8	654.69	N 0°05'41" E			
9	328.98	S 89°58'39" W			
10	366.75	S 26°45'16" W			
11	164.51	S 89°58'06" W			
12	163.72	S 0°06'36" W			
13	493.57	S 89°57'50" W			
* This monument set 5.77 N 89°52'38" E of actual point.					
Distance of Course 1 on the ground is			1312.09		
9010.30					

CERTIFICATE OF SURVEY

Field Book No. E-1132, Date 9-15-70

I HEREBY CERTIFY THAT THE ABOVE PLAT IS A TRUE AND CORRECT REPRESENTATION OF THE SURVEY MADE IN SECTION 4, T. 11N, R. 15E, MCINTOSH COUNTY, OKLAHOMA

Edward M. Coon
LICENSED LAND SURVEYOR

PHILLIPS & STONG ENGINEERING CO.
Under the Supervision of
U.S. ARMY ENGINEER DISTRICT, TULSA
CORPS OF ENGINEERS
SHEET 1 of 1

LEGEND

- ▲ MONUMENT
- ◻ ORIGINAL CORNER
- IRON PIN

86