

EUFAULA RESERVOIR CANADIAN RIVER OKLAHOMA

PARTIAL BOUNDARY SURVEYS OF SECTION 25, T12 N., R15 E., MCINTOSH COUNTY

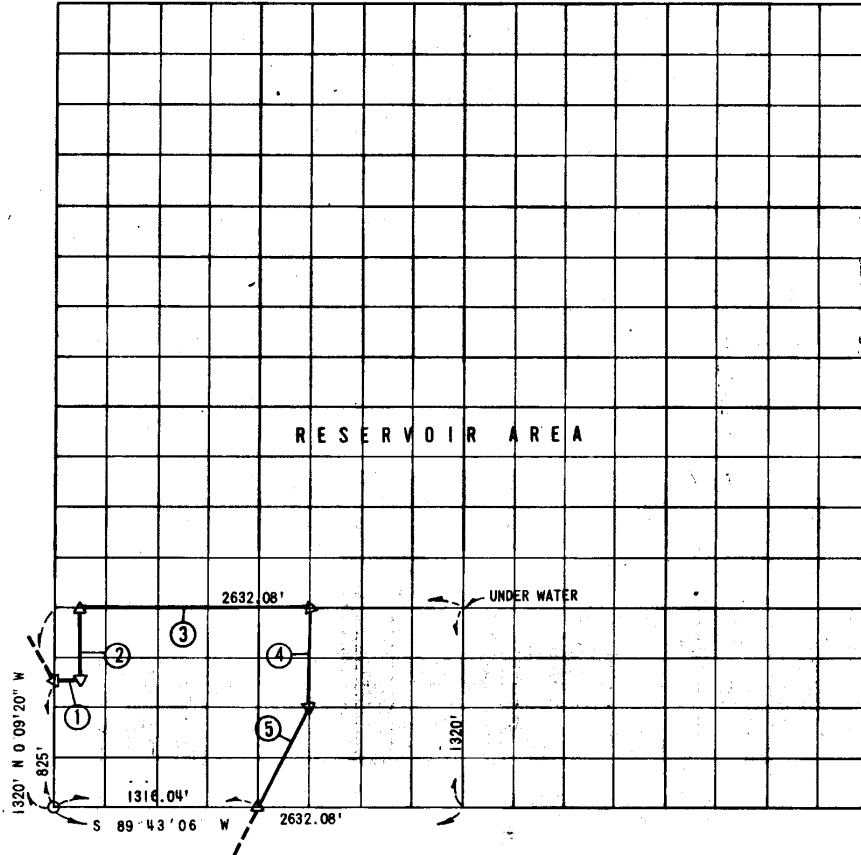

| COURSE | DISTANCE | BEARING | COURSE | DISTANCE | BEARING |
|---------|----------|-----------------|--------|----------|---------|
| 1 | 164.51 | N 89° 43' 06" E | | | |
| 2 | 495.00 | N 0° 09' 20" E | | | |
| 3 | 1480.54 | N 89° 43' 06" E | | | |
| 4 | 660.00 | S 0° 09' 20" W | | | |
| 5 | 739.70 | S 26° 33' 52" W | | | |
| 3539.75 | | | | | |

FIELD BOOK NO. E 1107

LEGEND

C & E MONUMENT HWY DEPT MON
 ORIGINAL STONE IRON PIN

54

CONTRACT NO. DACW56-70-C-0090
 PERFORMED UNDER SUPERVISION OF
 US ARMY ENGINEER DISTRICT, TULSA
 CORPS OF ENGINEERS

BY
SLADE & ASSOCIATES

CONSULTING ENGINEERS
 1501 CLARENCE BLVD., SUITE 200
 OKLAHOMA CITY, OKLAHOMA 73102

CERTIFICATE OF SURVEY
 THIS DRAWING CORRECTLY REPRESENTS A SECTION SURVEY
 COMPLETED UNDER MY SUPERVISION SEPTEMBER 1970

JAMES L. SLADE
 REGISTERED LAND SURVEYOR