

PARTIAL BOUNDARY SURVEYS

EUFAULA LAKE

DEEP FORK RIVER

Performed Under Contract Number DACW 56-75-C-0137

SEC. 28, T 12 N, R 15 E, MCINTOSH COUNTY

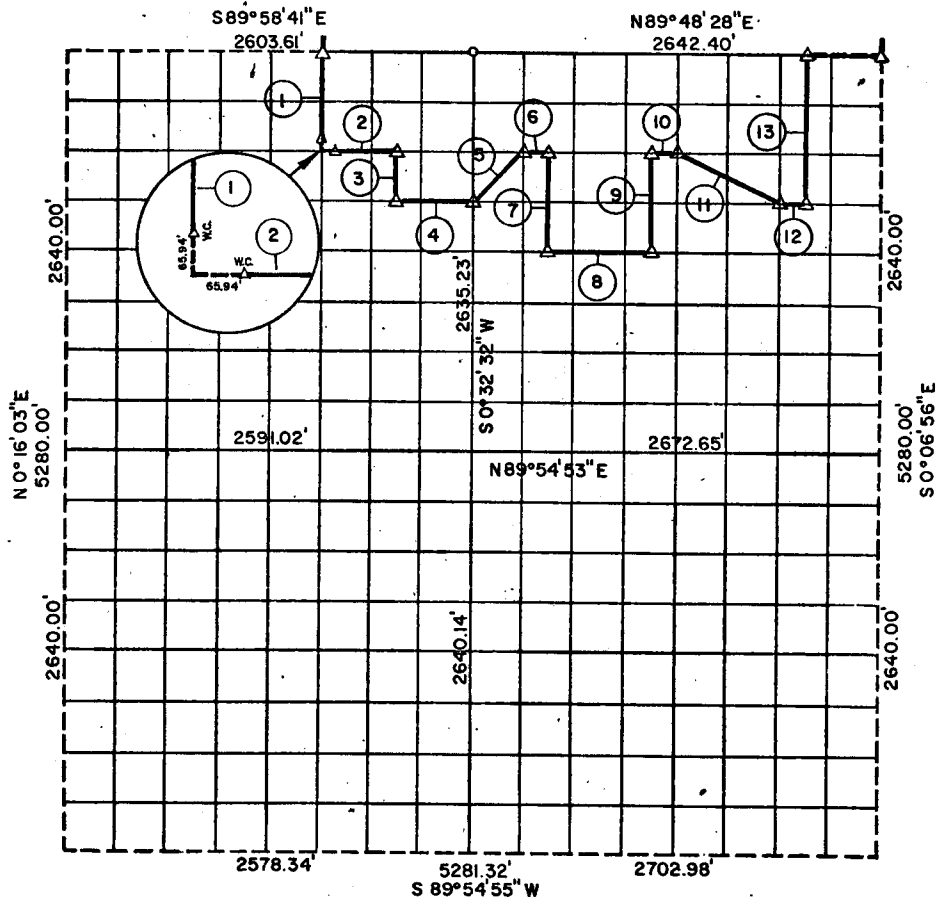

Course No.	Distance	Bearing	Course No.	Distance	Bearing
1	659.26'	S 0° 26' 21" W	13	989.65'	N 0° 00' 28" E
2	487.59'	N 89° 59' 43" E			
3	329.51'	S 0° 29' 27" W			
4	487.29'	N 89° 58' 55" E			
5	470.03'	N 45° 20' 47" E			
6	165.62'	N 89° 50' 04" E			
7	659.02'	S 0° 25' 08" W			
8	664.38'	N 89° 51' 42" E			
9	659.32'	N 0° 15' 16" E			
10	165.62'	N 89° 50' 04" E			
11	738.96'	S 63° 39' 17" E			
12	165.86'	N 89° 50' 52" E			

Field Book No. E 1226

Date: OCTOBER, 1975

PLUMMER-BRUMMETT, INC.
CONSULTING ENGINEERS & SURVEYORS
2504 E. 14th Pl., Tulsa, Okla., 74104, Tel. (918) 939-2251

Under the Supervision of

U.S. ARMY ENGINEER DISTRICT, TULSA
CORPS OF ENGINEERS

LEGEND

- A MONUMENT
- ORIGINAL CORNER
- IRON PIN

CERTIFICATE OF SURVEY

I HEREBY CERTIFY THAT THE ABOVE PLAT IS A TRUE AND CORRECT REPRESENTATION OF THE SURVEY MADE IN SECTION 28, T 12 N, R 15 E, MCINTOSH COUNTY, OKLAHOMA.

E TULA LAKE
 DEEP FORK RIVER
 SECTION AND QUARTER SECTION CORNER
 REFERENCES FOR
 SEC. 28, T12 N, R15 E, MCINTOSH COUNTY

N.W. CORNER

NORTH 1/4 COR.

N.E. CORNER

IN LAKE

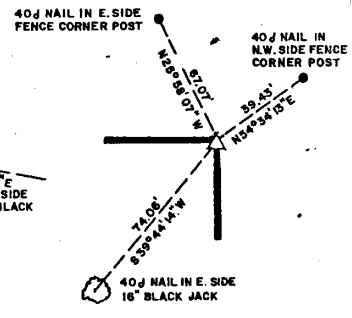
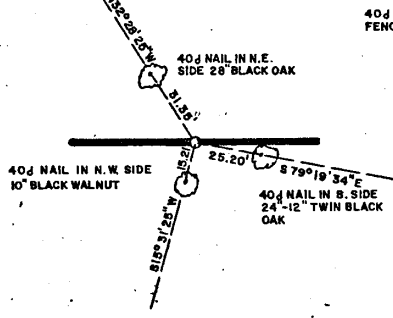

WEST 1/4 COR.

EAST 1/4 COR.

IN LAKE

SCALE: 1" = 50'

IN LAKE

S.W. CORNER

SOUTH 1/4 COR.

S.E. CORNER

IN LAKE

IN LAKE

IN LAKE

- LEGEND**
- A MONUMENT
 - ORIGINAL CORNER
 - IRON PIN

PLUMMER-BRUMMETT, INC.
 CONSULTING ENGINEERS & SURVEYORS
 2504 E. 141st Pl., Tulsa, Okla., 74104, Tel. (918) 939-2251

FIELD BOOK NO. E-1226
 DATE: OCTOBER, 1975

Under the Supervision of
 U.S. ARMY ENGINEER DISTRICT, TULSA