

**PARTIAL BOUNDARY SURVEYS
EUFAULA RESERVOIR**

CANADIAN RIVER, OKLAHOMA

Performed Under Contract Number DACW 56-70-C

SEC. 32 T-12 N R-15 E COUNTY MONTOSH

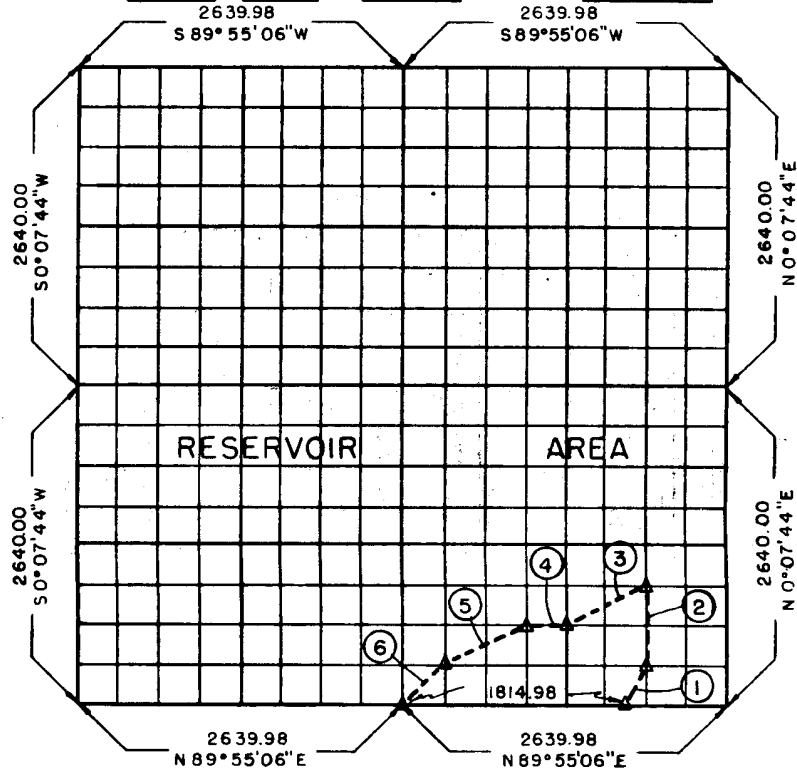

Course No.	Distance	Bearing
1	369.49	N 26° 39' 06" E
2	660.00	N 0° 07' 44" E
3	738.98	S 63° 23' 43" W
4	330.00	S 89° 55' 06" W
5	738.98	S 63° 23' 43" W
6	467.54	S 45° 01' 24" W

Course No.	Distance	Bearing

CERTIFICATE OF SURVEY Field Book No. E-1134 Date 9-15-70

I HEREBY CERTIFY THAT THE ABOVE PLAT IS A TRUE AND CORRECT REPRESENTATION OF THE SURVEY MADE IN SECTION 32, T-12N, R-15E, MONTOSH COUNTY, OKLAHOMA
Edward M. Coon
LICENSED LAND SURVEYOR

PHILLIPS & STONG ENGINEERING CO.
Under the Supervision of
U.S. ARMY ENGINEER DISTRICT, TULSA
CORPS OF ENGINEERS
SHEET 1 of 1

67
LEGEND
▲ MONUMENT
□ ORIGINAL CORNER
○ IRON PIN