

EUFULA RESERVOIR CANADIAN RIVER, OKLAHOMA

PARTIAL BOUNDARY SURVEYS OF SECTION 35, T 12 N., R 15 E., MCINTOSH COUNTY

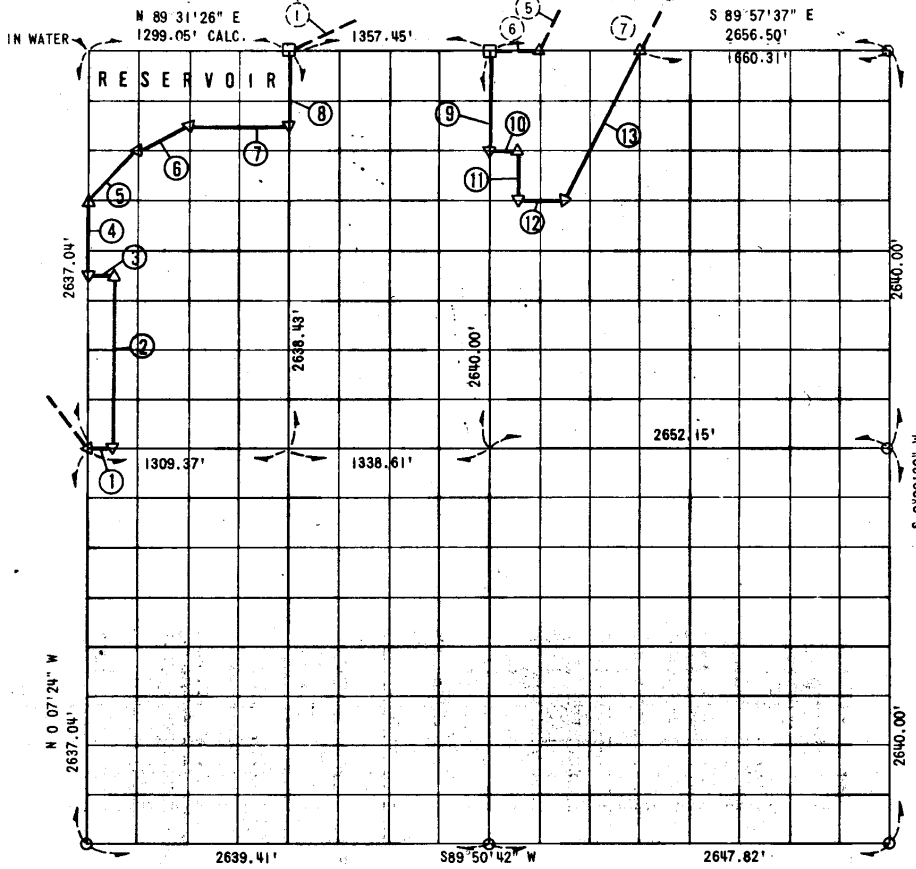

COURSE	DISTANCE	BEARING	COURSE	DISTANCE	BEARING
1	163.67	N 89°35'12" E			
2	1152.78	N 0°09'05" W			
3	163.11	S 89°33'34" W			
4	494.04	N 0°07'24" W			
5	124.55	N 44°20'26" E			
6	365.36	N 62°43'05" E			
7	657.49	N 89°32'09" E			
8	494.74	S 1°09'30" W			
9	660.00	S 0°03'40" W			
10	165.96	S 89°57'37" E			
11	330.00	S 0°01'01" W			
12	331.86	S 89°57'37" E			
13	1108.54	N 26°46'45" E			

FIELD BOOK NO. E 1105

LEGEND
 ▲ C E MONUMENT ● HWY DEPT MON
 □ ORIGINAL STONE ○ IRON PIN

CONTRACT NO. DACW56-70-C-0090
 PERFORMED UNDER SUPERVISION OF
 US ARMY ENGINEER DISTRICT, TULSA
 CORPS OF ENGINEERS

BY
SLADE & ASSOCIATES
CONSULTING ENGINEERS
 5121 CLARK BLVD. SUITE 200
 OKLAHOMA CITY, OKLAHOMA 73106

CERTIFICATE OF SURVEY
 THIS DRAWING CORRECTLY REPRESENTS A SECTION SURVEY
 COMPLETED UNDER MY SUPERVISION SEPTEMBER 1970

James L. Slade
 JAMES L. SLADE
 REGISTERED LAND SURVEYOR
OKLAHOMA NO. 11

69