

EUFAULA RESERVOIR CANADIAN RIVER, OKLAHOMA

PARTIAL BOUNDARY SURVEYS OF SECTION 36, T12 N. R15 E, MCINTOSH COUNTY

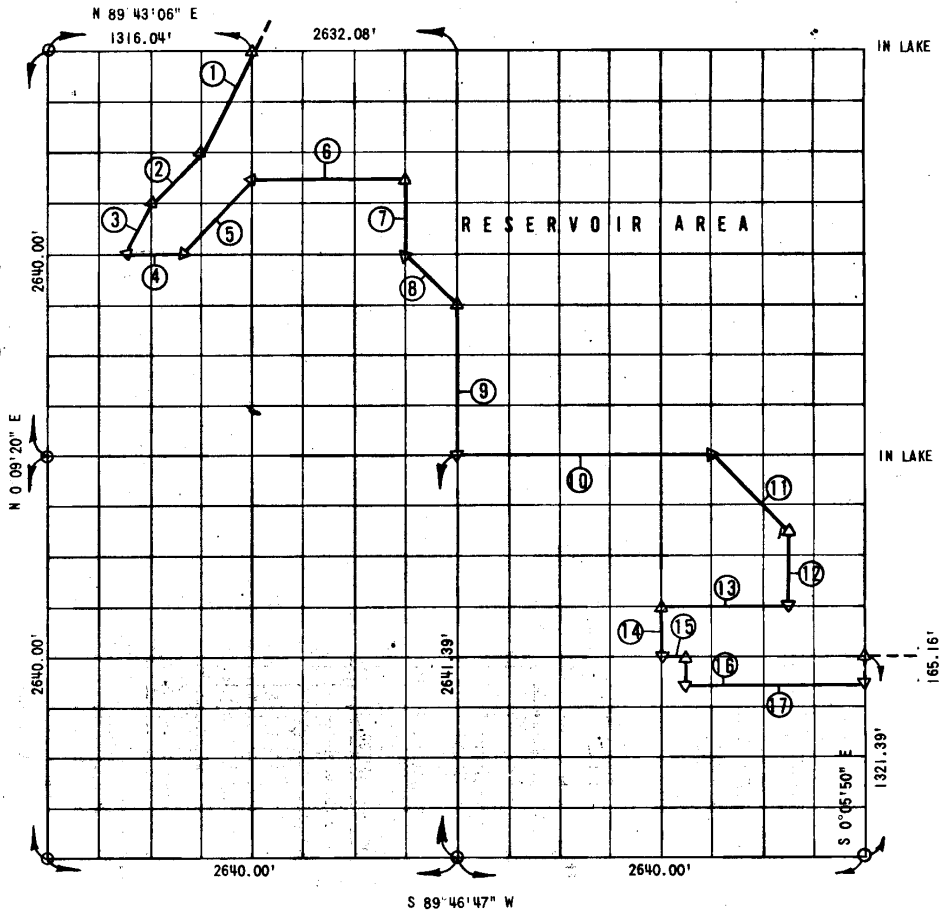

COURSE	DISTANCE	BEARING	COURSE	DISTANCE	BEARING
1	739.62	S 26°32'07" W	10	1647.53	N 89°44'57" E
2	467.79	S 44°50'55" W	11	698.31	S 45°03'19" E
3	369.85	S 26°33'52" W	12	495.47	S 0°00'02" E
4	329.26	N 89°44'01" W	13	824.23	S 89°45'38" W
5	701.65	N 44°51'06" E	14	330.26	S 0°01'35" W
6	987.49	N 89°43'41" E	15	164.88	N 89°45'52" E
7	495.23	S 0°04'49" W	16	165.14	S 0°01'16" W
8	464.92	S 45°01'06" E	17	1152.61	N 89°45'59" E
9	990.52	S 0°04'10" W			

FIELD BOOK NO. E 1106

LEGEND
 ▲ C E MONUMENT ● HWY DEPT MON
 □ ORIGINAL STONE ○ IRON PIN

CONTRACT NO. DACW56-70-C-0090

PERFORMED UNDER SUPERVISION OF
 US ARMY ENGINEER DISTRICT, TULSA
 CORPS OF ENGINEERS

BY
SLADE & ASSOCIATES

CONSULTING ENGINEERS
 3702 CALLETA BLVD., SUITE 100
 OKLAHOMA CITY, OKLAHOMA 73105

CERTIFICATE OF SURVEY

THIS DRAWING CORRECTLY REPRESENTS A SECTION SURVEY
 COMPLETED UNDER MY SUPERVISION SEPTEMBER 1970

James L. Slade
 JAMES L. SLADE
 REGISTERED LAND SURVEYOR

70