

SEC. 1, T 6 N, R 15 E PITTSBURG COUN.

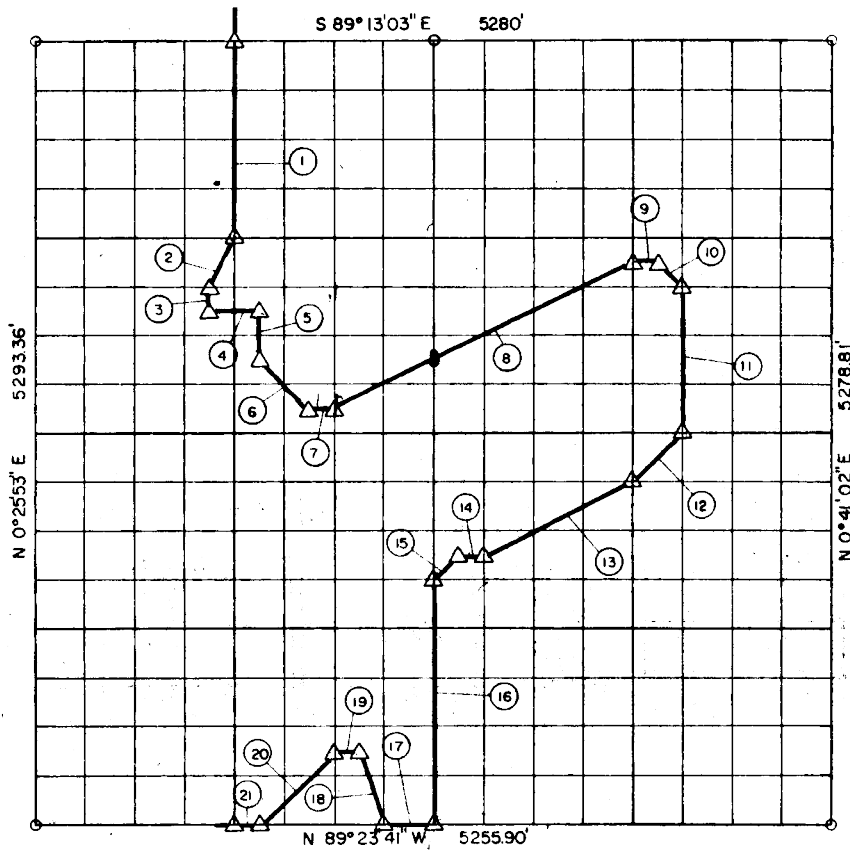

Course No.	Distance	Bearing	Course No.	Distance	Bearing
1	1331.71'	S 0° 29' 46" W	20	697.79'	S 45° 26' 56" W
2	368.40'	S 27° 03' 52" W	21	164.25'	N 89° 23' 41" W
3	164.90'	S 0° 29' 17" W			
4	329.48'	S 89° 23' 30" E			
5	329.80'	S 0° 30' 15" W			
6	466.65'	S 44° 23' 59" E		12,245.34	
7	164.65'	S 89° 23' 32" E			
8	2209.85'	N 64° 00' 45" E			
9	164.79'	S 89° 23' 29" E			
10	233.03'	S 44° 21' 37" E			
11	988.69'	S 0° 38' 20" W			
12	466.08'	S 45° 34' 12" W			
13	1104.24'	S 63° 59' 33" W			
14	164.51'	N 89° 23' 36" W			
15	232.85'	S 45° 31' 00" W			
16	1649.33'	S 0° 33' 41" W			
17	328.49'	N 89° 23' 41" W			
18	521.53'	N 17° 49' 23" W			
19	164.32'	N 89° 23' 39" W			

Book No. E-887

Date: July, 1964

516

I, James E. Curry, a Registered Professional Engineer, do hereby certify that the above plot is a true and accurate survey of Sec. 1, T 6 N, R 15 E as made under my supervision.

12,245.34

James E. Curry
 JAMES E. CURRY
 Reg. Prof. Eng'r. No 1872