

Sec. 23, T 7 N, R 15 E PITTSBURG COUNTY

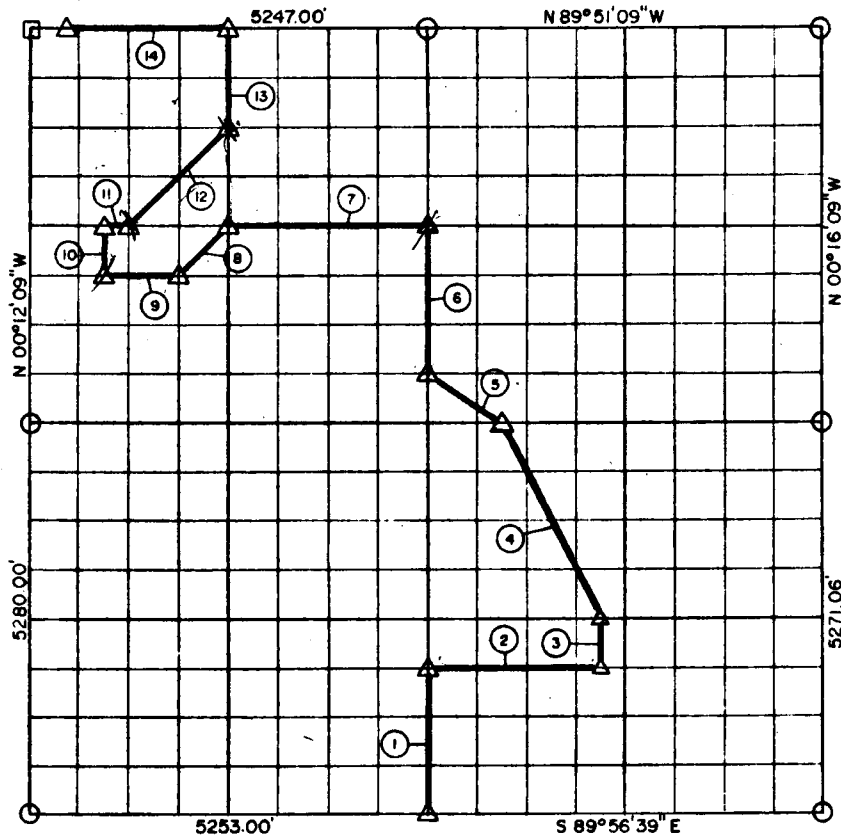

Course No.	Distance	Bearing	Course No.	Distance	Bearing
1	989.16'	N 00° 14' 09" W	12	927.61'	N 44° 47' 33" E
2	1148.85'	S 89° 55' 36" E	13	659.72'	N 00° 13' 09" W
3	329.60'	N 00° 15' 01" W	14	1075.12'	N 89° 51' 09" W
4	1476.60'	N 20° 38' 34" W			
5	594.00'	N 56° 11' 01" W		10,951.84	
6	989.16'	N 00° 14' 09" W			
7	1312.12'	N 89° 52' 31" W			
8	463.85'	S 44° 47' 32" W			
9	492.08'	N 89° 52' 51" W			
10	329.95'	N 00° 12' 32" W			
11	164.02'	S 89° 52' 31" E			

Book No. E-981

Date: February, 1965

482

I, Jack R. Kalman, a Registered Professional Engineer, do hereby certify that the above plat is a true and accurate survey of Sec. 23, T 7 N, R 15 E as made under my supervision.

10,951.84

Jack R. Kalman
 JACK R. KALMAN
 Reg. Prof. Engr. No. 2786