

C. 19, T 7 N, R 16 E PITTSBURG COUN

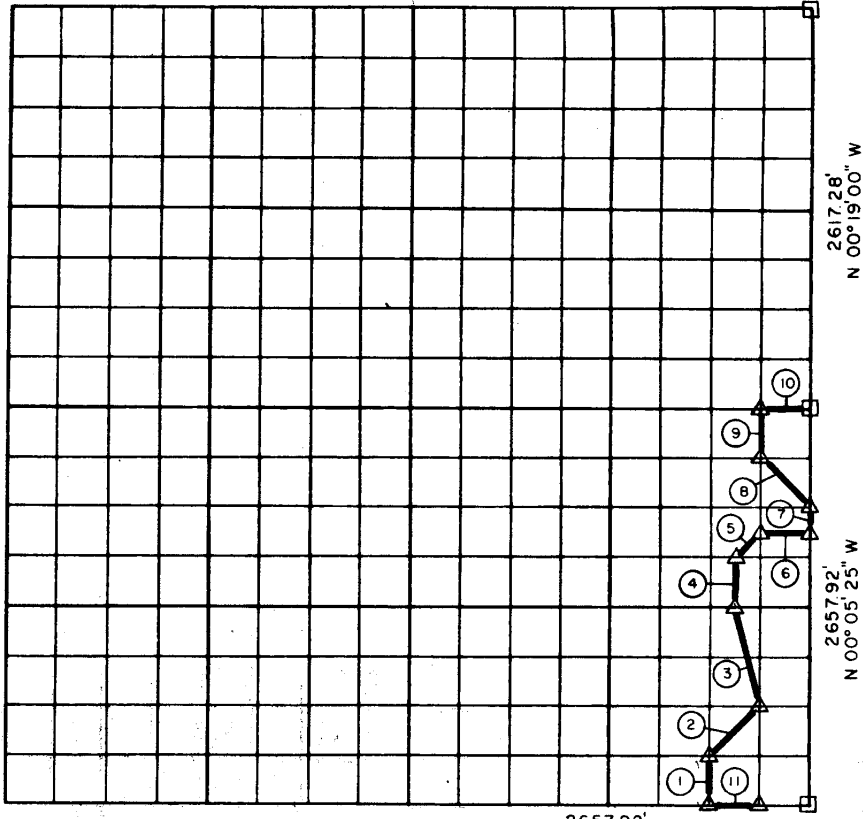

2657.92'
S 89° 20' 35" W

Course No.	Distance	Bearing	Course No.	Distance	Bearing
1	332.24'	N 00° 05' 25" W			
2	472.18'	N 44° 37' 37" E			
3	683.32'	N 14° 09' 05" W			
4	332.24'	N 00° 05' 25" W			
5	236.09'	N 44° 37' 37" E			
6	332.24'	N 89° 20' 35" E			
7	166.12'	N 00° 05' 25" W			
8	467.53'	N 45° 23' 24" W			
9	332.24'	N 00° 05' 25" W			
10	332.24'	N 89° 20' 35" E			
11	332.24'	S 89° 20' 35" W			
	4018.68				

Book No. E-1047 Date: May, 1965

484

I, Jack R. Kalman, a Registered Professional Engineer, do hereby certify that the above plat is a true and accurate survey of Sec. 19, T 7 N, R 16 E as made under my supervision.

Jack R. Kalman
JACK R. KALMAN
 Reg. Prof. Engr. No. 2786