

PARTIAL SURVEY SURVEYS  
 AREA "D"

EUFULA RESERVOIR  
 CANADIAN RIVER, OKLAHOMA

Performed Under Contract Number DACW 56-70-C-0085

SECTION 26, T-8-N R-16-E PITTSBURG COUNTY

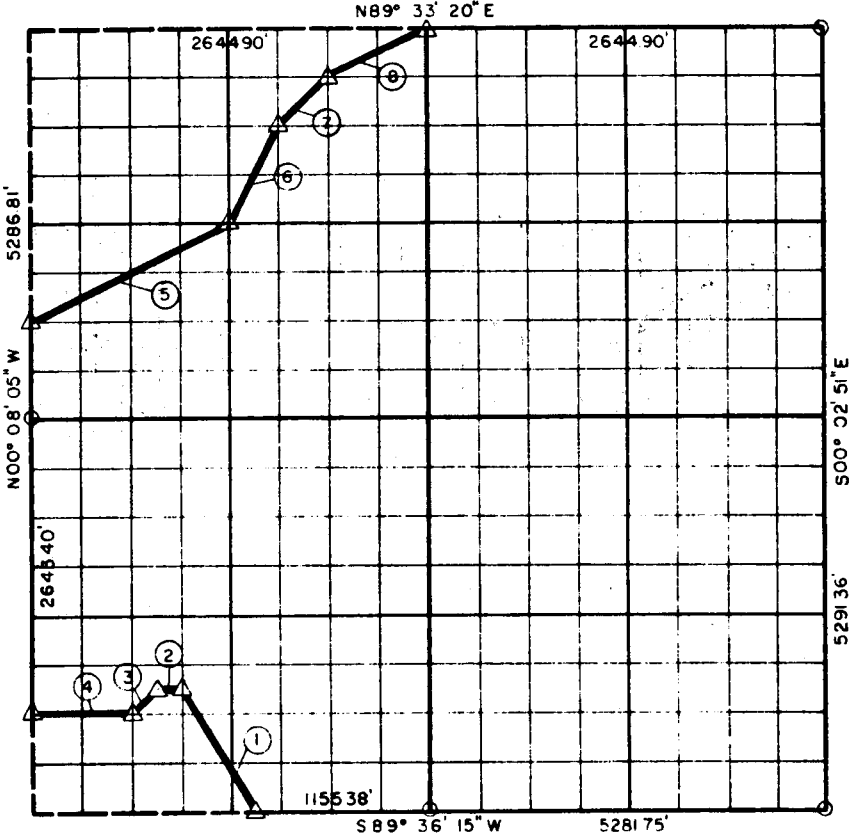

Course No.	Distance	Bearing	Course No.	Distance	Bearing
①	961.16'	N 31° 07' 37\" W			
②	165.09'	S 89° 35' 47\" W			
③	234.14'	S 44° 42' 46\" W			
④	660.34'	S 89° 35' 53\" W			
⑤	1480.99'	N 63° 04' 00\" E			
⑥	740.71'	N 26° 23' 25\" E			
⑦	468.83'	N 44° 43' 53\" E			
⑧	741.00'	N 63° 03' 53\" E			

Book No. E-1099 Date: November, 1970

- △ Monument
- Original Corner
- Iron Pin

444

I, Lee D. Johnson, a Registered Land Surveyor, do hereby certify that the above plat is a true and accurate survey of Section 26, T-8-N, R-16-E as made under my supervision.

*Lee D. Johnson*  
 LEE D. JOHNSON  
 Reg. Land Surveyor L.S. 738