

EUFAULA RESERVOIR CANADIAN RIVER, OKLAHOMA

PARTIAL BOUNDARY SURVEYS OF SECTION 2, T 9 N. R 16 E. MCINTOSH COUNTY

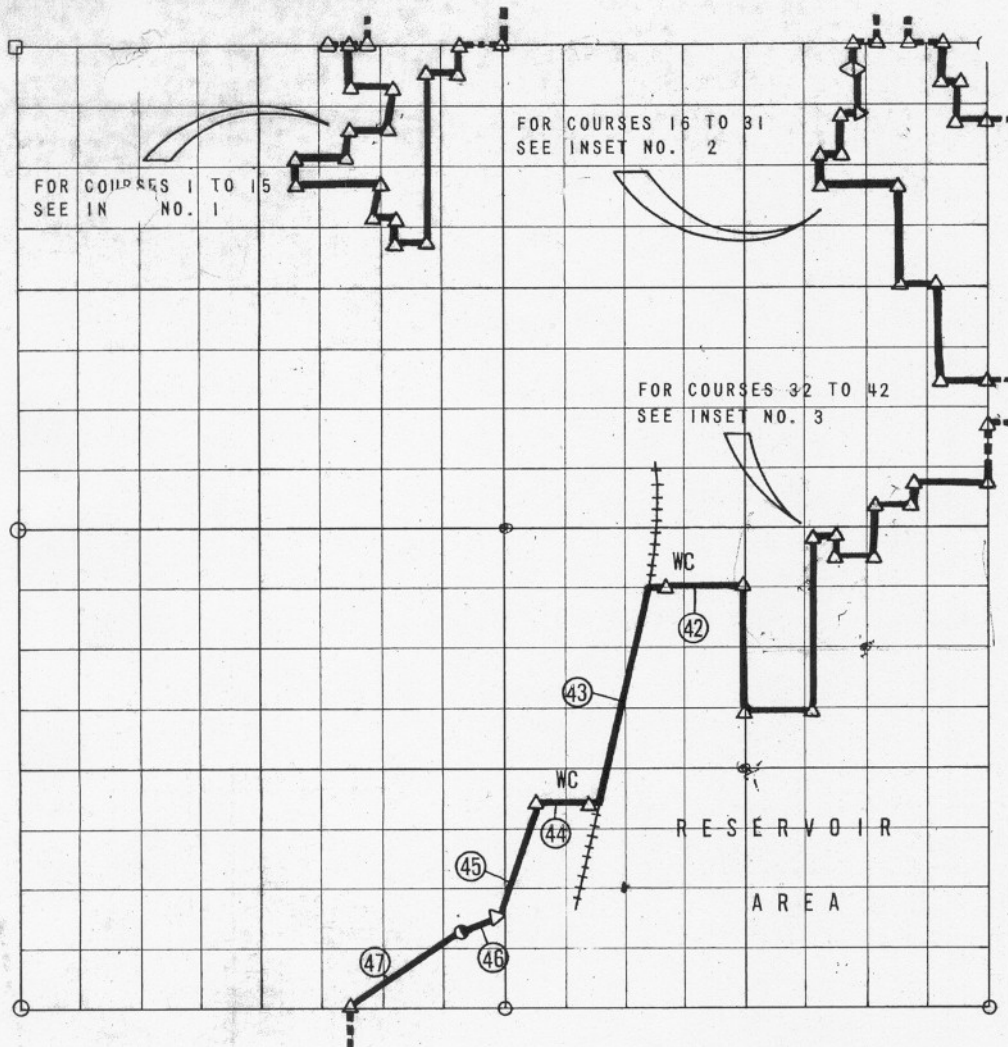

COURSE	DISTANCE	BEARING	COURSE	DISTANCE	BEARING
SEE SUPPLEMENTAL INSETS 1, 2 & 3 FOR COURSES 1-42					
			43	1167.14	S 10°33'37" W
			44	388.37	N 89°45'58" W
			45	845.58	S 19°08'38" W
			46	246.33	S 88°23'44" W
			47	614.98	S 54°45'09" W

SURVEY BOOK NO. E 1111

- 258
- LEGEND**
- △ C E MONUMENT ● HWY DEPT MON
 - ORIGINAL STONE ○ IRON PIN

CONTRACT NO. DACW56-70-C-0090
 PERFORMED UNDER SUPERVISION OF
 US ARMY ENGINEER DISTRICT, TULSA
 CORPS OF ENGINEERS
 BY

CERTIFICATE OF SURVEY
 THIS DRAWING CORRECTLY REPRESENTS A SECTION SURVEY
 COMPLETED UNDER MY SUPERVISION SEPTEMBER 1970

INSET NO
TO ACCOM. SURVEY PLOT OF
SECTION 2, 9N, R16E, MCINTOSH
COUNTY, EUFAULA RESERVOIR

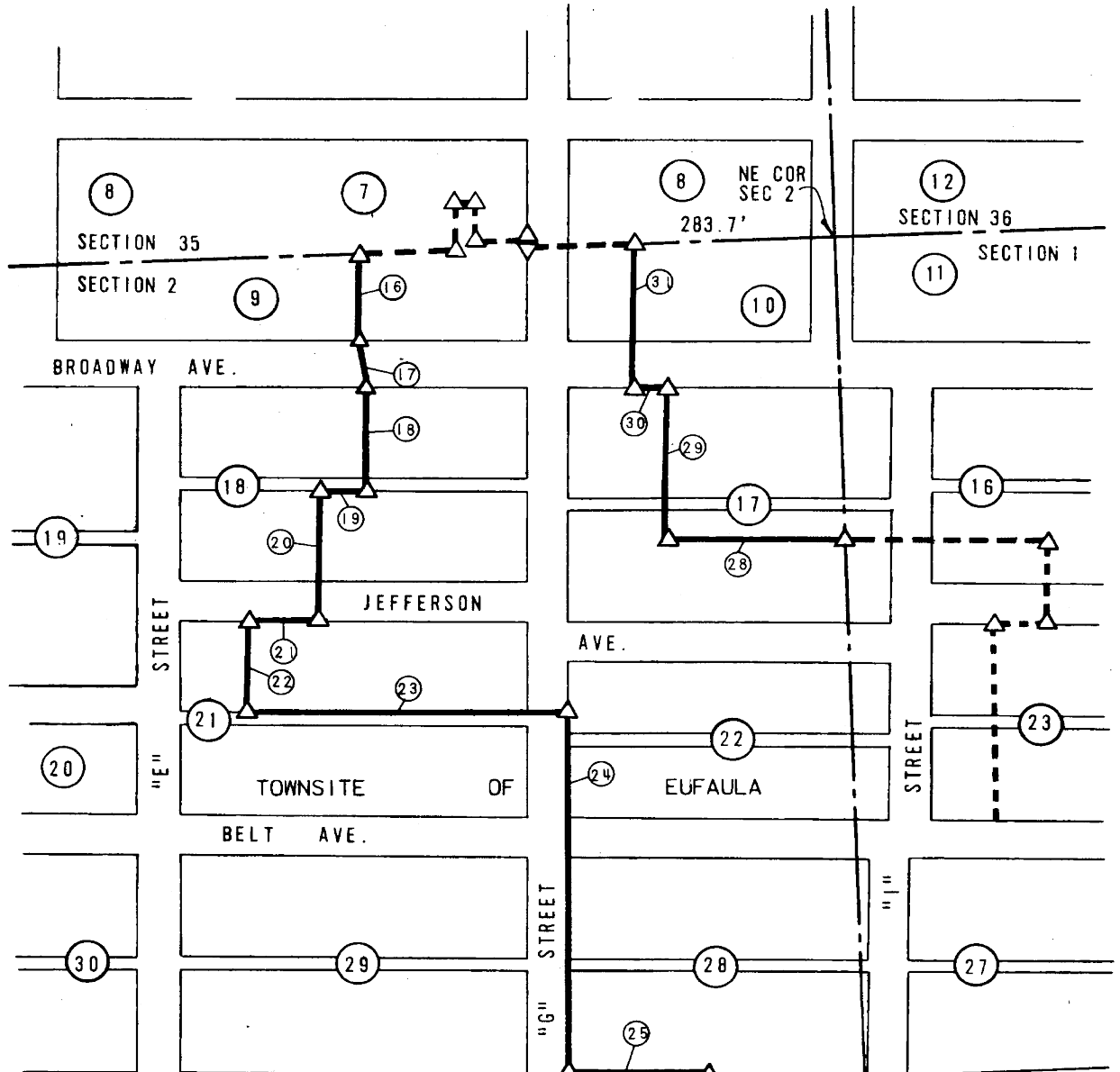

CSE.	DIST.	BRG.
16	123.30	S 2°32'57" W
17	70.62	S 4°46'21" E
18	161.90	S 2°32'57" W
19	70.00	N 87°09'33" W
20	200.00	S 1°57'34" W
21	100.00	N 87°42'40" W
22	140.00	S 1°57'34" W
23	466.83	S 87°42'40" E
24	556.04	S 2°27'50" W
25	200.00	S 86°26'25" W
26	500.43	S 2°21'40" W
27	253.06	S 85°59'54" E
28	255.33	N 87°32'10" W
29	240.00	N 2°27'50" E
30	44.00	N 87°32'20" W
31	210.56	N 2°27'50" E

MCKINLEY AVENUE

JACKSON AVENUE

SECTION 2 SECTION 1

WITNESS 8' E OF COR.

1" = 200'

James L. Sladf

258

INSET NO. 3
 TO ACCOMPANY SURVEY PLOT OF
 SECTION 2, T9N, R16E, MCINTOSH
 COUNTY EUFAULA RESERVOIR

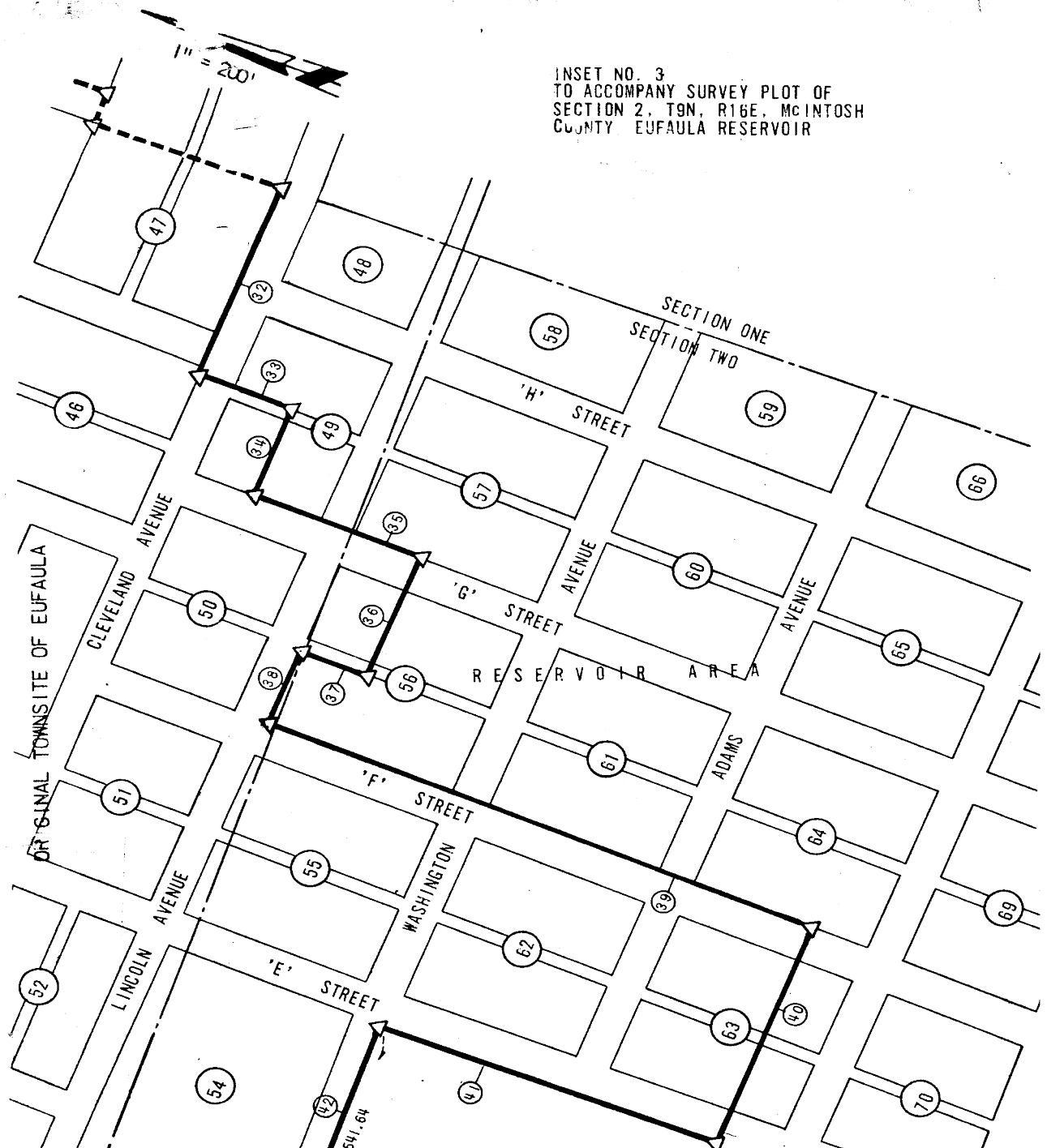

CSE.	DIST.	BRG.
32	350.20	N 87°49'59" W
33	160.00	S 2°17'15" W
34	160.00	N 87°49'59" W
35	290.00	S 2°17'15" W
36	220.00	N 87°09'50" W
37	110.00	N 2°19'10" E
38	170.00	N 87°09'50" W
39	940.78	S 2°19'10" W
40	400.10	N 87°18'57" W
41	580.02	N 0°35'15" E
42	541.64	N 89°45'58" W

WITNESS CORNER
 SET ON RR R/W
 18.13
 82.38
 541.64
 FEE LINE FOLLOWS RR R/W.
 SURVEY WAS ON TANG. EXTENDED

SURVEY BOOK E.1111
 SEPTEMBER 4, 1970
 JAMES L. SLADE, PE & LS

James L. Slade

258