

C. 18 , T 9 N,

3,414.40'
McINTOSH COUN

N 89° 44' 08" E
2644.97'

S 89° 51' 42" E
2642.49'

RITE

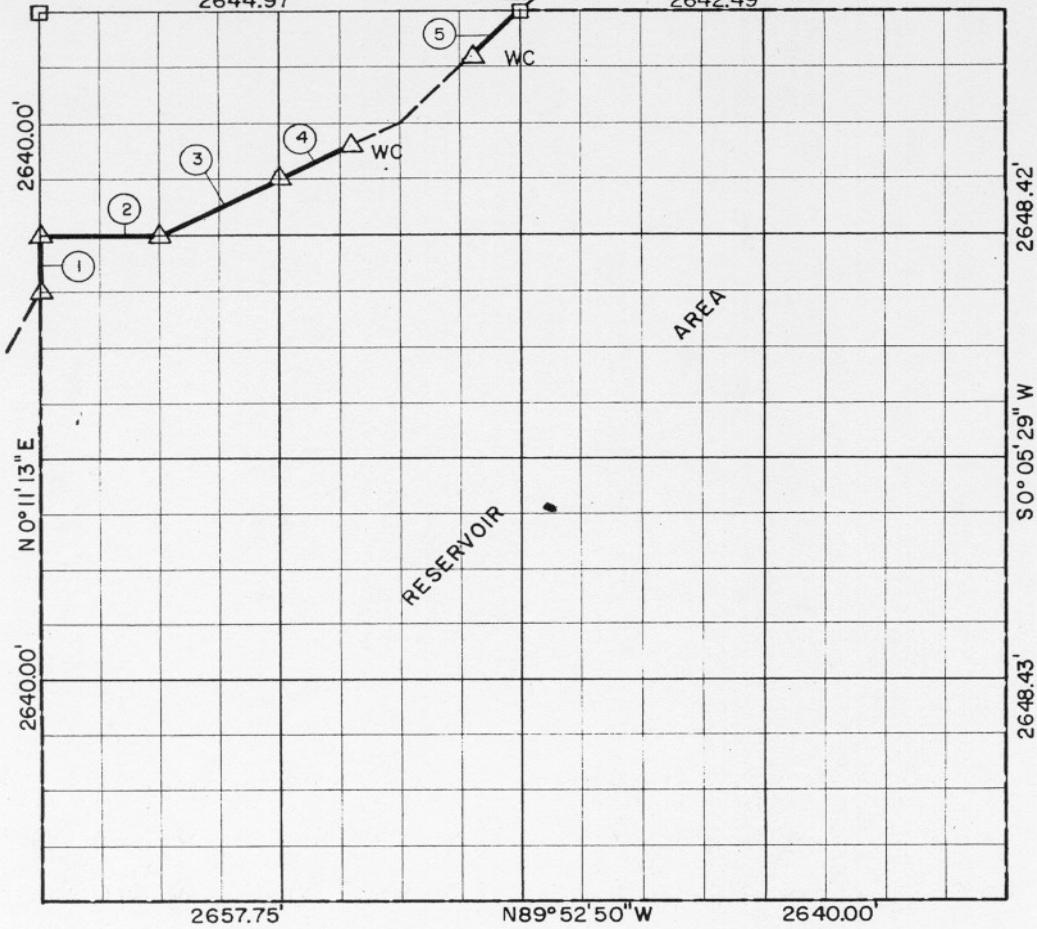

Course No.	Distance	Bearing	Course No.	Distance	Bearing
1	330.00'	N 0° 11' 14" E			
2	667.22'	N 89° 52' 54" E			
3	739.16'	N 63° 17' 34" E			
4	740.02'	N 63° 15' 08" E			
5	938.00'	N 44° 48' 51" E			

3414.40

Book No. E-1016

Date: August, 1965

296

I, James E. Curry, a Registered Professional Engineer, do hereby certify that the above plat is a true and accurate survey of Sec. 18 , T 9 N, R 17 E as made under my supervision.

LEGEND

- 5/8" Rods w/Caps
- △ C. of E. Mon.
- Measured Line
- - - - - Calculated Line

James E. Curry
JAMES E. CURRY
Reg. Prof. Eng'r. No. 1872