

R. 17 E
+2'45" E
5280.00

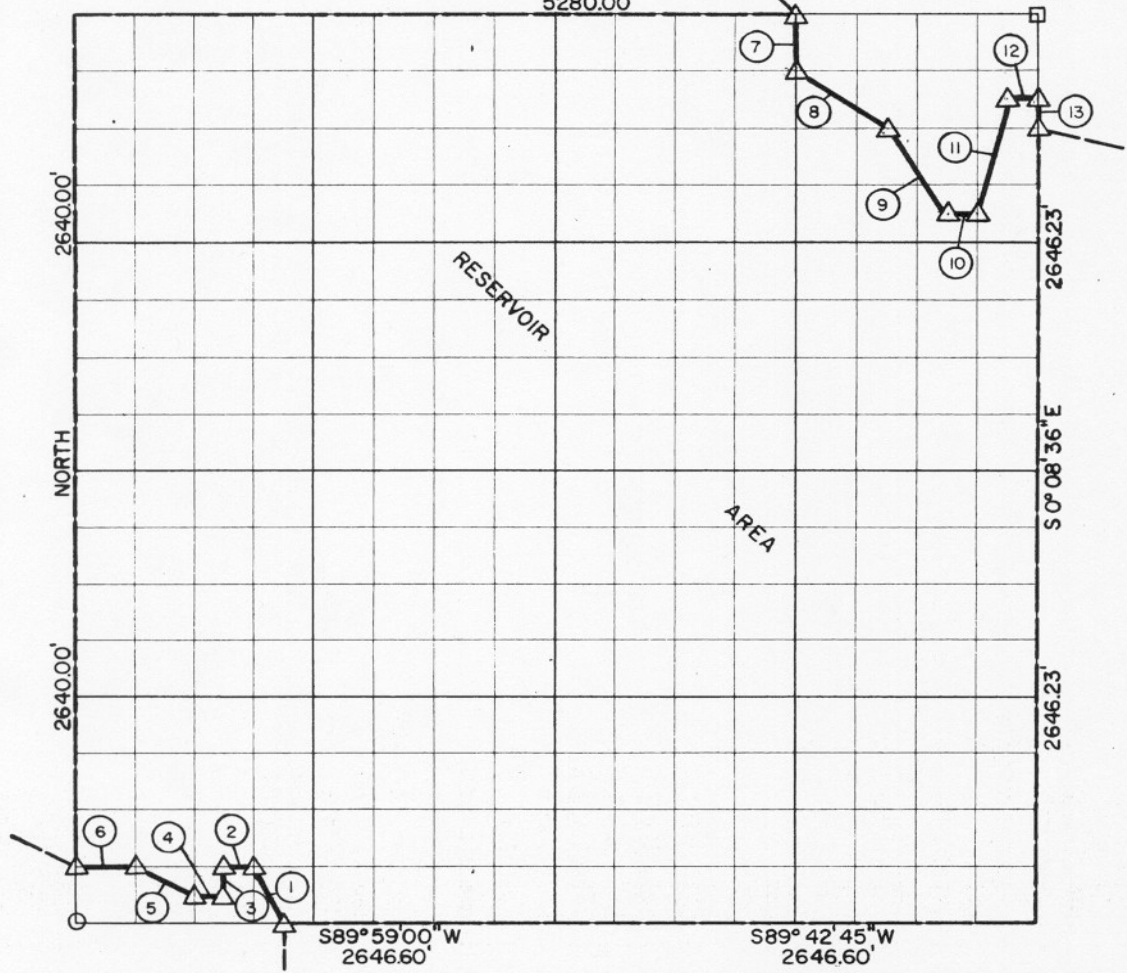

Course No.	Distance	Bearing	Course No.	Distance	Bearing
1	369.29'	N 26° 38' 09" W			
2	165.39'	S 89° 57' 20" W			
3	165.11'	S 0° 01' 20" E			
4	165.40'	S 89° 58' 14" W			
5	369.64'	N 63° 30' 28" W			
6	330.78'	S 89° 57' 20" W			
7	330.58'	S 0° 06' 28" E			
8	594.58'	S 56° 29' 30" E			
9	595.17'	S 33° 48' 54" E			
10	165.09'	N 89° 44' 32" E			
11	682.13'	N 13° 52' 02" E			
12	165.04'	N 89° 43' 31" E			
13	165.39'	S 0° 08' 36" E			

4263.59

Book No. E-1013

Date: August, 1965

261

I, James E. Curry, a Registered Professional Engineer, do hereby certify that the above plat is a true and accurate survey of Sec. 5, T9N, R17E as made under my supervision.

LEGEND

- 5/8" Rods w/Caps
- △ C. of E. Mon.
- Measured Line
- - - - - Calculated Line

James E. Curry
 JAMES E. CURRY
 Reg. Prof. Eng'r. No. 1872