

~~1878.50'~~

R17E

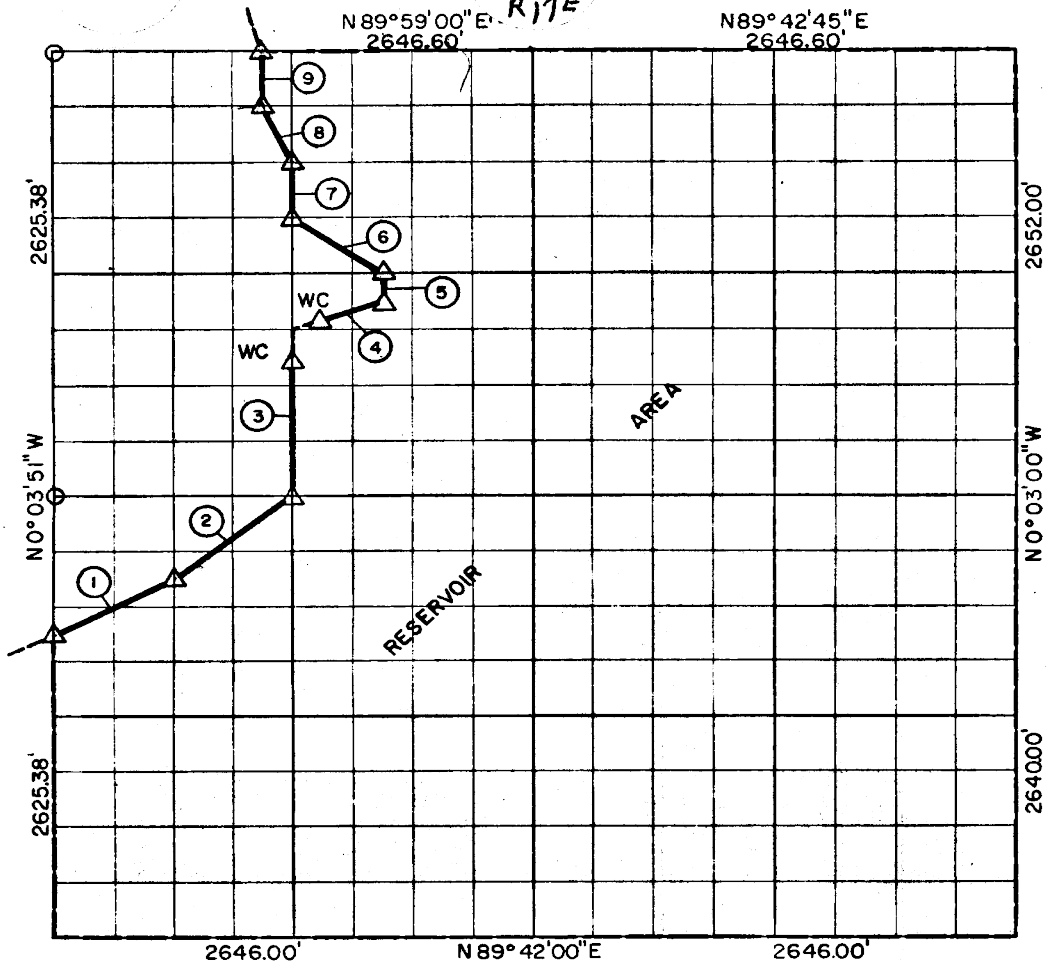

Course No.	Distance	Bearing	Course No.	Distance	Bearing
1	737.28'	N 63° 44' 29" E			
2	823.43'	N 53° 23' 53" E			
3	985.89'	N 0° 03' 30" W			
4	522.34'	N 71° 41' 14" E			
5	164.40'	N 0° 03' 32" W			
6	595.76'	N 56° 27' 36" W			
7	328.63'	N 0° 03' 38" W			
8	368.08'	N 26° 45' 53" W			
9	328.58'	N 0° 03' 40" W			

4,854.39

Book No. E-1015

Date August, 1965

277

I, James E. Curry, a Registered Professional Engineer, do hereby certify that the above plat is a true and accurate survey of Sec. 8, T9N, R17E as made under my supervision.

**LEGEND**

- 5/8" Rods w/Caps
- △ C. of E. Mon.
- Measured Line
- - - Calculated Line
- Orig. Cor. Stone

*James E. Curry*  
 JAMES E. CURRY  
 Reg. Prof. Eng'r. No. 1872