

SEC. 3, T 9 N, R 18 E, HASKELL COUNTY

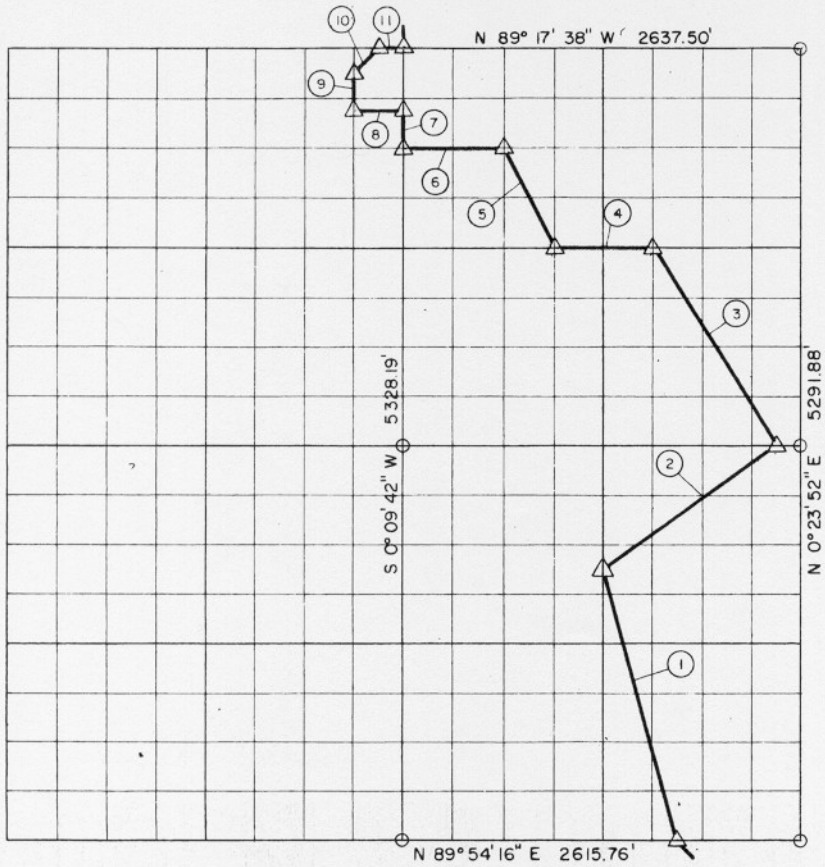

Course No.	Distance	Bearing	Course No.	Distance	Bearing
1	1878.15'	N 14° 51' 26" W			
2	1415.39'	N 54° 33' 17" E			
3	1553.45'	N 31° 35' 05" W			
4	657.97'	N 89° 36' 09" W			
5	752.21'	N 25° 42' 50" W			
6	658.67'	N 89° 26' 56" W			
7	258.10'	N 0° 09' 42" E			
8	307.00'	N 89° 17' 38" W			
9	179.10'	N 0° 09' 42" E			
10	280.25'	N 31° 47' 51" E			
11	160.00'	S 89° 17' 38" E			
	8100.29				

Book No. E-884

Date: July, 1964

Sheet 268

I, James E. Curry, a Registered Professional Engineer, do hereby certify that the above plat is a true and accurate survey of Sec. 3, T 9 N, R 18 E as made under my supervision.

8099

James E. Curry
 JAMES E. CURRY
 Reg Prof Eng'r No 1872