

# PARTIAL BOUNDARY SURVEYS

FORT GIBSON LAKE  
GRAND RIVER, OKLAHOMA

Performed Under Contract Number DACW56-71-C-0108

SEC 1 T-18-N R-18-E COUNTY WAGONER

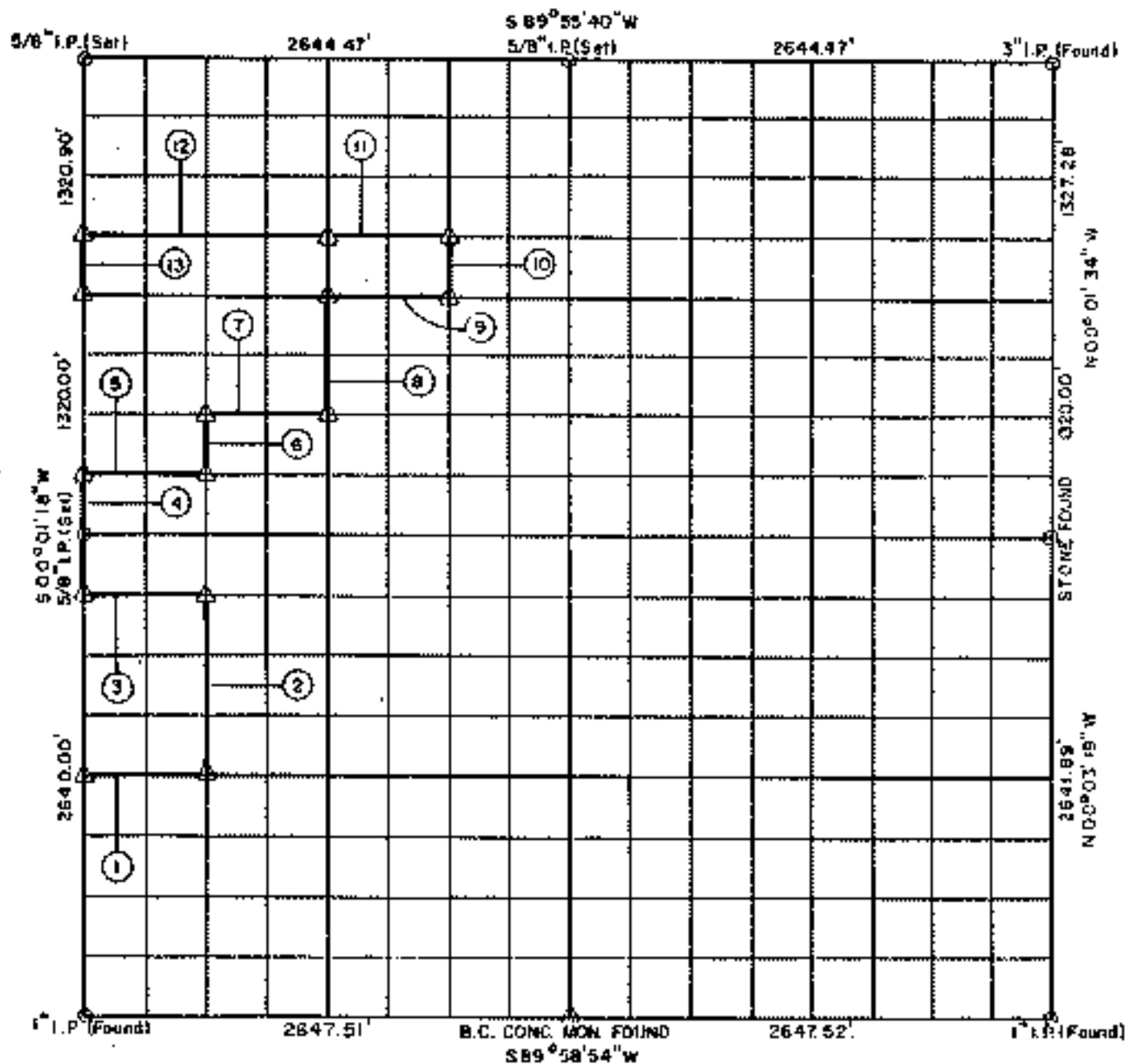

Course No.	Distance	Bearing	Course No.	Distance	Bearing
1	561.68'	S 89° 59' 32" E			
2	990.16'	N 00° 00' 48" E			
3	661.53'	WEST			
4	660.00'	N 00° 01' 18" E			
5	661.45'	N 89° 59' 49" E			
6	330.00'	N 00° 00' 48" E			
7	661.40'	N 89° 59' 49" E			
8	660.00'	N 00° 00' 18" E			
9	661.31'	N 89° 59' 49" E			
10	330.82'	N 00° 00' 12" W			
11	661.26'	S 89° 58' 46" W			
12	1322.52'	S 89° 58' 46" W			
13	330.22'	S 00° 01' 18" W			

Field Book No. 5-1815 Date: MARCH, 1971

**SURVEY**

THAT THE  
TRUE AND  
LOCATION OF  
IN SECTION  
E, WAGONER  
A.



**H. SCHMIDT CORPORATION**  
Under the Supervision of  
**ENGINEER DISTRICT, TULSA**  
**CORPS OF ENGINEERS**  
SHEET 1 of 1

**LEGEND**

- ▲ MONUMENT
- ORIGINAL CORNER
- IRON PIN
- \* COMPUTED DISTANCE

*E. Kenney*  
LAND SURVEYOR