

RECORD BOUNDARY PLAT

LAKE FORT GIBSON, OKLAHOMA

SEC 20 T 18N R 19E COUNTY WAGONER

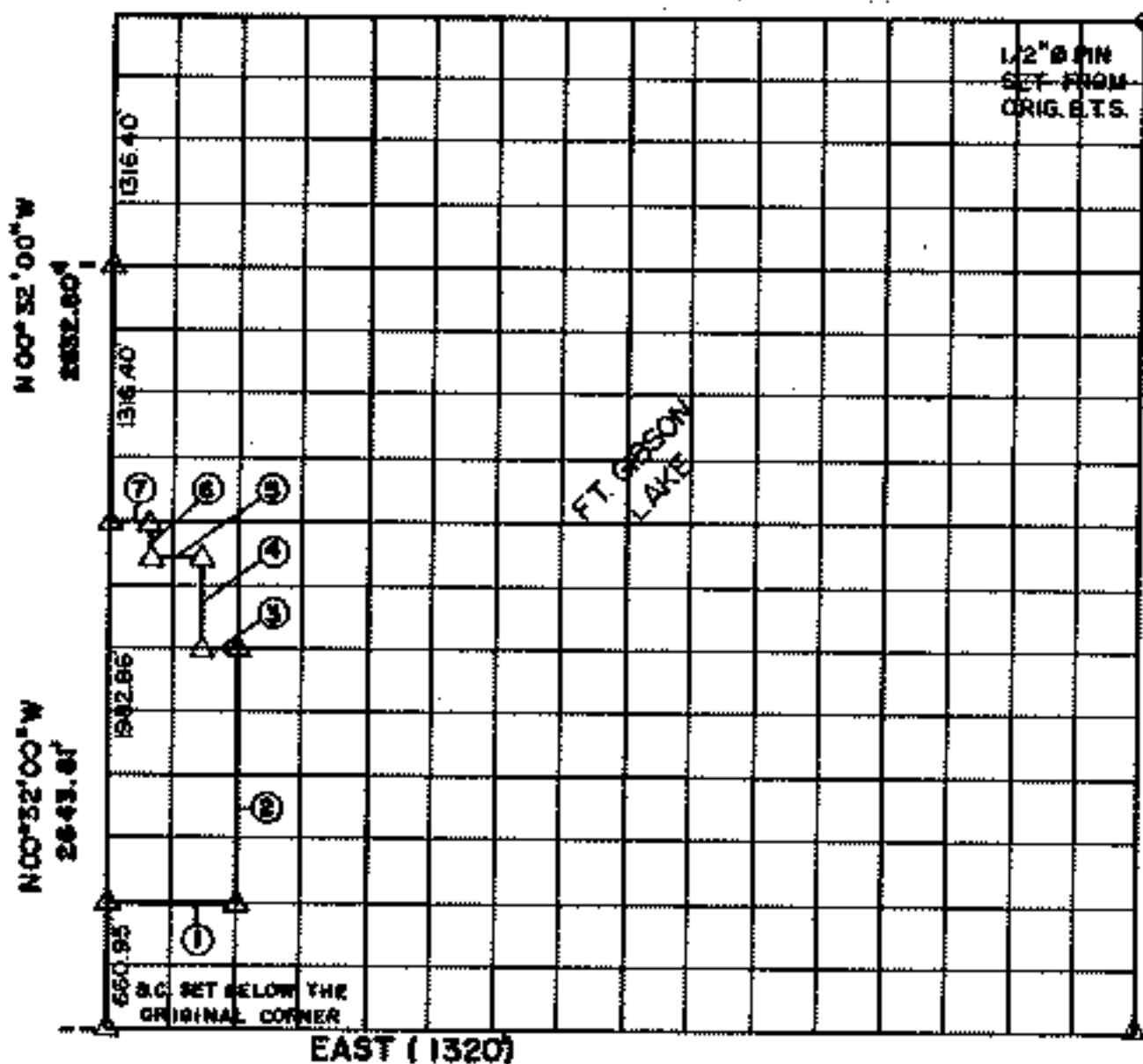

Course No.	Distance	Bearing	Course No.	Distance	Bearing
1	660.00	EAST			
2	1321.90	N 00° 32' 00" W			
3	165.00	WEST			
4	450.95	N 00° 32' 00" W			
5	285.00	WEST			
6	210.00	N 00° 32' 00" W			
7	210.00	N 89° 47' 49" W			

NOTE: MONUMENTS IN FIELD ARE DESCRIBE BY SECTIONAL SUBDIVISION NOT COURSES AS DEPICTED BY THIS PLAT. ALL BEARINGS ARE UNIQUE & ASSUMED FOR THIS SECTION

SEPT., 1984 Field Book No. 5-1171 Date JULY, 1949

SURVEY PERFORMED BY THE
CORPS OF ENGINEERS, TULSA DISTRICT
PLATS PREPARED BY
ENTZ ENGINEERING & ASSOCIATES INC. AND
HUFFMAN SURVEYING CO., INC.

LEGEND
 * MONUMENT
 O ORIGINAL CORNER
 □ MON. PIN

**PARTIAL BOUNDARY SURVEYS
FT GIBSON LAKE
OKLAHOMA**

Performed Under Contract Number DACW 56-85-C-0127

SW/4 SEC. 20, T. 18 N., R. 19 E., COUNTY WAGONER

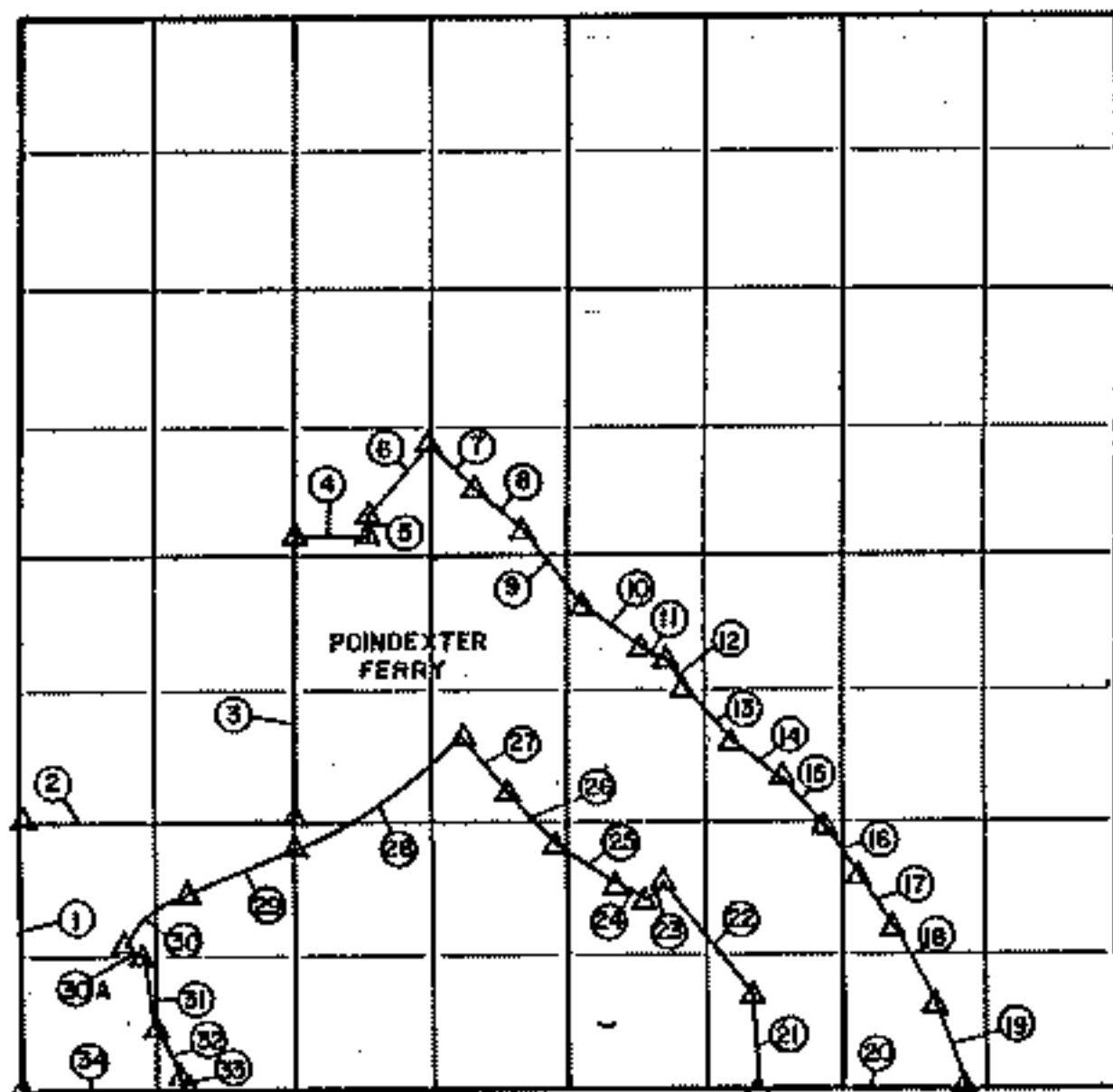

Course No.	Distance	Bearing	Course No.	Distance	Bearing
1	661.15'	N 00° 21' W	14	155.00'	S 37° 31' E
2	639.47'	S 89° 51' E	15	152.00'	S 39° 49' E
3	700.00'	N 00° 22' W	16	147.72'	S 35° 05' E
4	75.00'	S 89° 50' E	17	150.00'	S 35° 21' E
5	46.60'	N 08° 29' W	18	148.80'	S 32° 06' E
6	218.50'	N 40° 59' E	19	293.66'	S 21° 42' E
7	144.00'	S 44° 45' E	20	513.54'	N 89° 50' W
8	149.00'	S 48° 08' E	21	224.32'	N 04° 12' W
9	245.84'	S 38° 46' E	22	368.68'	N 38° 01' W
10	191.12'	S 54° 45' E	23	148.15'	S 51° 59' W
11	60.53'	S 68° 39' E	24	170.40'	S 62° 33' E
12	87.30'	S 37° 43' E	25	158.35'	S 56° 48' E
13	172.20'	S 40° 20' E	26	180.00'	S 38° 01' E

Field Book No. 5-2006 Date 8-21-85

SCOTT & ASSOCIATES, INC.
Engineering & Surveying
For

U.S. ARMY ENGINEER DISTRICT, TULSA
CORPS OF ENGINEERS
SHEET 1 of 2

Δ MONUMENT
○ ORIGINAL CORNER
○ IRON PIN
MYI AR 2



PARTIAL BOUNDARY SURVEYS
 FT GIBSON LAKE
 OKLAHOMA

Performed Under Contract Number DACW 56-85-C-0127

SW/4 SEC. 20, T. 18N, R. 19E, COUNTY WAGONER

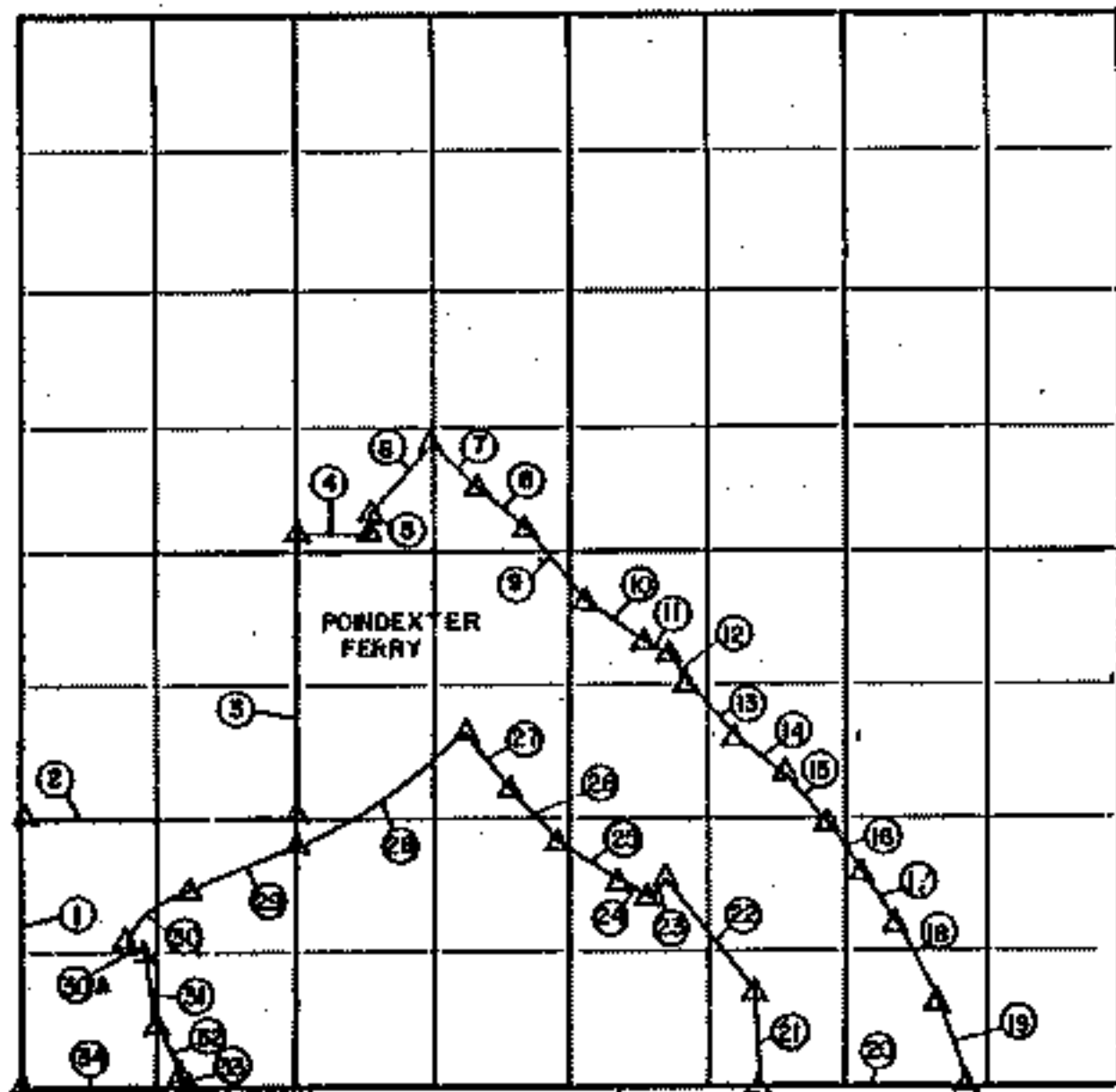

Course No.	Distance	Bearing	Course No.	Distance	Bearing
27	176.75	S 88°25' E			
28	488.86'	R. = 597.95'			
29	276.41'	N 70°27' E			
30	200.51'	R = 356.97'			
30-A	44.00'	N 51°56' W			
31	165.50'	N 09°00' W			
32	186.40'	N 23°59' W			
33	25.00'	S 00°10' W			
34	565.00'	S 88°50' E			

Field Book No. 5-2006 Date 8-21-85

SCOTT & ASSOCIATES, INC.
 Engineering & Surveying

For
 U.S. ARMY ENGINEER DISTRICT, TILSA
 CORPS OF ENGINEERS

▲ MONUMENT
 □ ORIGINAL CORNER
 ○ IRON PIN

