

PARTIAL BOUNDARY SURVEYS

Performed Under Contract Number DACW 56-70-C-0157

SEC. 23 T-18-N R-19-E COUNTY WAGONER

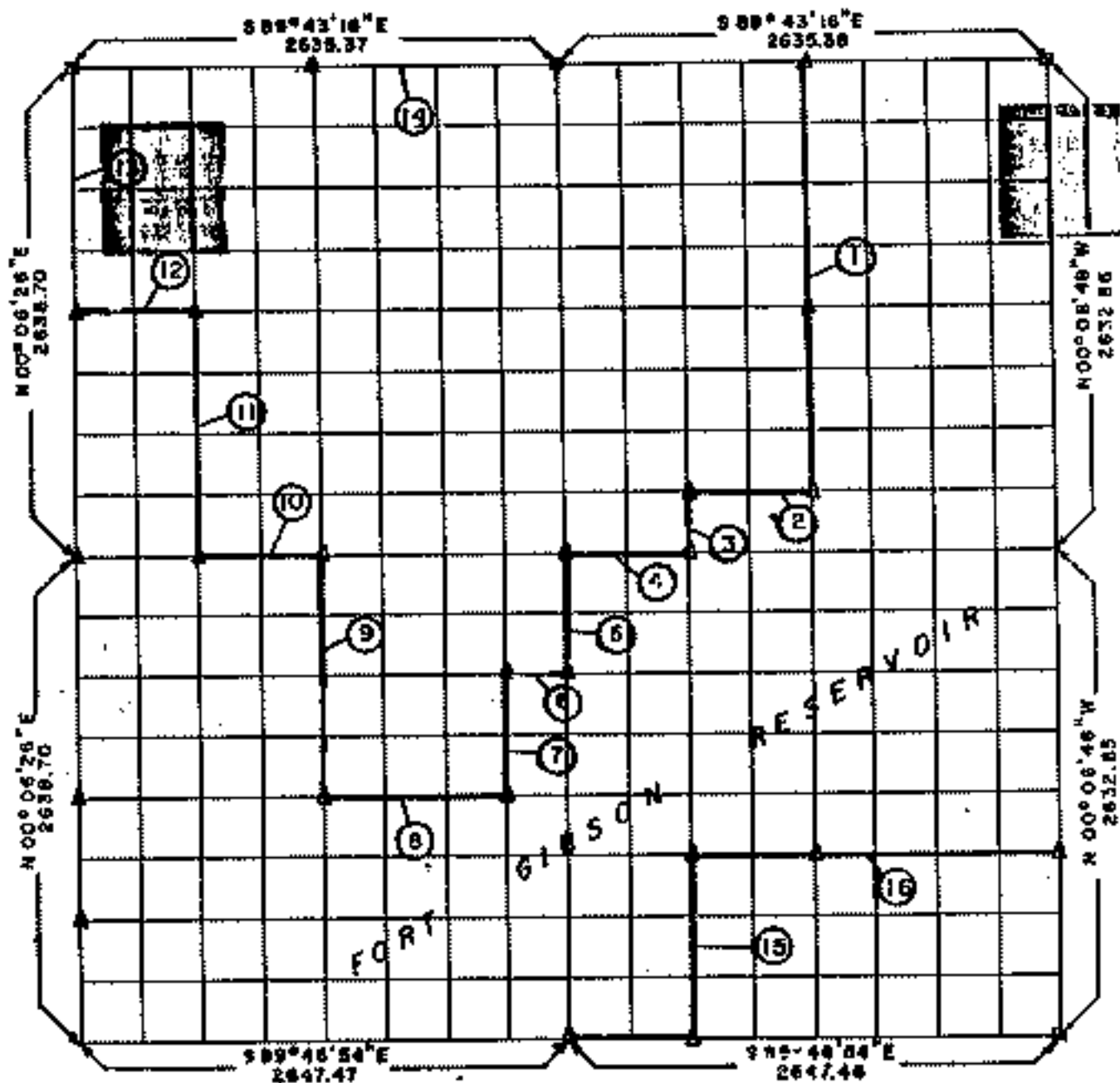

Course No.	Distance	Bearing	Course No.	Distance	Bearing
1	2305.03	S 00° 03' 30\"E	14	3953.06	S 89° 43' 16\"E
2	660.18	N 89° 44' 51\"W	15	988.14	N 00° 01' 50\"W
3	329.38	S 00° 01' 50\"E	16	1983.90	S 89° 46' 12\"E
4	660.35	N 89° 45' 05\"W			
5	658.94	S 00° 00' 11\"E			
6	930.37	N 89° 45' 23\"W			
7	659.03	S 00° 00' 38\"W			
8	991.67	N 89° 46' 00\"W			
9	518.61	N 00° 03' 08\"E			
10	660.35	N 89° 45' 00\"W			
11	1318.98	N 00° 04' 47\"E			
12	659.60	N 89° 44' 10\"W			
13	1320.00	N 00° 06' 26\"E			

Field Book No. B-1808 Date NOVEMBER 1970

CERTIFICATE OF SURVEY
 I HEREBY CERTIFY THAT THE ABOVE PLAT IS A TRUE AND CORRECT REPRESENTATION OF THE SURVEY MADE IN SECTION 23, T-18-N, R-19-E, WAGONER COUNTY, OKLAHOMA.

F.M. NEWELL COMPANY - ENGINEERS
 Under the Supervision of
U.S. ARMY ENGINEER DISTRICT, TULSA
CORPS OF ENGINEERS

LEGEND
 Δ MONUMENT
 □ ORIGINAL CORNER
 ○ IRON PIN