

**PARTIAL BOUNDARY SURVEYS  
FORT GIBSON RESERVOIR  
GRAND RIVER, OKLAHOMA**

Performed Under Contract Number DACW56-70-C

**SEC. 36 T-18-N R-19-E COUNTY WAGONER & CHEROKEE**

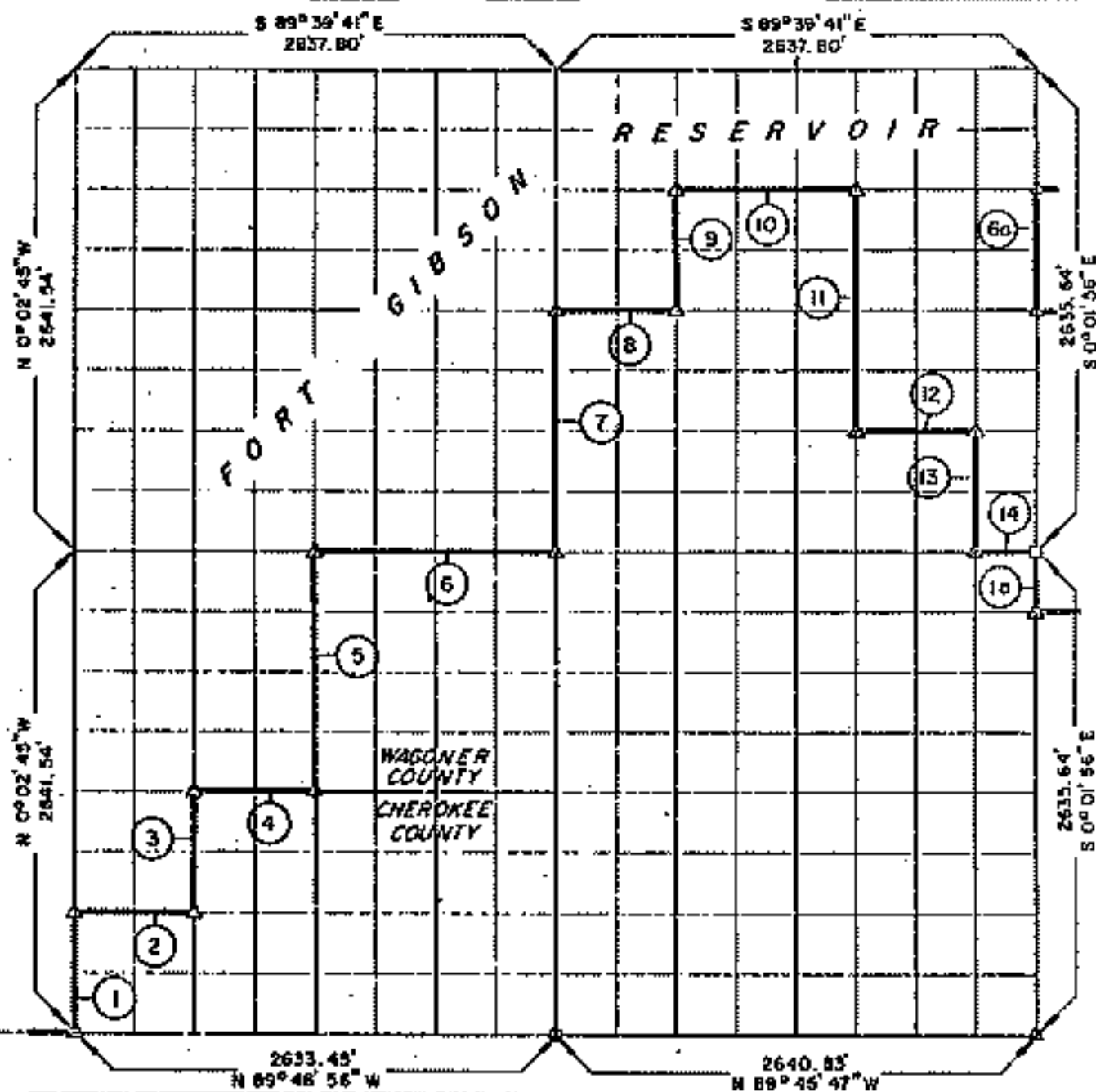

Course No.	Distance	Bearing	Course No.	Distance	Bearing
1	660.38	N 0° 02' 45" W	14	329.91	S 89° 43' 32" E
2	658.50	S 89° 47' 35" E	1a	329.45	S 0° 01' 56" E
3	660.12	N 0° 02' 03" W	6a	658.91	N 0° 01' 56" W
4	658.63	S 89° 46' 14" E	* See Sec. 31, T-18-N, R-20-E Plot		
5	1319.72	N 0° 01' 21" W			
6	1317.82	S 89° 43' 32" E			
7	1319.29	N 0° 00' 03" E			
8	659.65	S 89° 41' 36" E			
9	659.46	N 0° 00' 27" W			
10	989.33	S 89° 40' 38" E			
11	1318.37	S 0° 01' 11" E			
12	659.74	S 89° 42' 34" E			
13	659.00	S 0° 01' 41" E			

Field Book No. 5-1803 Date 7-10-70

**CERTIFICATE OF SURVEY**

I hereby certify that the above plot is a true and correct representation of the survey made in Section 36, T-18-N, R-19-E, Wagoner & Cherokee Counties, Oklahoma.

**K. W. COX & ASSOCIATES - ENGINEERS**

Under the Supervision of

**ARMY ENGINEER DISTRICT, LSA  
CORPS OF ENGINEERS**

**LEGEND**

- A MONUMENT
- D ORIGINAL CORNER
- G IRON PIN