

PARTIAL BOUNDARY SURVEYS

OOLOGAH RESERVOIR
VERDIGRIS RIVER, OKLAHOMA

Performed Under Contract Number DACW 56-70-C-0065

SEC 27 T-23 - N R-16 - E COUNTY ROGERS

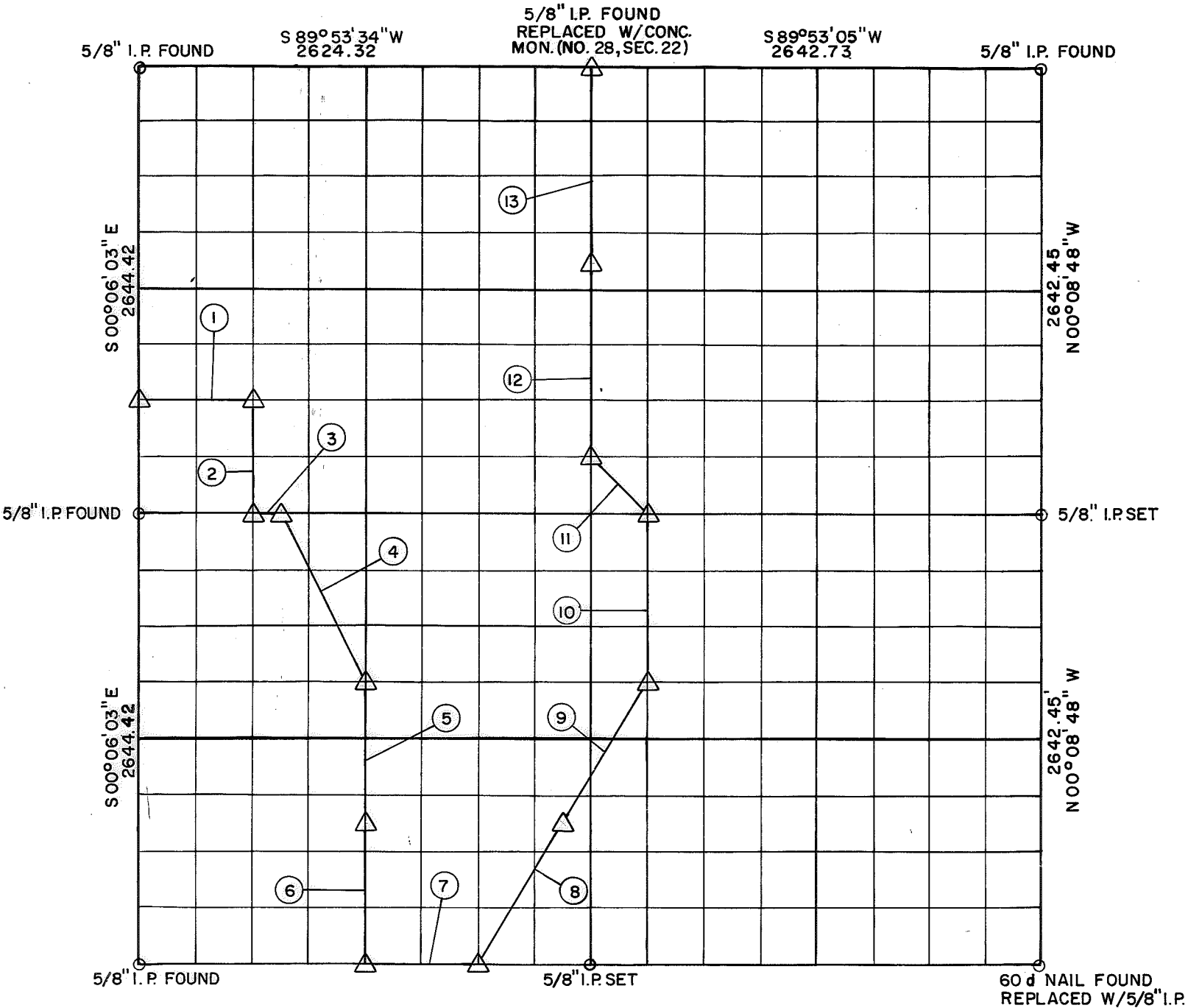

Course No.	Distance	Bearing	Course No.	Distance	Bearing
1	657.22'	N 89° 52' 12" E			
2	661.09'	S 00° 07' 48" E			
3	164.40'	N 89° 51' 39" E			
4	1107.58'	S 26° 36' 12" E			
5	826.26'	S 00° 09' 44" E			
6	826.26'	S 00° 09' 44" E			
7	659.08'	N 89° 49' 59" E			
8	962.23'	N 30° 41' 34" E			
9	962.23'	N 30° 41' 34" E			
10	991.18'	N 00° 12' 50" W			
11	467.21'	N 45° 08' 54" W			
12	1156.46'	N 00° 13' 25" W			
13	1156.46'	N 00° 13' 25" W			

CERTIFICATE OF SURVEY Field Book No. 0-219 Date: May, 1970

I HEREBY CERTIFY THAT THE ABOVE PLAT IS A TRUE AND CORRECT REPRESENTATION OF THE SURVEY MADE IN SECTION 27, T 23 N, R 16 E, ROGERS COUNTY, OKLAHOMA.

E. H. Schmidt
REGISTERED PROFESSIONAL ENGINEER

E.H. SCHMIDT & ASSOC., INC.

Under the Supervision of
U.S. ARMY ENGINEER DISTRICT, TULSA
CORPS OF ENGINEERS
SHEET 1 of 1

- LEGEND
- Δ MONUMENT
 - ORIGINAL CORNER
 - IRON PIN
 - * COMPUTED DISTANCE