

SEC. 3 -T 23 N-R 16 E , ROGERS COUNTY, OKLAHOMA

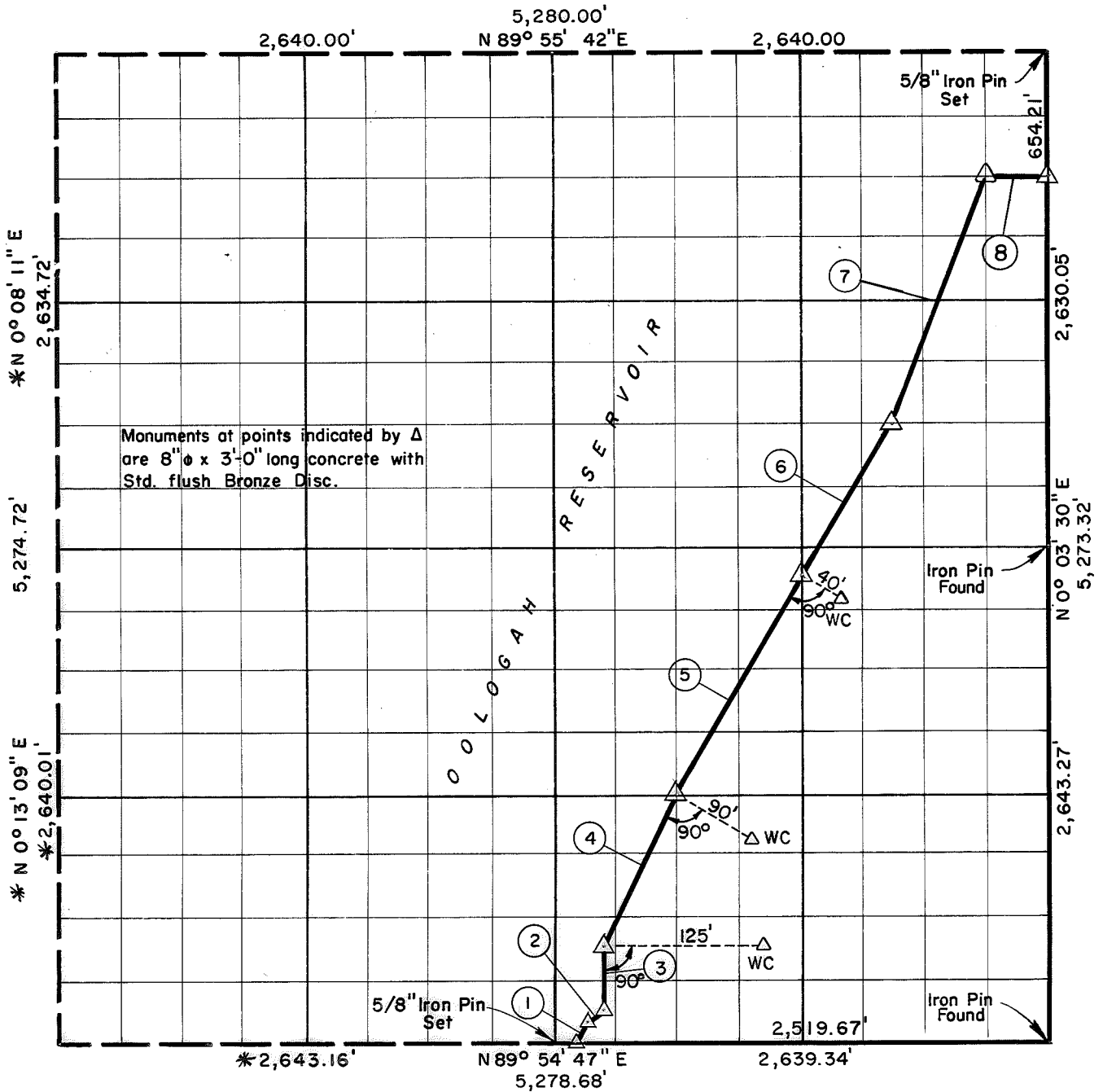

Course No.	Distance	Bearing	Course No.	Distance	Bearing
1	116.74'	N 30° 58' 44" E			
2	106.41'	N 52° 10' 49" E			
3	330.23'	N 0° 03' 07" E			
4	916.68'	N 25° 39' 31" E			
5	1,332.76'	N 29° 43' 57" E			
6	964.07'	N 30° 56' 43" E			
7	1,406.75'	N 20° 39' 27" E			
8	329.99'	N 89° 53' 38" E			

Book No. O-191 Date: April 1965 * Revised: 3-24-76

I, Charles R. Keithline, a Registered Professional Engineer in the State of Oklahoma, do hereby certify that the above plat is a true and accurate survey of Sec. 3 - T23N-R 16E, as made under my supervision.

CRAIG AND KEITHLINE
Consulting Engineers

Charles R. Keithline
CHARLES R. KEITHLINE
Reg. Prof. Engr. No. 2834 (Okla.)