

# PARTIAL BOUNDARY SURVEYS

## VERDIGRIS RIVER, OKLAHOMA

SEC. 11 T 25 N R 16 E COUNTY NOWATA

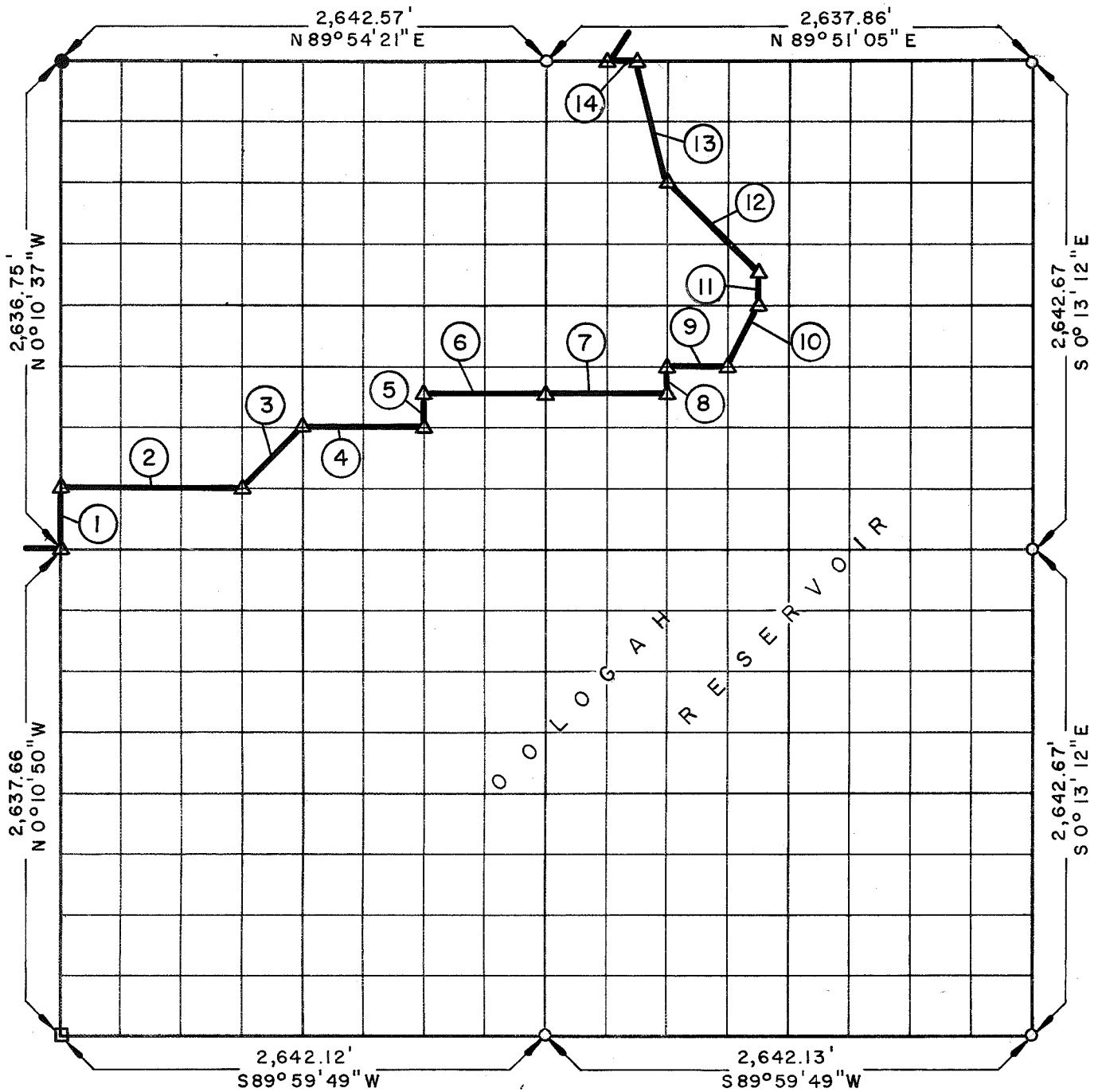

Course No.	Distance	Bearing	Course No.	Distance	Bearing
1	329.59	N 0° 10' 37" W	14	164.87	S 89° 51' 05" W
2	990.91	N 89° 56' 17" E			
3	466.23	N 44° 56' 02" E			
4	660.63	N 89° 56' 00" E			
5	164.88	N 0° 10' 29" W			
6	660.63	N 89° 55' 52" E			
7	659.83	N 89° 54' 51" E			
8	164.97	N 0° 11' 07" W			
9	329.90	N 89° 54' 30" E			
10	368.69	N 26° 23' 01" E			
11	165.02	N 0° 11' 39" W			
12	700.28	N 45° 08' 26" W			
13	680.27	N 14° 12' 39" W			

Field Book No. 0-249, Date 7-19-71

### CERTIFICATE OF SURVEY

I HEREBY CERTIFY THAT THE ABOVE PLAT IS A TRUE AND CORRECT REPRESENTATION OF THE SURVEY MADE IN SECTION 11, T 25 N, R 16 E, NOWATA COUNTY, OKLAHOMA

*Jack C. Cox*  
REGISTERED LAND SURVEYOR

**K.N. COX & ASSOCIATES - ENGINEERS**

Under the Supervision of

**U.S. ARMY ENGINEER DISTRICT, TULSA  
CORPS OF ENGINEERS**

SHEET 1 of 1

### LEGEND

- ▲ MONUMENT
- ORIGINAL CORNER
- IRON PIN
- IRON PIPE