

PARTIAL BOUNDARY SURVEYS  
 ROBERT S. KERR LOCK AND DAM 15  
 ARKANSAS RIVER, OKLAHOMA

Performed Under Contract Number DA-34-066-Civeng 66-214

SEC 34 T-10-N R-22-E COUNTY HASKELL

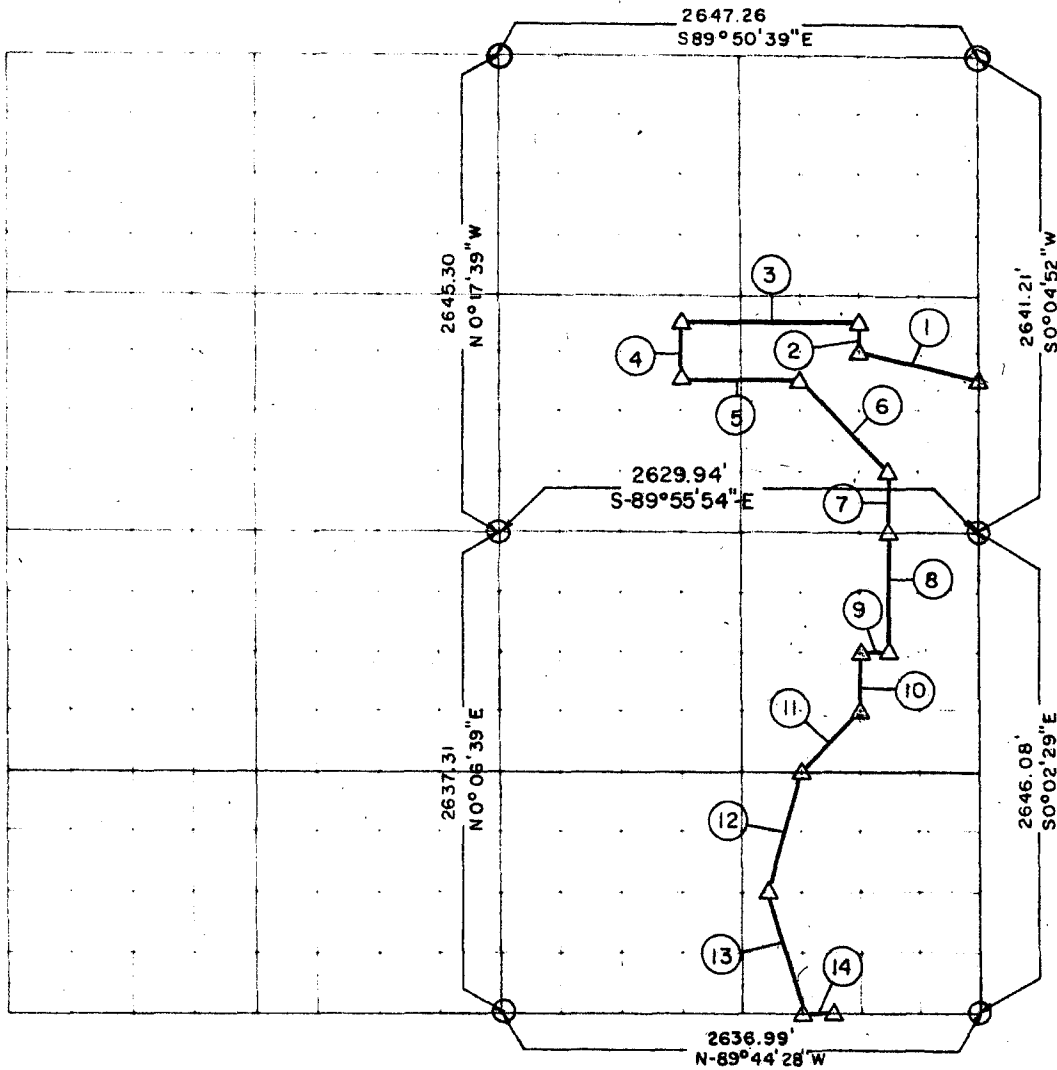

Course No	Distance	Bearing	Course No	Distance	Bearing
1	679.52	N75°50'21\"W	14	164.81	S89°44'28\"E
2	165.14	N0°00'47\"W			
3	989.07	N89°53'34\"W			
4	330.47	S0°09'13\"E			
5	658.84	S89°54'12\"E			
6	700.21	S44°52'30\"E			
7	330.24	S0°00'37\"W			
8	661.11	S0°00'47\"W			
9	164.48	N89°53'06\"W			
10	330.48	S0°00'13\"E			
11	465.78	S44°57'59\"W			
12	680.36	S14°01'28\"W			
13	681.47	S13°58'14\"E		7,001.98 ✓	

Field Book No. A-2411 Date: 3-31-66

STATEMENT OF SURVEY

WE HEREBY CERTIFY THAT THE  
 ABOVE PLAT IS A TRUE AND  
 CORRECT REPRESENTATION OF  
 THE SURVEY MADE IN SECTION  
34, T-10-N, R-22-E,  
 COUNTY, OKLAHOMA

BREISCH ENGINEERING COMPANY

Under the Supervision of

U.S. ARMY ENGINEER DISTRICT, TULSA  
 CORPS OF ENGINEERS

LEGEND

- △ MONUMENT
- ORIGINAL CORNER
- IRON PIN