

**PARTIAL BOUNDARY SURVEYS
ROBERT S. KERR LOCK & DAM 15
ARKANSAS RIVER, OKLAHOMA**

Performed Under Contract Number DACW 56-68-C-0101

SEC 22 T 11 N R 21 E COUNTY HASKELL

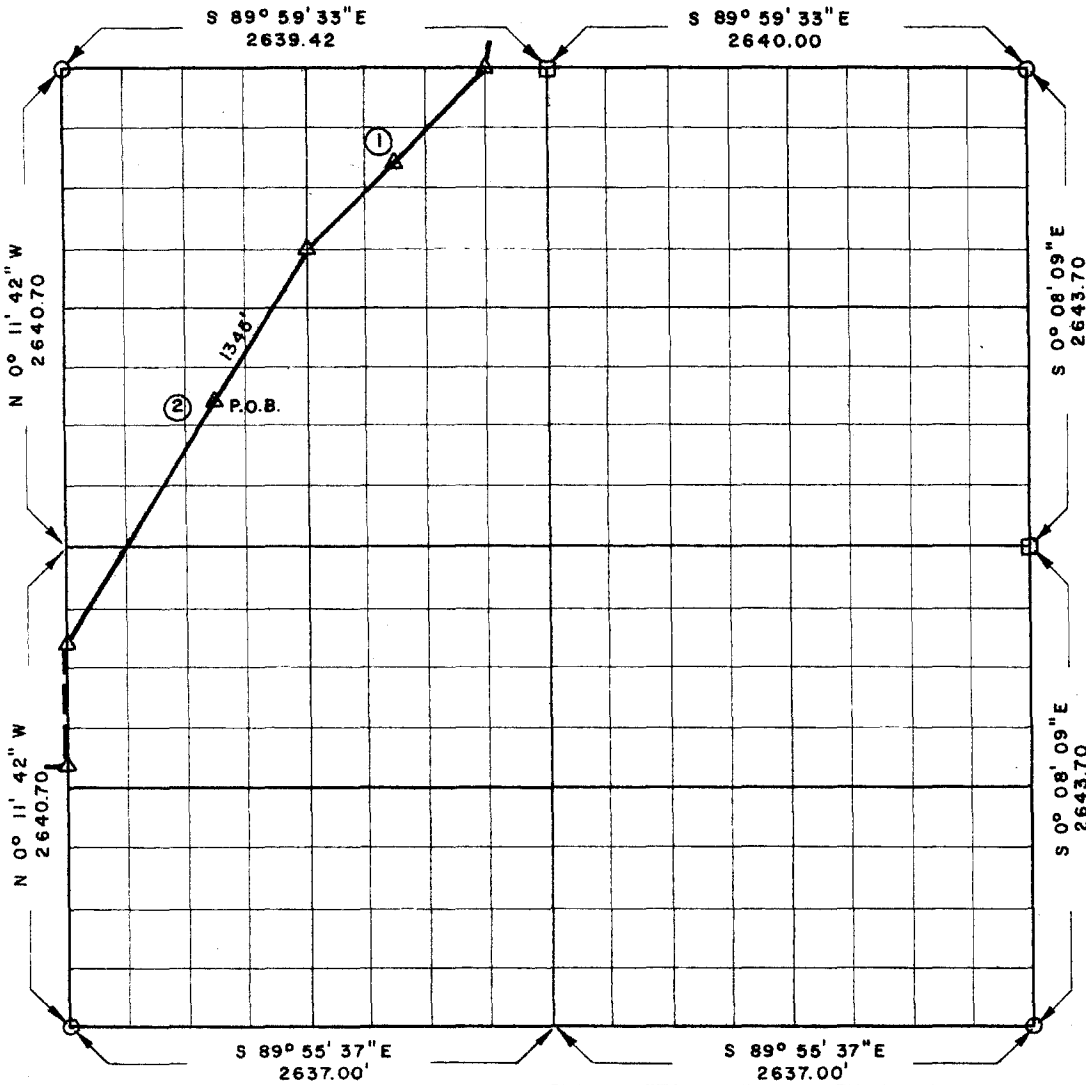

Course No.	Distance	Bearing	Course No.	Distance	Bearing
1	1397.99	S 44° 53' 27" W			
2	2514.62	S 31° 27' 17" W			

CERTIFICATE OF SURVEY Field Book No. A-2776 Date JUNE 1968

I, JAMES E. CURRY, A REGISTERED PROFESSIONAL ENGINEER, DO HEREBY CERTIFY THAT THE ABOVE PLAT IS A TRUE AND ACCURATE SURVEY OF SEC. 22, T 11 N, R 21 E, OKLAHOMA, AS MADE UNDER MY SUPERVISION.

JAMES E. CURRY COMPANY
Under the Supervision of
U.S. ARMY ENGINEER DISTRICT, TULSA
CORPS OF ENGINEERS

LEGEND
 Δ MONUMENT
 □ ORIGINAL CORNER
 ○ IRON PIN