

**PARTIAL BOUNDARY SURVEYS  
ROBERT S. KERR LOCK & DAM 15  
ARKANSAS RIVER, OKLAHOMA**

Performed Under Contract Number DACW 56-68-C-0243

**SEC 5 T-11-N R-21-E COUNTY SEQUOYAH**

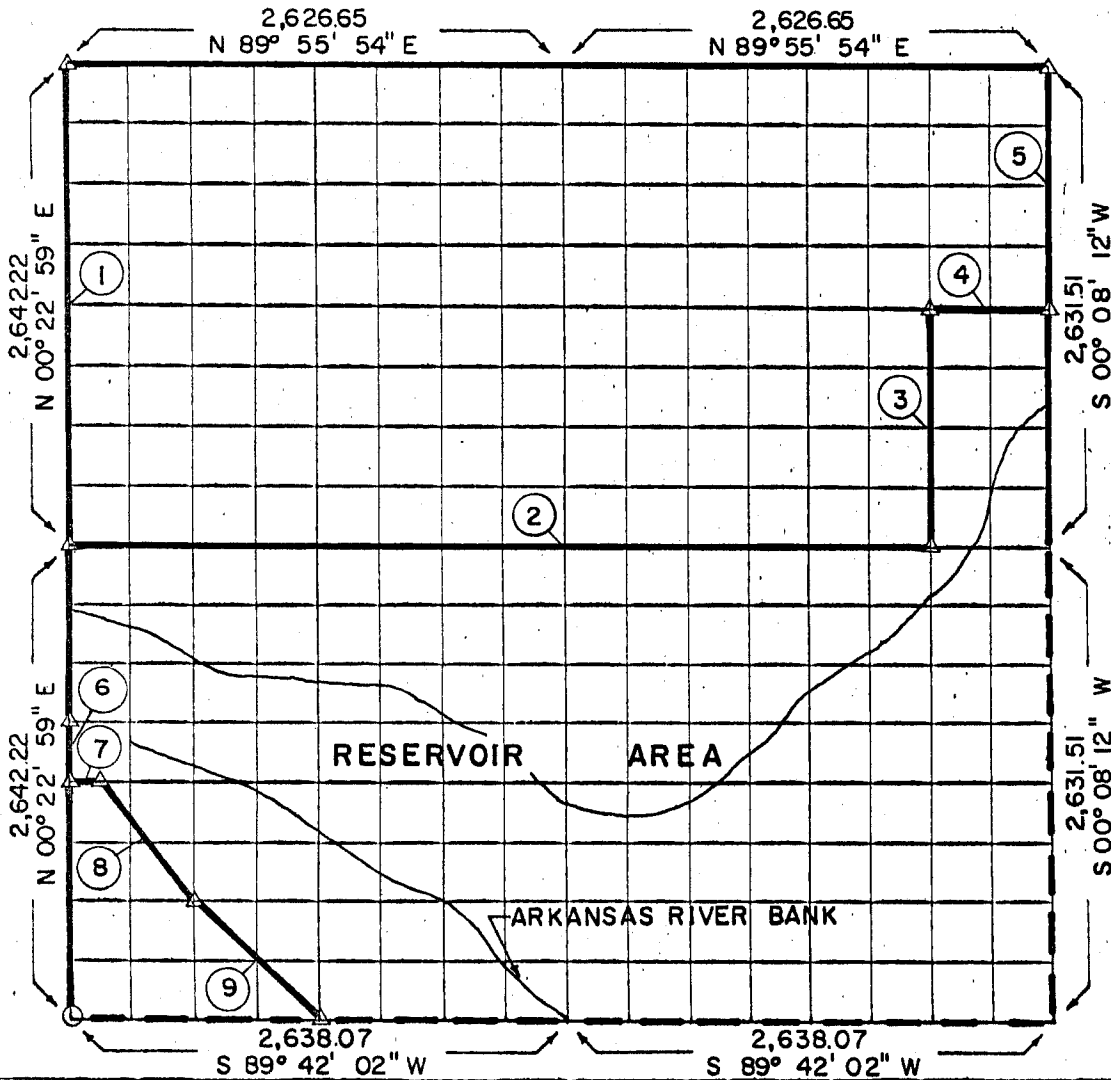

| Course No. | Distance | Bearing     | Course No. | Distance | Bearing |
|------------|----------|-------------|------------|----------|---------|
| 1.         | 2642.22  | N00°22'59"E |            |          |         |
| 2.         | 4606.62  | N89°48'57"E |            |          |         |
| 3.         | 1316.42  | N00°10'03"E |            |          |         |
| 4.         | 657.37   | N89°52'26"E |            |          |         |
| 5.         | 1315.76  | N00°08'12"E |            |          |         |
| 6.         | 330.28   | N00°22'59"E |            |          |         |
| 7.         | 164.70   | N89°45'30"E |            |          |         |
| 8.         | 820.47   | S36°42'19"E |            |          |         |
| 9.         | 927.86   | S44°54'46"E |            |          |         |

Book No. A 2883

Date: November 13, 1968

- △ Monument
- Original Corner
- Iron Pin

I, Jack R. Kalman, a Registered Professional Engineer, do hereby certify that the above plat is a true and accurate survey of Section 5, T-11-N, R-21-E as made under my supervision.

  
**JACK R. KALMAN**  
 Reg. Prof. Engr. No. 2766