

**PARTIAL BOUNDARY SURVEYS  
ROBERT S. KERR LOCK AND DAM  
ARKANSAS RIVER, OKLAHOMA**

Performed Under Contract Number DACW 56-76-C-0050

SEC. 27    T 11 N    R 22 E    COUNTY HASKELL

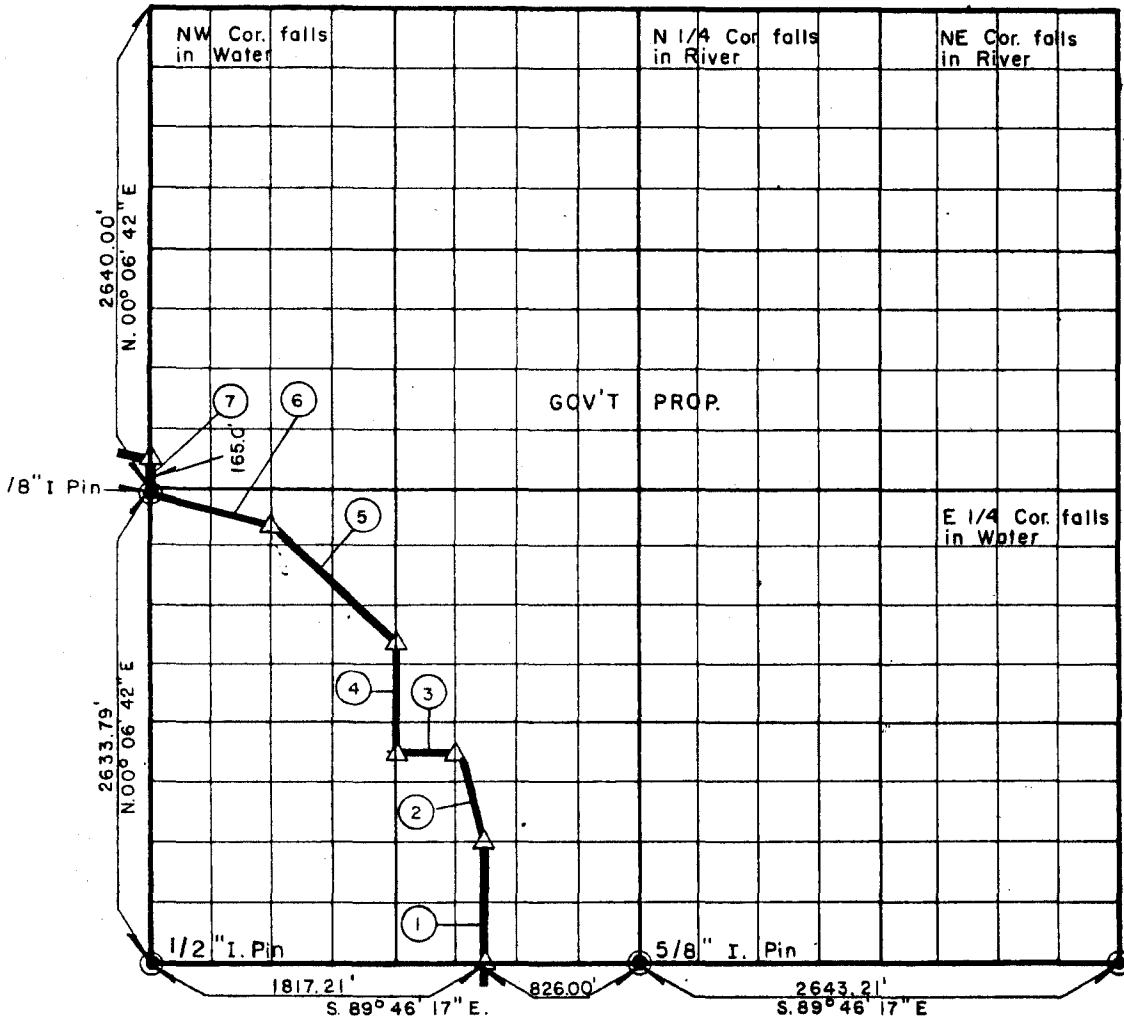

Course No.	Distance	Bearing	Course No.	Distance	Bearing
1	658.45'	N 00° 06' 42" E			
2	521.34'	N 18° 29' 57" W			
3	329.22'	N 89° 46' 17" W			
4	609.61'	N 00° 06' 42" E			
5	970.91'	N 42° 46' 43" W			
6	680.66'	N 76° 00' 44" W			
7	165.00'	N 00° 06' 42" E			

CERTIFICATE OF SURVEY Field Book No. A-3323 Date JAN., 1976

I HEREBY CERTIFY THAT THE ABOVE PLAT IS A TRUE AND CORRECT REPRESENTATION OF THE SURVEY MADE IN ACCORDANCE WITH THE PROVISIONS OF THE ACTS OF MARCH 3, 1879, AND MARCH 3, 1893, IN THE COUNTY OF HASKELL, OKLAHOMA.

*William W. Vaughan*  
WILLIAM W. VAUGHAN  
REGISTERED L.S. NO. 308  
OKLAHOMA

**BRAWLEY ENGINEERING CORP**  
**CONSULTING ENGINEERS**  
Under the Supervision of  
**U.S. ARMY ENGINEER DISTRICT, TULSA**  
**CORPS OF ENGINEERS**

**LEGEND**  
 ▲ MONUMENT  
 □ ORIGINAL CORNER-BRASS CA  
 ● IRON PIN IN PLACE