

**PARTIAL BOUNDARY SURVEYS
ROBERT S. KERR LOCK & DAM 15
ARKANSAS RIVER, OKLAHOMA**

Performed Under Contract Number DA-34-066-Civeng 66-224

SEC 28 T-11-N R-22-E COUNTY SEQUOYAH
& HASKELL

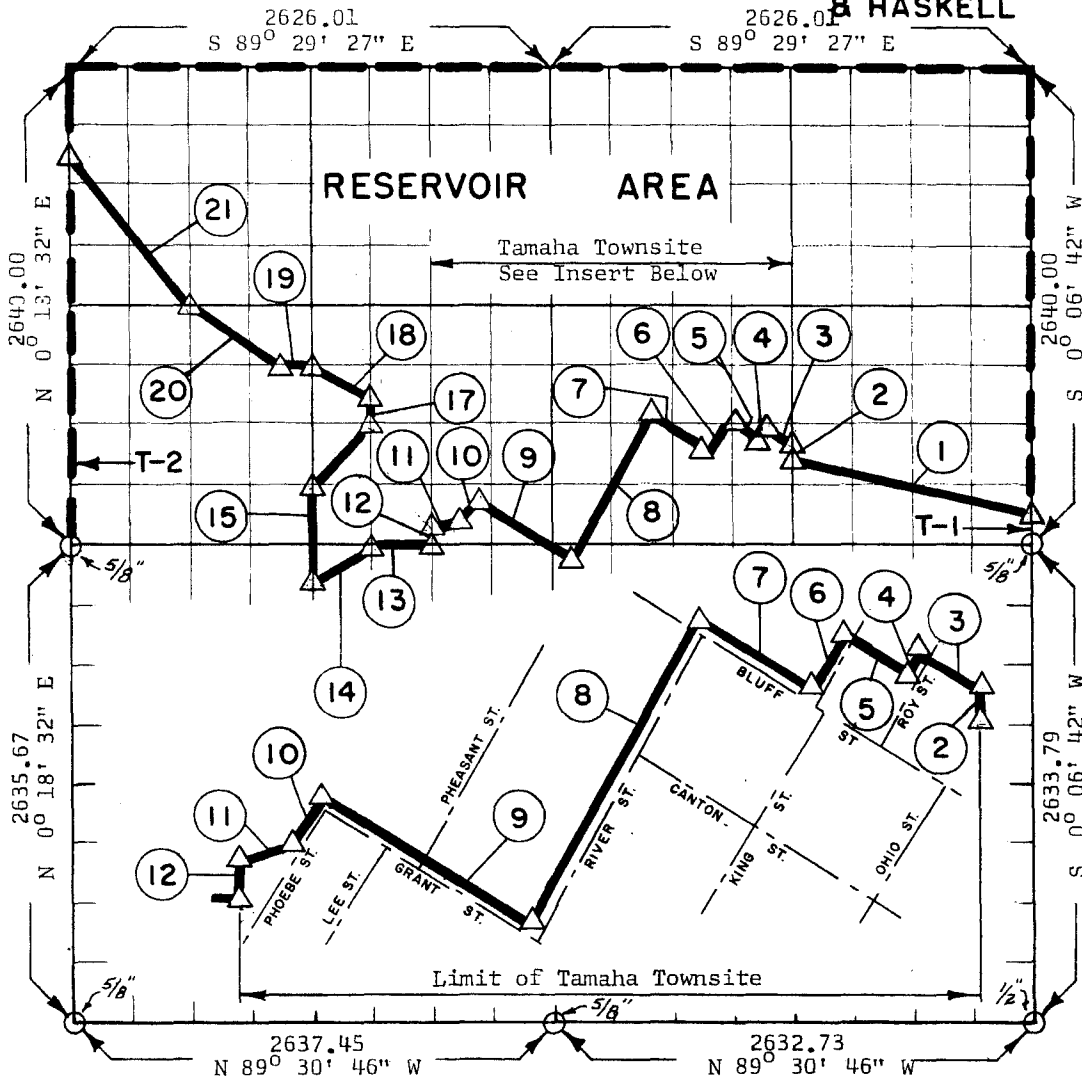

| Course No. | Distance | Bearing | Course No. | Distance | Bearing |
|------------|----------|-----------------|------------|----------|-----------------|
| 1 | 1357.15 | N 75° 24' 26" W | 14 | 365.44 | S 63° 41' 57" W |
| 2 | 69.46 | N 0° 13' 27" E | 15 | 495.15 | N 0° 06' 07" E |
| 3 | 150.17 | N 57° 39' 52" W | 16 | 464.79 | N 45° 16' 06" E |
| 4 | 40.00 | S 32° 18' 55" W | 17 | 165.09 | N 0° 17' 55" E |
| 5 | 199.96 | N 57° 39' 45" W | 18 | 368.17 | N 62° 49' 28" W |
| 6 | 199.95 | S 32° 19' 11" W | 19 | 165.00 | N 89° 29' 35" W |
| 7 | 389.90 | N 57° 39' 40" W | 20 | 593.24 | N 55° 38' 40" W |
| 8 | 931.12 | S 29° 18' 52" W | 21 | 1056.39 | N 38° 07' 00" W |
| 9 | 629.86 | N 57° 39' 35" W | | | |
| 10 | 159.95 | S 32° 18' 58" W | T-1 | 165.00 | N 0° 06' 42" E |
| 11 | 152.26 | S 81° 18' 15" W | T-2 | 2145.00 | S 0° 18' 32" W |
| 12 | 108.67 | S 0° 14' 27" W | | | |
| 13 | 328.50 | N 89° 27' 52" W | | | |

CERTIFICATE OF SURVEY Field Book No. DA-2441 Date May 28, 1966

I HEREBY CERTIFY THAT THE ABOVE PLAT IS A TRUE AND CORRECT REPRESENTATION OF THE SURVEY MADE IN SECTION 28, T-11-N, R-22-E, SEQUOYAH COUNTY & HASKELL OKLAHOMA.

WHEELER & ASSOCIATES, ENGINEERS
Under the Supervision of
U.S. ARMY ENGINEER DISTRICT, TULSA
CORPS OF ENGINEERS

LEGEND
 ▲ MONUMENT
 □ ORIGINAL CORNER
 ○ IRON PIN
 ■ HWY R/W MARKER

W. W. Wheeler