

**PARTIAL BOUNDARY SURVEYS
ROBERT S. KERR LOCK & DAM 15
ARKANSAS RIVER, OKLAHOMA**

Performed Under Contract Number DA-34-066-Civeng 66-224

SEC 4 T-11-N R-22-E COUNTY SEQUOYAH

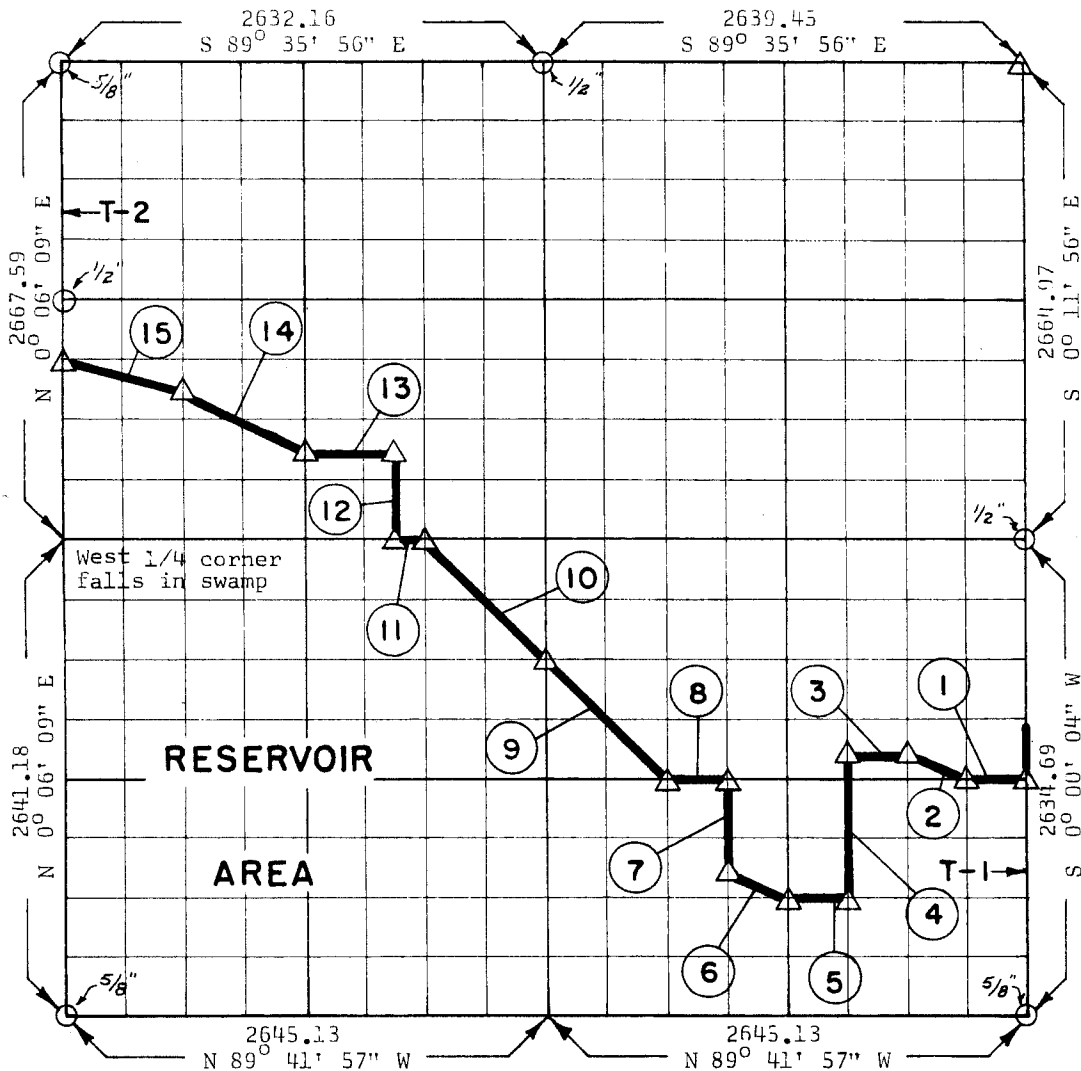

Course No.	Distance	Bearing	Course No.	Distance	Bearing
1	330.75	N 89° 39' 51" W	14	738.99	N 63° 05' 17" W
2	370.39	N 63° 15' 33" W	15	680.34	N 75° 33' 49" W
3	330.77	N 89° 39' 35" W			
4	823.72	S 0° 00' 49" E			
5	330.70	N 89° 40' 54" W			
6	370.36	N 63° 15' 41" W	T-1	1317.35	N 0° 00' 04" E
7	494.38	N 0° 01' 24" W	T-2	1677.15	N 0° 06' 09" E
8	330.75	N 89° 39' 51" W			
9	937.12	N 44° 56' 18" W			
10	936.11	N 44° 50' 27" W			
11	164.92	N 89° 37' 39" W			
12	494.80	N 0° 00' 22" E			
13	494.53	N 89° 36' 52" W			

CERTIFICATE OF SURVEY Field Book No. XA-2438 Date May 10, 1966

I HEREBY CERTIFY THAT THE ABOVE PLAT IS A TRUE AND CORRECT REPRESENTATION OF THE SURVEY MADE IN SECTION 4, T-11-N, R-22-E, SEQUOYAH COUNTY OKLAHOMA.

WHEELER & ASSOCIATES, ENGINEERS
Under the Supervision of
U.S. ARMY ENGINEER DISTRICT, TULSA
CORPS OF ENGINEERS

LEGEND
 ▲ MONUMENT
 □ ORIGINAL CORNER
 ○ IRON PIN
 ■ HWY R/W MARKER

W. W. Wheeler