

PARTIAL BOUNDARY SURVEYS

ROBERT S. KERR LOCK & DAM 15

ARKANSAS RIVER, OKLAHOMA

Performed Under Contract No. DACW 56-68-C-0105

SEC. 22 T-11-N R-23-E COUNTY SEQUOYAH

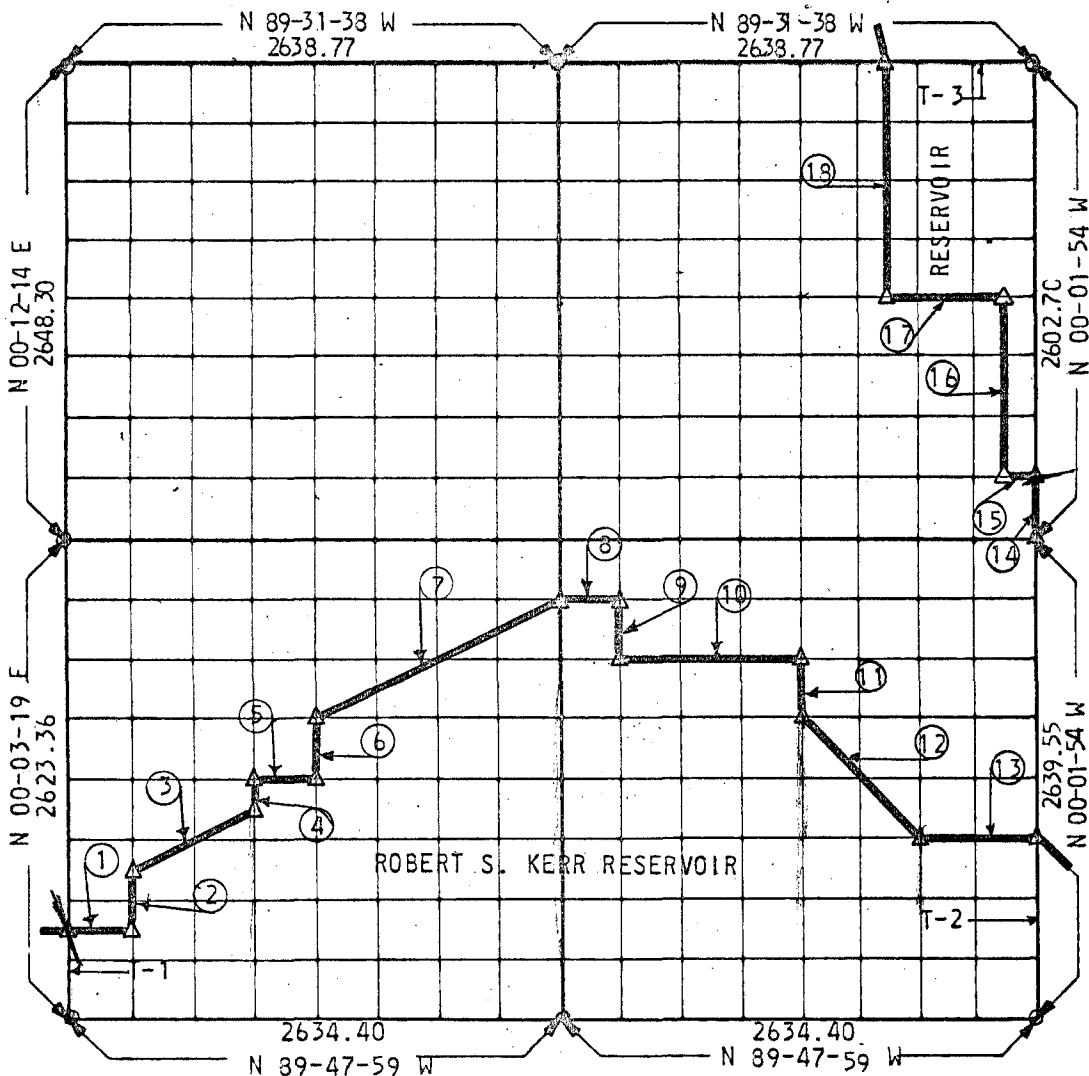

Course No.	Distance	Bearing	Course No.	Distance	Bearing
1	329.31	S 89-49-59 E	14	325.84	N 00-01-54 W
2	328.05	N 00-03-30 W	15	164.80	N 89-55-17 W
3	734.72	N 63-36-16 E	16	978.00	N 00-02-05 W
4	164.17	N 00-03-51 W	17	659.40	N 89-45-05 W
5	329.22	S 89-53-15 E	18	1306.60	N 00-02-49 W
6	328.43	N 00-04-23 E			
7	1470.25	N 63-30-36 E	T-1	491.88	
8	329.58	S 89-57-10 E	T-2	989.83	
9	329.06	S 00-04-23 E	T-3	824.62	
10	988.47	S 89-55-55 E			
11	329.44	S 00-03-19 E			
12	933.26	S 44-57-22 E			
13	658.78	S 89-51-57 E			
			10,627.28v		

Field Book No. A-281 Date 4-28-68

PHELPS, SPITZ, AMMERMAN & THOMAS INC.

Under the Supervision of

U.S. ARMY ENGINEER DISTRICT, TULSA
CORPS OF ENGINEERS

SHEET 3 of 14

LEGEND

- Δ MONUMENT
- ORIGINAL CORNER
- IRON PIN

CERTIFICATE OF SURVEY

I HEREBY CERTIFY THAT THE ABOVE PLAT IS A TRUE AND CORRECT REPRESENTATION OF THE SURVEY MADE IN SECTION 22, T-11, N, R-23, E, SEQUOYAH COUNTY, OKLAHOMA.