

SEC , T-12 - N, R-20 - E, MUS JEGEE COUNTY, OKLAHOMA

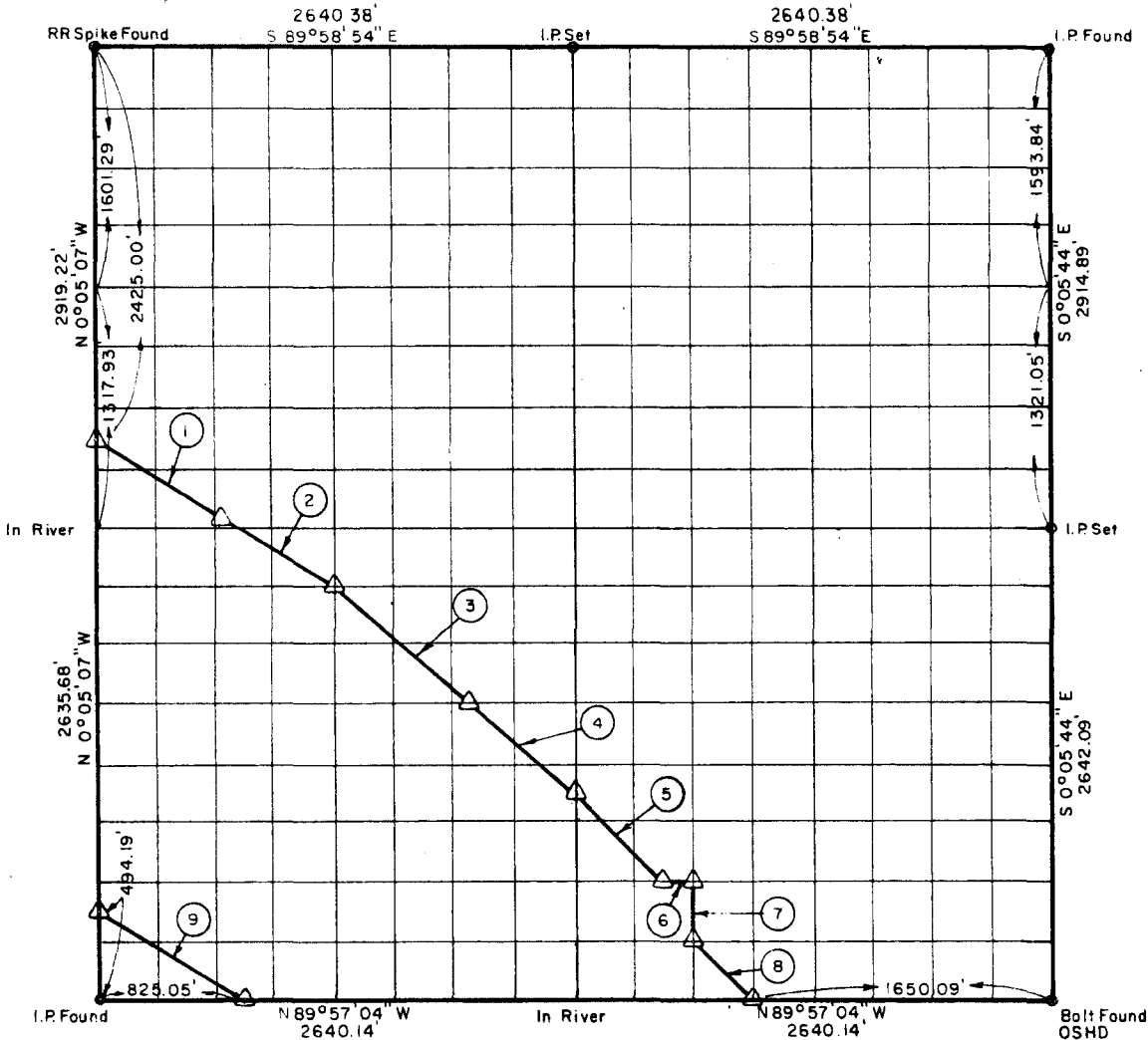

Date Surveyed July 1968 Book No. A-2866 Scale: 1:10,000

COURSE NO.	DISTANCE	BEARING	COURSE NO.	DISTANCE	BEARING
1	800.00'	S 58°02'02" E			
2	757.57'	S 58°02'02" E			
3	1,000.00'	S 48°54'36" E			
4	754.06'	S 48°54'36" E			
5	700.73'	S 45°02'17" E			
6	165.01'	S 89°57'18" E			
7	329.96'	S 0°05'36" E			
8	467.12'	S 45°02'20" E			
9	962.73'	S 59°03'58" E			

PARTIAL BOUNDARY SURVEYS, ROBERT S. KERR LOCK & DAM 15, ARKANSAS RIVER OKLAHOMA

BY
CRAIG AND KEITHLINE
CONSULTING ENGINEERS

FOR
DEPARTMENT OF THE ARMY, CORPS OF ENGINEERS, TULSA DISTRICT, UNDER
CONTRACT NO. DACW 56-68-C-0242

I, Charles R. Keithline, a Registered Professional Engineer in the State of Oklahoma do hereby certify that the above plat is a true and accurate survey of Section 1, T-12-N, R-20-E, as made under my supervision.

Charles R. Keithline
CHARLES R. KEITHLINE, Reg. No. 2834 (Okla.)

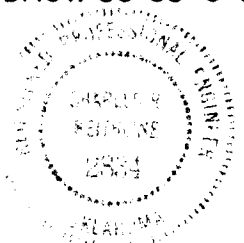

- LEGEND
- △ Std. C. of E. Conc. Monument
 - Iron Pin
 - Original Stone