

SEC. 19 19 T-12-N, R-21-E, MUSKOGEE COUNTY, OKLAHOMA

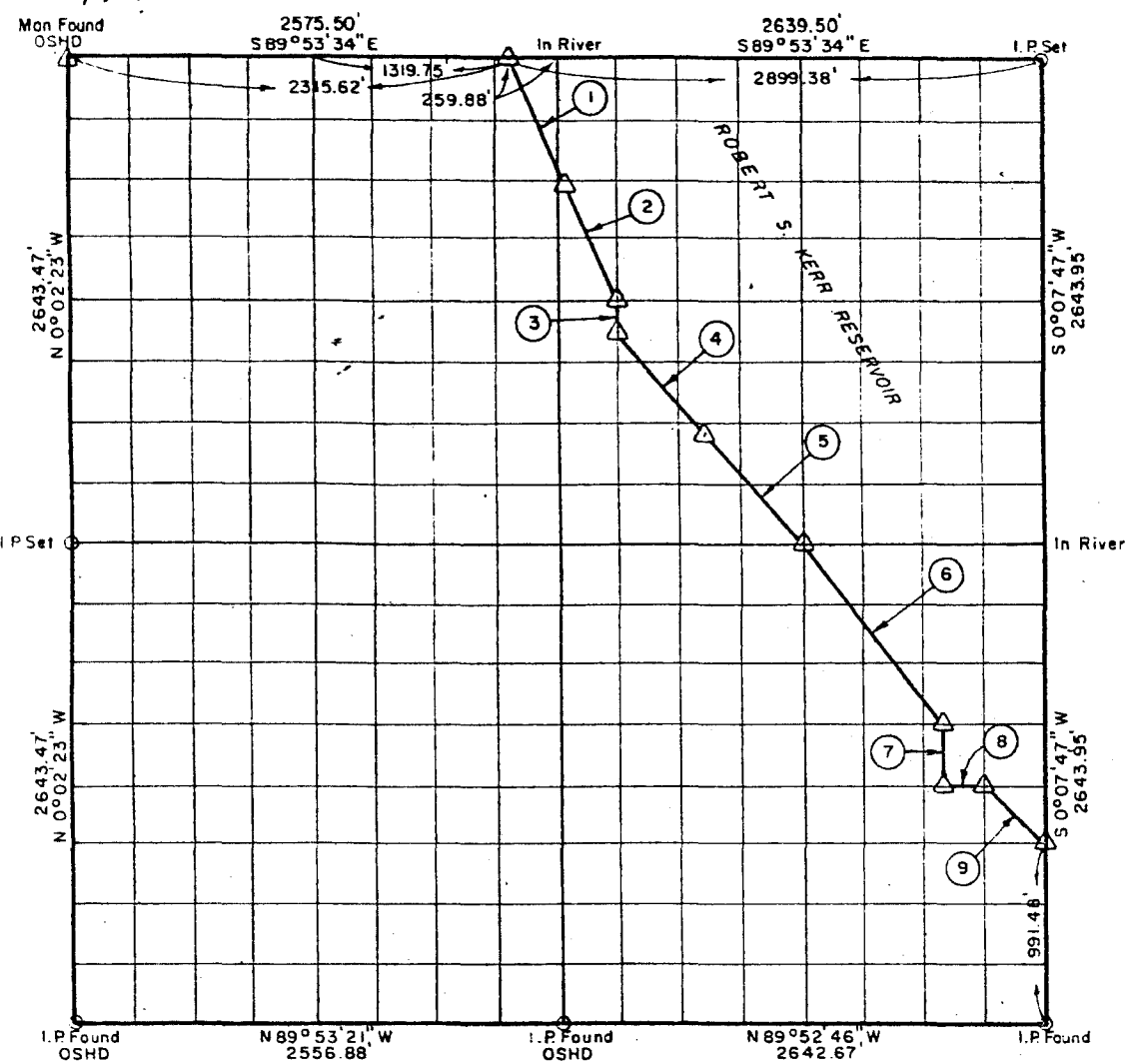

Date Surveyed June 1968 Book No. A-2875 Scale: 1:10,000

COURSE NO.	DISTANCE	BEARING	COURSE NO.	DISTANCE	BEARING
1	750.00'	S 23° 57' 23" E			
2	698.06'	S 23° 57' 23" E			
3	170.00'	S 0° 05' 25" W			
4	750.00'	S 40° 30' 02" E			
5	766.87'	S 40° 30' 02" E			
6	1,268.49'	S 38° 28' 44" E			
7	330.49'	S 0° 07' 06" W			
8	198.71'	S 89° 52' 58" E			
9	467.16'	S 44° 51' 15" E			
		5,399.78 ✓			

TOTAL BOUNDARY SURVEYS, ROBERT S. KERR LOCK & DAM 15, ARKANSAS RIVER, OKLAHOMA

BY
CRAIG AND KEITHLINE
CONSULTING ENGINEERS

FOR
DEPARTMENT OF THE ARMY, CORPS OF ENGINEERS, TULSA DISTRICT, UNDER
CONTRACT NO. DACW 56-68-C-0242

Charles R. Keithline, a Registered Professional Engineer in the State of Oklahoma do hereby certify that the above plat is a true and accurate survey of Section 19, T-12-N, R-21-E, as made under my supervision.

Charles R. Keithline
CHARLES R. KEITHLINE, Reg. No. 2834 (Okla.)



LEGEND
 Δ Std. C. of E. Conc. Monument
 ○ Iron Pin