

PARTIAL BOUNDARY SURVEYS
ROBERT S. KERR LOCK & DAM 15
ARKANSAS RIVER, OKLAHOMA

Performed Under Contract Number DACW 56-68-C-0243

SEC 28 T-12-N R-21-E COUNTY SEQUOYAH

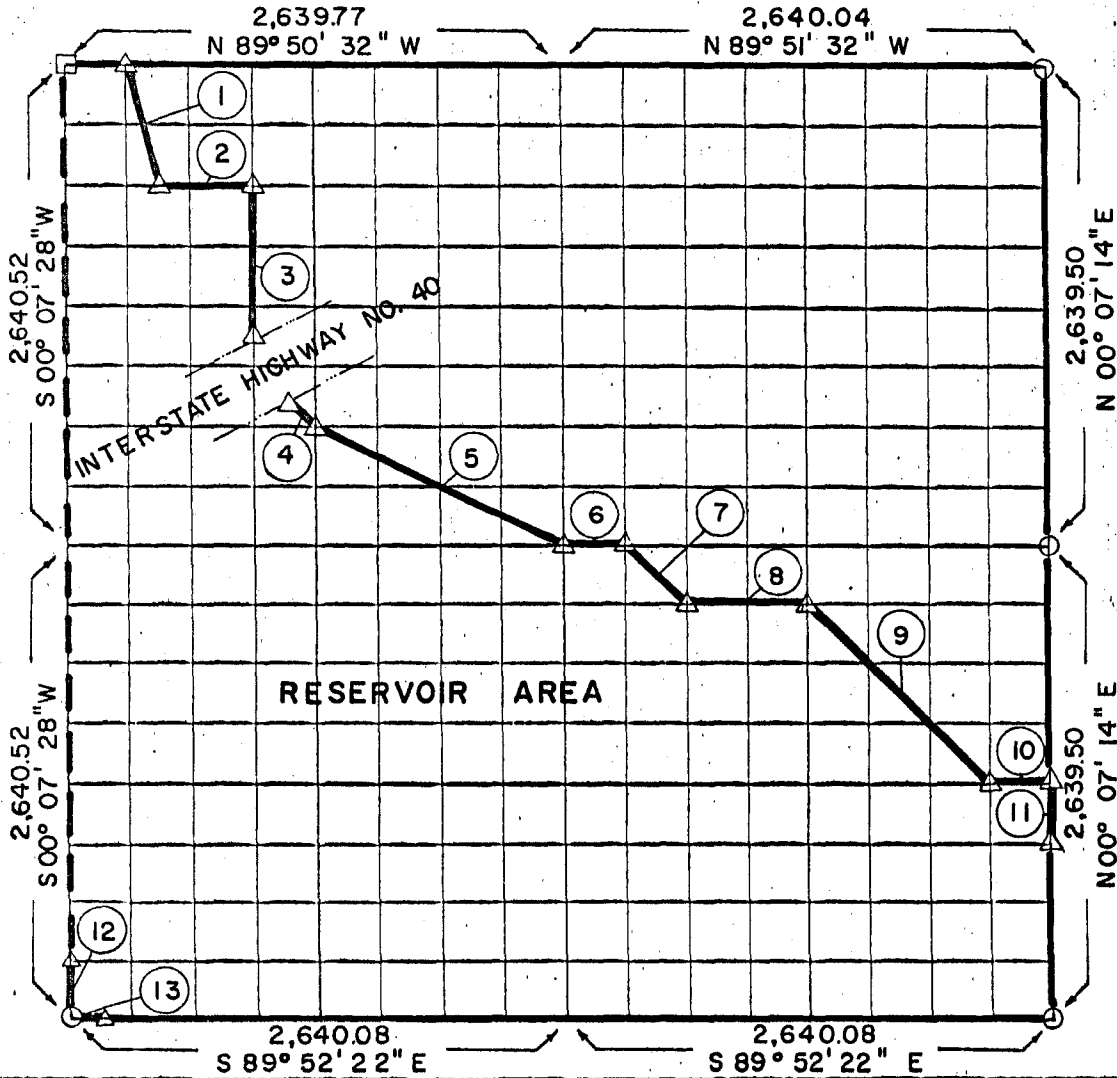

Course No.	Distance	Bearing	Course No.	Distance	Bearing
1.	680.50	S13°54'26"E			
2.	494.96	S89°50'46"E			
3.	865.06	S00°07'23"W			
4.	150.00	S44°51'40"E			
5.	1475.99	S63°17'39"E			
6.	330.01	S89°51'57"E			
7.	466.73	S44°52'33"E			
8.	660.02	S89°52'00"E			
9.	1400.12	S44°52'43"E			
10.	330.01	S89°52'09"E			
11.	329.94	S00°07'14"W			
12.	330.01	S00°07'28"W			
13.	165.00	S89°52'22"E			

Book No. A 2886 Date: November 14, 1968

- △ Monument
- Original Corner
- Iron Pin

I, Jack R. Kalman, a Registered Professional Engineer, do hereby certify that the above plat is a true and accurate survey of Section 28, T-12-N, R-21-E as made under my supervision.

Jack R. Kalman
JACK R. KALMAN
 Reg. Prof. Eng. No. 2766