

PARTIAL BOUNDARY SURVEYS
 ROBERT S. KERR LOCK AND DAM 15
 ARKANSAS RIVER, OKLAHOMA

Performed Under Contract Number DA-34-066-Civeng 66-214

SEC 12 T -9-N R -22-E COUNTY HASKELL

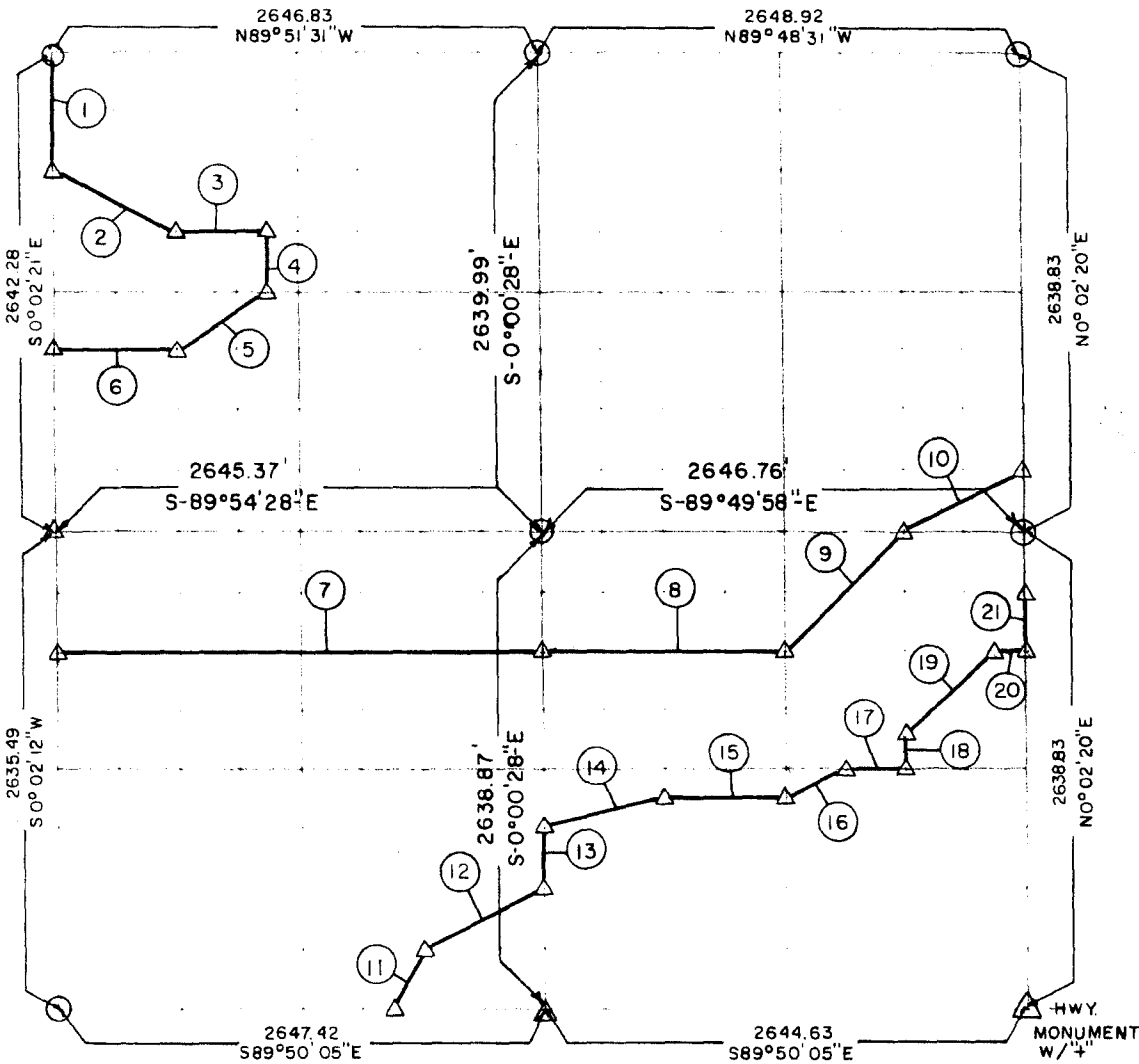

Course No.	Distance	Bearing	Course No.	Distance	Bearing
1	660.57	S 0° 02' 21" E	14	681.16	N 76° 09' 12" E
2	740.27	S 63° 22' 43" E	15	661.39	S 89° 50' 01" E
3	496.18	S 89° 52' 39" E	16	369.17	N 63° 37' 44" E
4	330.16	S 0° 01' 32" E	17	330.71	S 89° 50' 01" E
5	595.27	S 56° 25' 31" W	18	164.92	N 0° 01' 36" E
6	661.48	N 89° 53' 21" W	19	699.87	N 45° 10' 36" E
7	2645.88	S 89° 53' 22" E	20	165.39	S 89° 50' 01" E
8	1323.12	S 89° 50' 01" E	21	329.85	N 0° 02' 20" E
9	933.15	N 45° 10' 36" E			
10	738.69	N 63° 38' 41" E			
11	368.52	N 26° 41' 02" E			
12	738.59	N 63° 37' 50" E			
13	329.86	N 0° 00' 28" W			

13,964.204

CERTIFICATE OF SURVEY Field Book No. A-2407 Date 3-31-66

HEREBY CERTIFY THAT THE ABOVE PLAT IS A TRUE AND CORRECT REPRESENTATION OF THE SURVEY MADE IN SECTION 12, T. 9 N. R. 22 E., HASKELL COUNTY, OKLAHOMA

BREISCH ENGINEERING COMPANY
 Under the Supervision of
 U.S. ARMY ENGINEER DISTRICT, TULSA
 CORPS OF ENGINEERS

LEGEND
 Δ MONUMENT
 □ ORIGINAL CORNER
 ○ IRON PIN

REGISTERED PROFESSIONAL ENGINEER