

PARTIAL BOUNDARY SURVEYS
 ROBERT S. KERR LOCK AND DAM 15
 ARKANSAS RIVER, OKLAHOMA

Performed Under Contract Number DACW 56-68-C-0100

SEC 33 T-9-N R-22-E COUNTY HASKELL

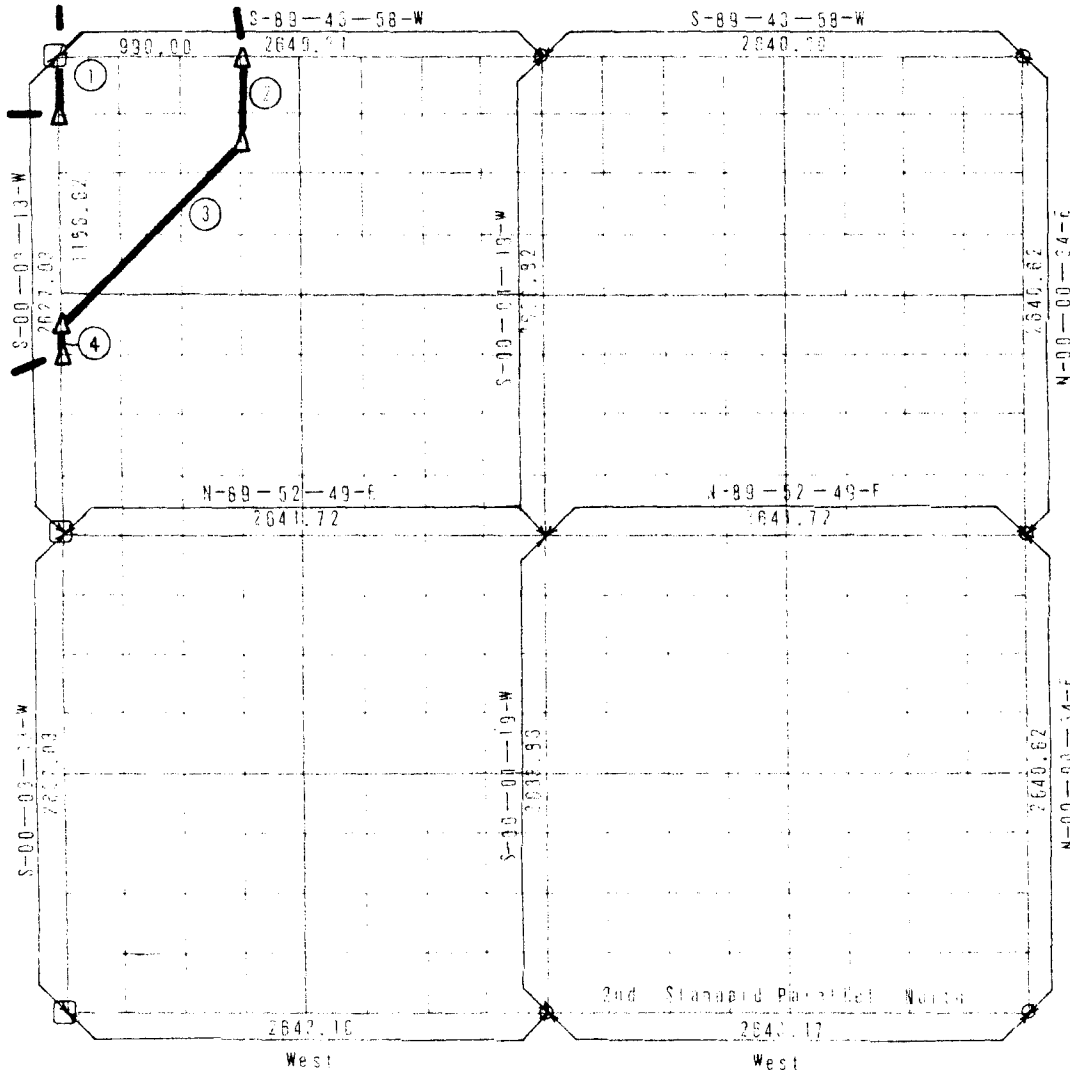

Course No.	Distance	Bearing	Course No.	Distance	Bearing
1	228.16	N-00-00-13-E			
2	435.00	S-00-00-13-W			
3	1403.93	S-44-07-35-W			
4	155.89	S-00-00-13-W			

CERTIFICATE OF SURVEY
 WHEREBY CERTIFY THAT THE ABOVE PLAT IS A TRUE AND CORRECT REPRODUCTION OF THE SURVEY MADE IN SECTION 33 T-9-N R-22-E HASKELL COUNTY, OKLAHOMA

Field Book No. 8-276 Date June 28, 1923

ARKANSAS BASIN SURVEYORS, INC.
 Under the Supervision of
 U.S. ARMY ENGINEER DISTRICT, TULSA
 CORPS OF ENGINEERS

LEGEND
 1 MONUMENT
 2 ORIGINAL CORNER
 3 IRON PIN