

PARTIAL BOUNDARY SURVEYS
WEBBERS FALL LOCK AND DAM 16
ARKANSAS RIVER, OKLAHOMA

Performed Under Contract Number DACW 56-68-C-0266

SEC 1 T-14 -N R-19 -E COUNTY MUSKOGEE

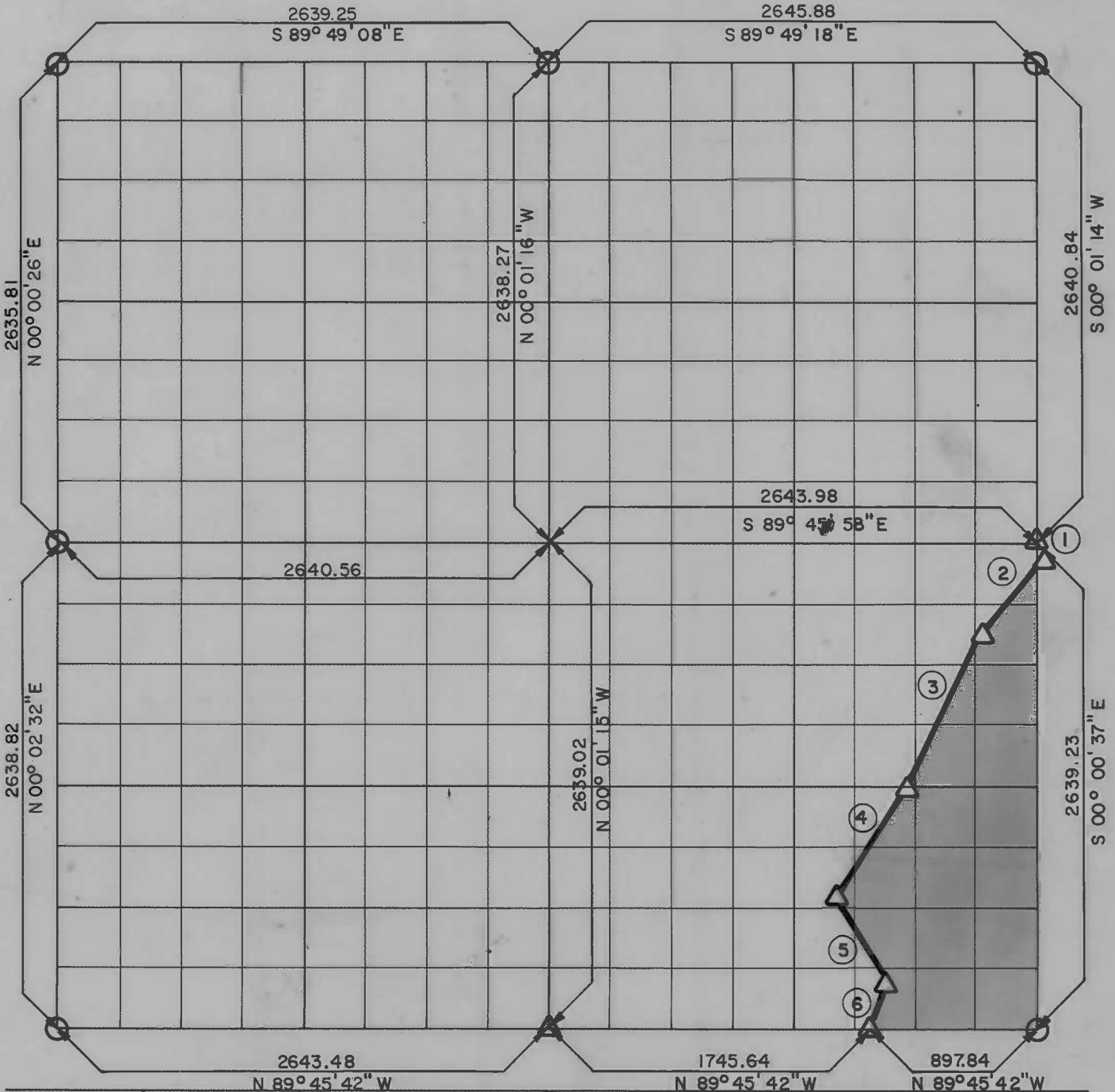

Course No.	Distance	Bearing	Course No.	Distance	Bearing
1	88.29	S 06° 30' 12" E			
2	502.48	S 39° 00' 43" W			
3	935.00	S 23° 23' 40" W			
4	725.72	S 32° 15' 28" W			
5	488.10	S 32° 47' 06" E			
6	291.66	S 19° 22' 39" W			

Field Book No. A 2920 Date: 12/2/68

CERTIFICATE OF SURVEY
I HEREBY CERTIFY THAT THE ABOVE PLAT IS A TRUE AND CORRECT REPRESENTATION OF THE SURVEY MADE IN SECTION 1, T-14-N, R-19-E, MUSKOGEE COUNTY, OKLAHOMA.

HOLWAY ENGINEERS, INC.
Under the Supervision of
U.S. ARMY ENGINEER DISTRICT, TULSA
CORPS OF ENGINEERS

LEGEND
△ MONUMENT
□ ORIGINAL CORNER
○ IRON PIN

Shad Co
REGISTERED PROFESSIONAL ENGINEER