

**PARTIAL BOUNDARY SURVEYS  
WEBBERS FALLS LOCK & DAM NO. 16  
ARKANSAS RIVER, OKLAHOMA**

Performed Under Contract Number DACW 56-68-C-0267

SEC   1   T-15 - N R-18 - E COUNTY MUSKOGEE

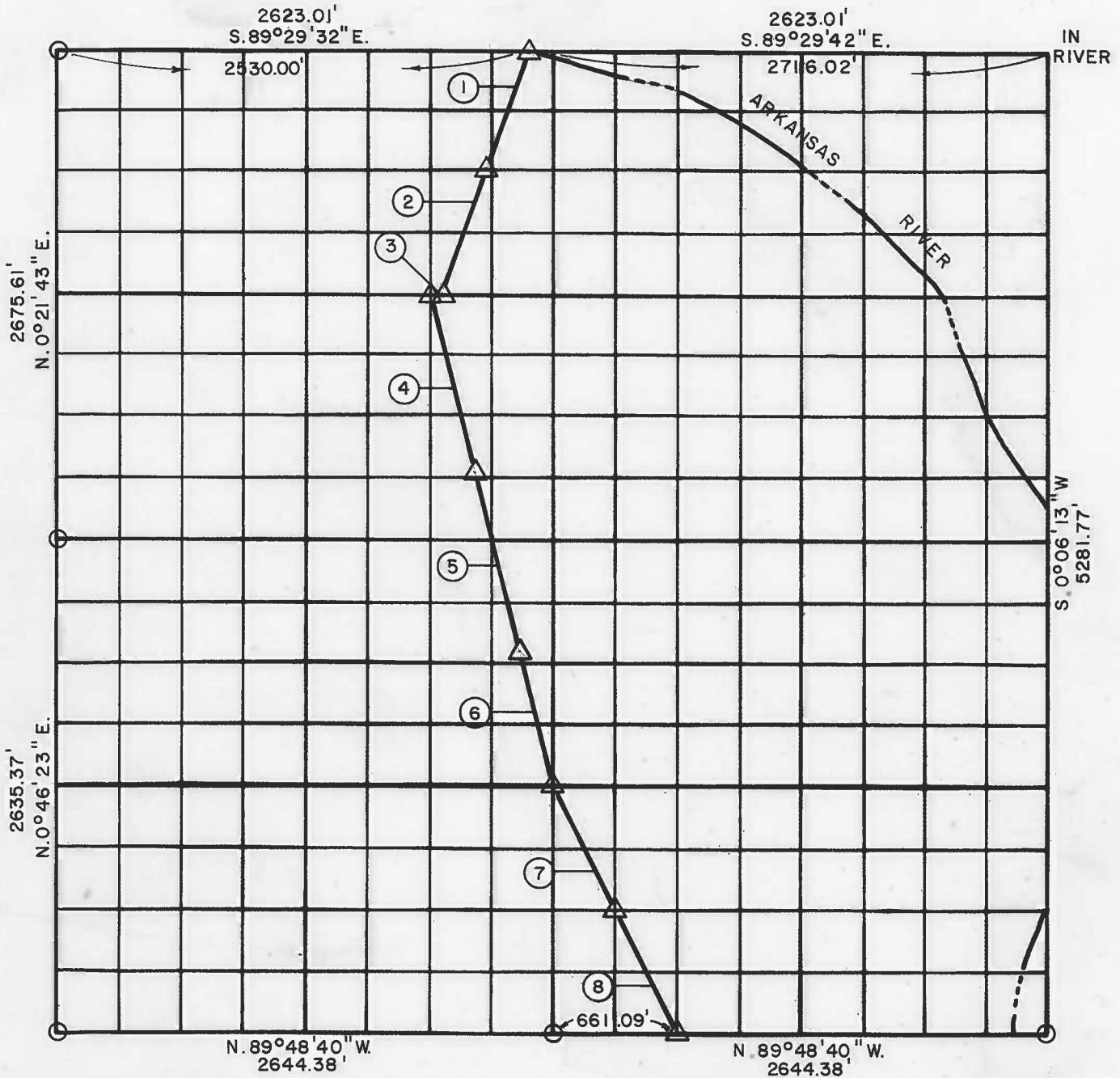

| Course No. | Distance | Bearing         | Course No. | Distance | Bearing |
|------------|----------|-----------------|------------|----------|---------|
| 1          | 717.93'  | S. 21°07'02" W. |            |          |         |
| 2          | 717.93'  | S. 21°07'02" W. |            |          |         |
| 3          | 60.00'   | N. 89°53'16" W. |            |          |         |
| 4          | 1000.00' | S. 13°43'41" E. |            |          |         |
| 5          | 1000.00' | S. 13°43'41" E. |            |          |         |
| 6          | 715.90'  | S. 13°43'41" E. |            |          |         |
| 7          | 737.39'  | S. 26°23'59" E. |            |          |         |
| 8          | 737.39'  | S. 26°23'59" E. |            |          |         |
|            |          |                 |            |          |         |
|            |          |                 |            |          |         |
|            |          |                 |            |          |         |
|            |          |                 |            |          |         |
|            |          |                 |            |          |         |
|            |          |                 |            |          |         |

CERTIFICATE OF SURVEY Field Book No. A-2929 Date: AUG.-NOV. 1968  
Rev. Sept. 1969

HEREBY CERTIFY THAT THE ABOVE PLAT IS A TRUE AND CORRECT REPRESENTATION OF THE SURVEY MADE IN SECTION 15, T 15 N, R 18 E, MUSKOGEE COUNTY, OKLAHOMA.

**E.H. SCHMIDT & ASSOC., INC.**

Under the Supervision of  
**U.S. ARMY ENGINEER DISTRICT, TULSA  
CORPS OF ENGINEERS**  
SHEET 1 of 1

- LEGEND**  
 ▲ MONUMENT  
 □ ORIGINAL CORNER  
 ○ IRON PIN  
 \* COMPUTED DISTANCE

*E.H. Schmidt*  
REGISTERED PROFESSIONAL ENGINEER NO. 2518