

**PARTIAL BOUNDARY SURVEYS
WEBBERS FALLS LOCK & DAM NO. 16
ARKANSAS RIVER, OKLAHOMA**

Performed Under Contract Number DACW 56-68-C-0267

SEC 5 T-15 - N R-19 - E COUNTY MUSKOGEE

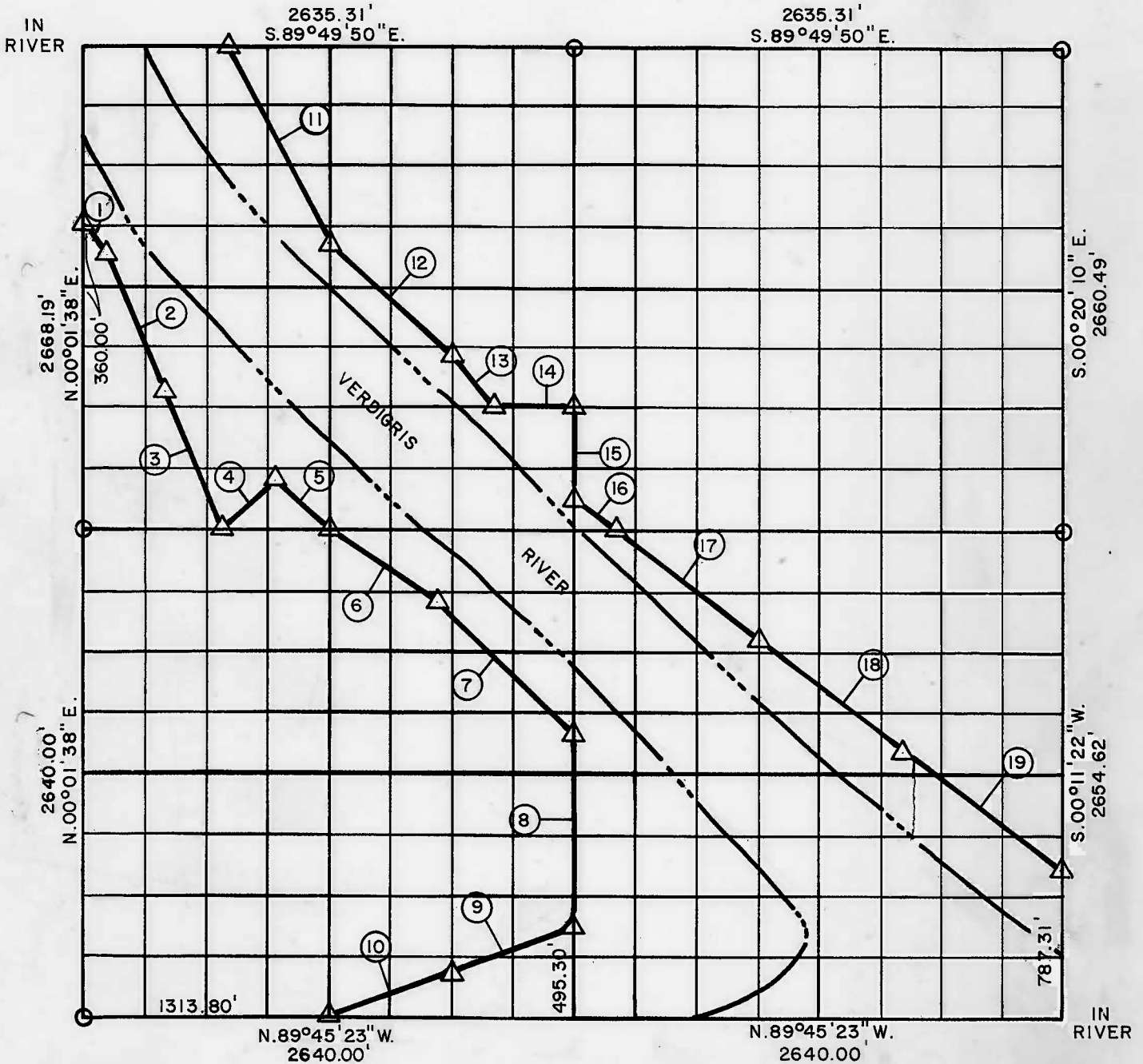

Course No.	Distance	Bearing	Course No.	Distance	Bearing
1	220.00'	S. 30°00'00" E.	14	457.49'	S.89°45'48" E.
2	800.00'	S. 23°03'00" E.	15	523.59'	S.00°01'24" E.
3	821.63'	S. 23°03'00" E.	16	236.45'	S.53°28'17" E.
4	376.92'	N. 42°30'00" E.	17	1000.00'	S.52°34'40" E.
5	421.49'	S. 48°39'53" E.	18	1000.00'	S.52°34'40" E.
6	700.00'	S. 59°00'00" E.	19	1089.63'	S.52°34'40" E.
7	1038.88'	S. 43°22'52" E.			
8	1035.53'	S.00°06'39" W.			
9	700.00'	S.69°34'13" W.			
10	703.00'	S.69°34'13" W.			
11	1221.25'	S. 27°48'14" E.			
12	902.59'	S. 46°56'14" E.			
13	361.30'	S. 33°37'49" E.			

CERTIFICATE OF SURVEY Field Book No. A-2933 Date: AUG.-NOV. 1968

I HEREBY CERTIFY THAT THE ABOVE PLAT IS A TRUE AND CORRECT REPRESENTATION OF THE SURVEY MADE IN SECTION 5, T 15 N, R 19 E, MUSKOGEE COUNTY, OKLAHOMA.

E. H. SCHMIDT & ASSOC., INC.
Under the Supervision of
U.S. ARMY ENGINEER DISTRICT, TULSA
CORPS OF ENGINEERS
SHEET 1 of 1

LEGEND
 Δ MONUMENT
 □ ORIGINAL CORNER
 ○ IRON PIN
 * COMPUTED DISTANCE

Eduard W. Schmidt
REGISTERED PROFESSIONAL ENGINEER NO. 2518