

PARTIAL BOUNDARY SURVEYS
WEBBERS FALLS LOCK & DAM NO. 16
ARKANSAS RIVER, OKLAHOMA

Performed Under Contract Number DACW 56 - 68 - C - 0267

SEC 6 T-15-N R-19-E COUNTY MUSKOGEE

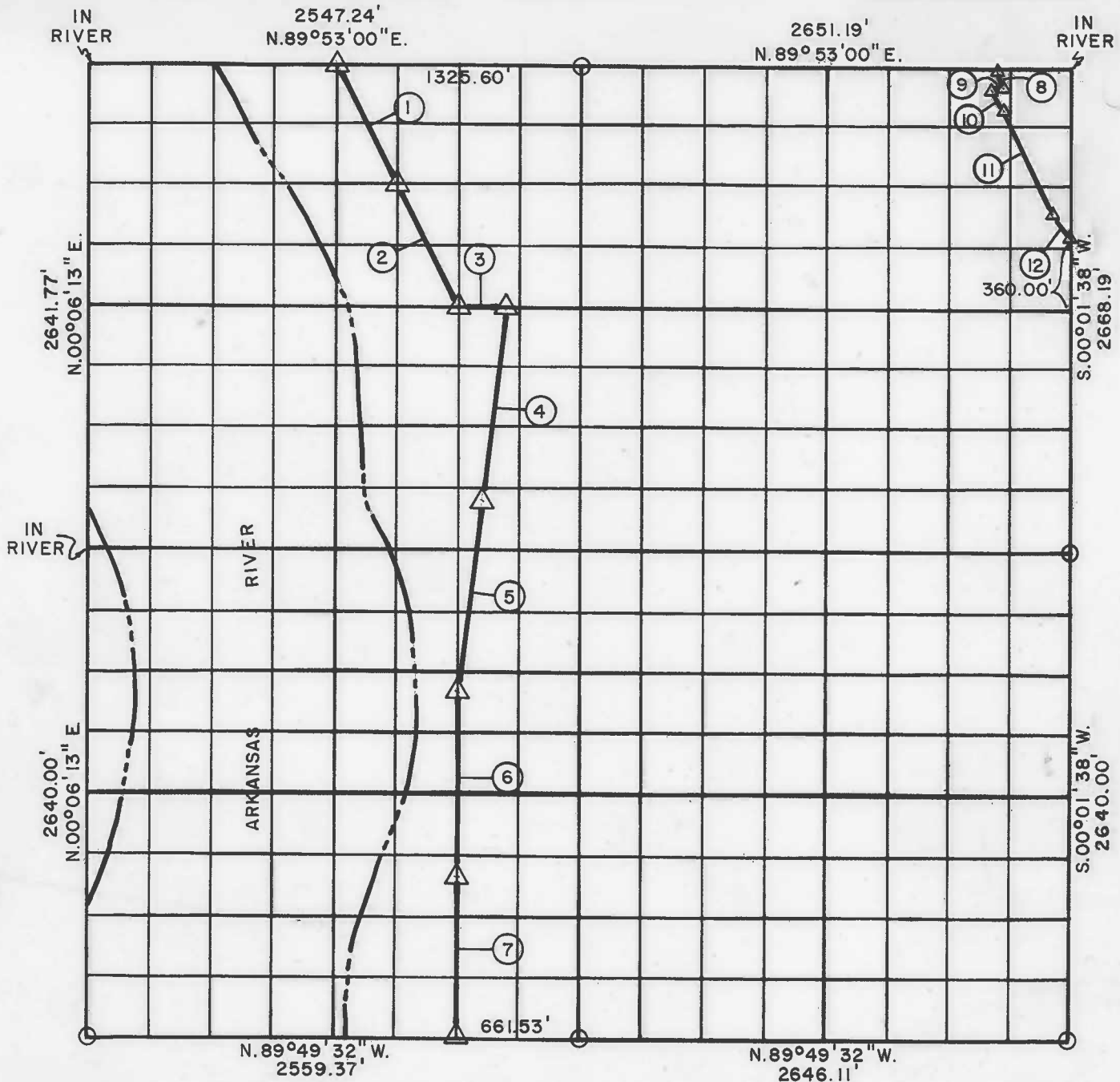

Course No.	Distance	Bearing	Course No.	Distance	Bearing
1	742.78'	S. 26°31'15" E.			
2	743.16'	S. 26°31'15" E.			
3	245.75'	S. 89°48'57" E.			
4	1048.21'	S. 06°57'44" W.			
5	960.90'	S. 06°57'44" W.			
6	1000.00'	S. 00°02'06" E.			
7	965.37'	S. 00°02'06" E.			
8	63.63'	N. 24°50'03" W.			
9	75.00'	N. 66°02'57" W.			
10	127.19'	N. 23°34'30" W.			
11	674.78'	N. 23°11'57" W.			
12	167.57'	N. 35°07'37" W.			

CERTIFICATE OF SURVEY Field Book No. A - 2937 Date: AUG. - NOV. 1968
 Rev. Sept. 1969

I HEREBY CERTIFY THAT THE ABOVE PLAT IS A TRUE AND CORRECT REPRESENTATION OF THE SURVEY MADE IN SECTION 6, T 15 N, R 19 E, MUSKOGEE COUNTY, OKLAHOMA

E. H. SCHMIDT & ASSOC., INC.

Under the Supervision of

U.S. ARMY ENGINEER DISTRICT, TULSA
CORPS OF ENGINEERS
SHEET 1 of 1

LEGEND

- △ MONUMENT
- ORIGINAL CORNER
- IRON PIN
- * COMPUTED DISTANCE

E. H. Schmidt
 REGISTERED PROFESSIONAL ENGINEER NO. 2518