

WISTER LAKE
 POTEAU RIVER, OKLAHOMA
SECTION AND QUARTER SECTION CORNER
REFERENCES FOR

SEC. 21, T 5 N, R 23 E LEFLORE COUNTY

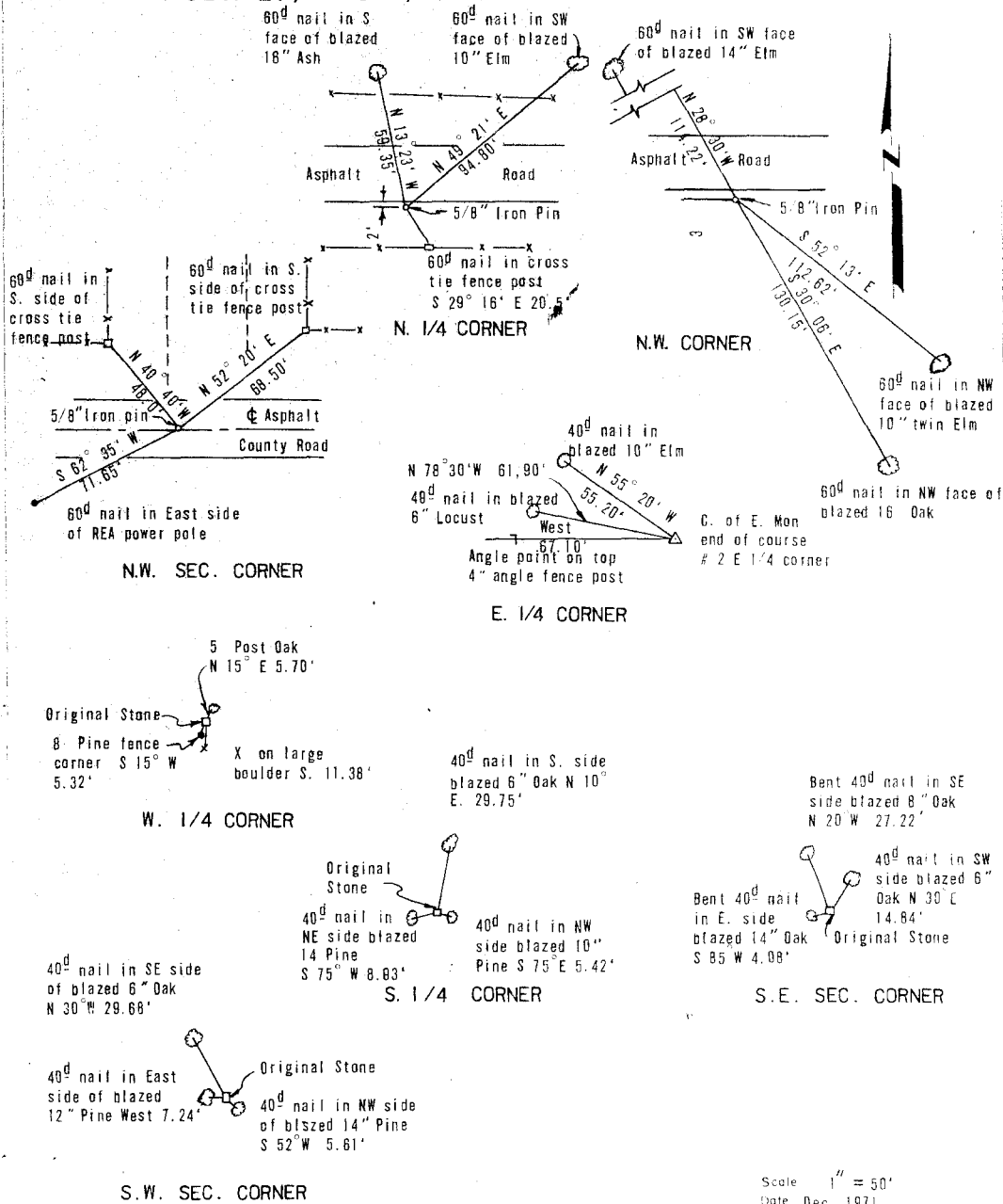

Scale 1" = 50'
 Date Dec. 1971
 Field book No 1-193

LEGEND
 ◊ Monument
 □ Original Corner
 ○ Iron Pin