

PARTIAL BOUNDARY SURVEYS
WISTER LAKE
POTEAU RIVER, OKLAHOMA

Performed Under Contract Number DACW56-72-C-0122

SEC. 24 T 5 N R 23 E COUNTY LE FLORE

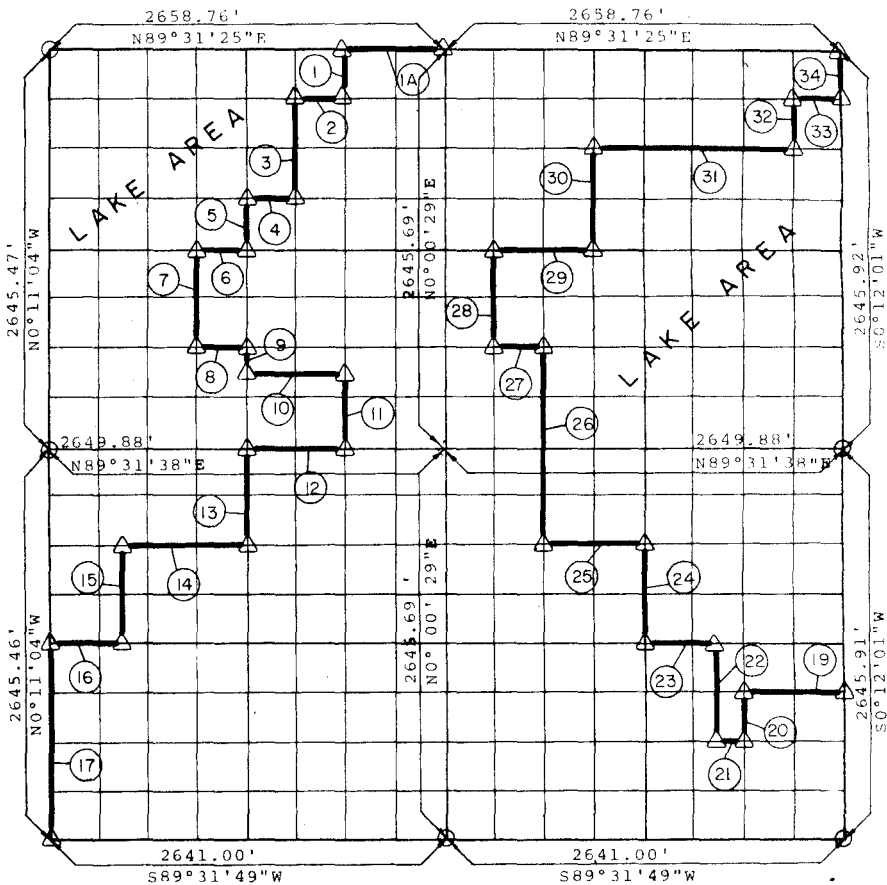

Course No.	Distance	Bearing
1-A	664.70	S89°31'25\"W
1	330.70	S 0°02'24\"E
2	332.21	S89°31'27\"W
3	661.40	S 0°03'51\"E
4	331.93	S89°31'30\"W
5	330.70	S 0°05'17\"E
6	331.79	S89°31'31\"W
7	661.38	S 0°06'42\"E
8	331.51	N89°31'35\"E
9	165.35	S 0°05'17\"E
10	662.88	N89°31'36\"E
11	496.05	S 0°02'24\"E
12	662.47	S89°31'38\"W
13	661.40	S 0°05'17\"E
14	827.40	S89°31'41\"W
15	661.38	S 0°08'54\"E
16	496.02	S89°31'44\"W

Course No.	Distance	Bearing
17	1322.73	S 0°11'04\"E
19	661.08	S89°31'46\"W
20	330.73	S 0°09'08\"W
21	165.20	S89°31'47\"W
22	661.46	N 0°08'25\"E
23	496.02	S89°31'44\"W
24	661.44	N 0°06'15\"E
25	661.92	S89°31'41\"W
26	1322.88	N 0°03'22\"E
27	331.51	S89°31'35\"W
28	661.42	N 0°01'55\"E
29	663.58	N89°31'31\"E
30	661.44	N 0°04'48\"E
31	1328.28	N89°31'28\"E
32	330.74	N 0°10'34\"E
33	332.21	N89°31'27\"E
34	330.74	N 0°12'01\"E

CERTIFICATE OF SURVEY Field Book No. 1-202 Date Aug. 31, 1972

I HEREBY CERTIFY THAT THE ABOVE PLAT IS A TRUE AND CORRECT REPRESENTATION OF THE SURVEY MADE IN SECTION 24, T 5 N, R 23 E, OF FLORE COUNTY, OKLAHOMA

BEAVERS & BRAWLEY, INC.
CONSULTING ENGINEERS

LEGEND
Δ MONUMENT
□ ORIGINAL CORNER
○ IRON PIN

Under the Supervision of

U.S. ARMY ENGINEER DISTRICT, TULSA
CORPS OF ENGINEERS

Charles S. Brawley

WISTER LAKE
POTEAU RIVER, OKLAHOMA

SECTION AND QUARTER SECTION CORNER
REFERENCES FOR
SEC.-24 , T 5 N, R23 E COUNTY-LE FLORE



N.W. CORNER

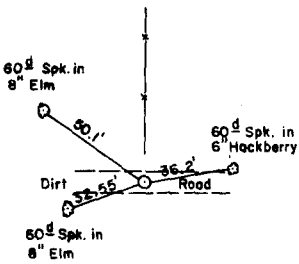

NORTH 1/4 CORNER

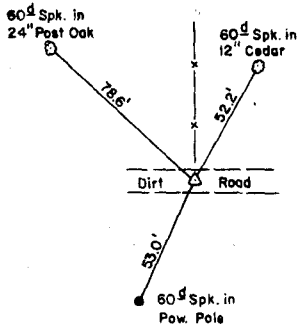

N.E. CORNER

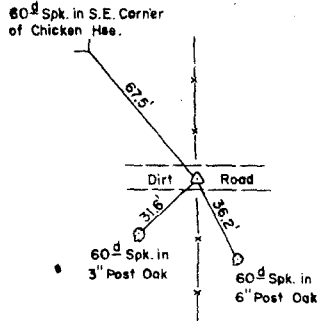

WEST 1/4 CORNER

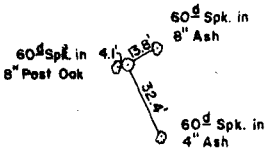

EAST 1/4 CORNER

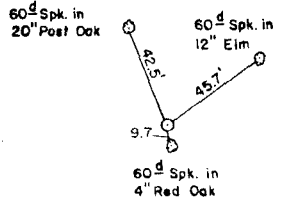

S.W. CORNER

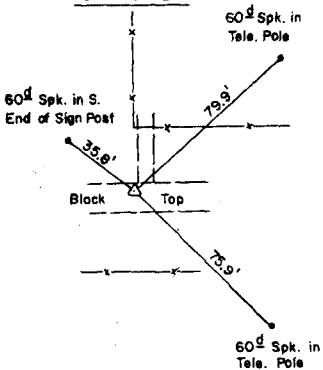

SOUTH 1/4 CORNER

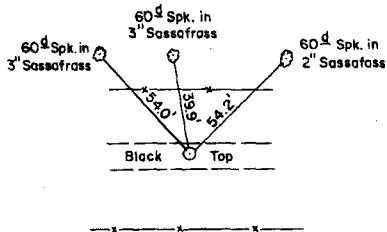

S.E. CORNER

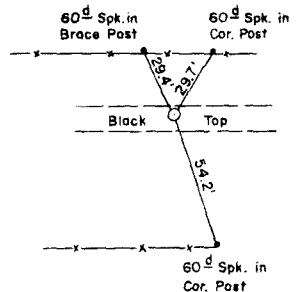

Scale: 1" = 50'

Date: Aug. 31, 1972

Field Book No. 1-202

LEGEND

- △ Monument
- Original Corner
- Iron Pin