

WISTER LAKE POTEAU RIVER OKLAHOMA

SECTION AND QUARTER SECTION CORNER
REFERENCES FOR

SEC. 34 T.5N., R.24E., 1 M., COUNTY-LE FLORE

N.W. CORNER

N.E. CORNER

NORTH 1/4 COR.

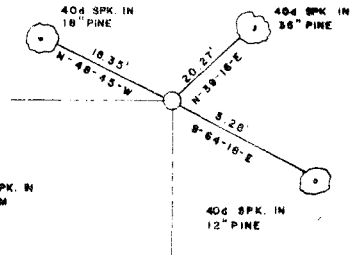
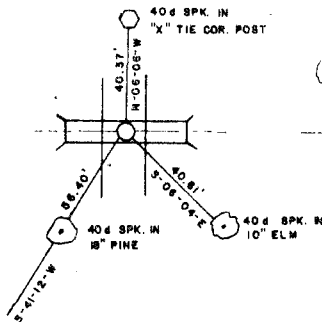
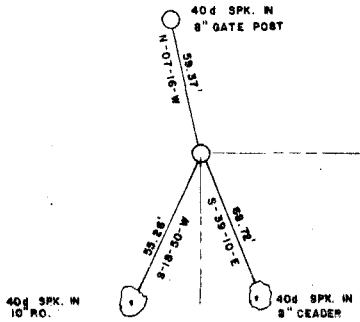

WEST 1/4 COR.

EAST 1/4 COR.

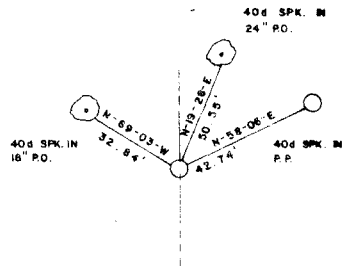
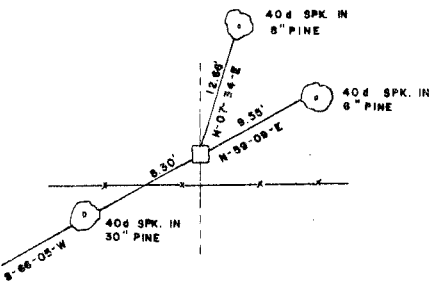

S.W. CORNER

SOUTH 1/4 COR.

S.E. CORNER

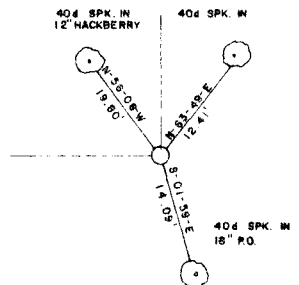
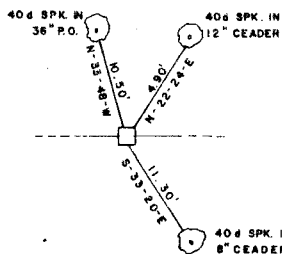
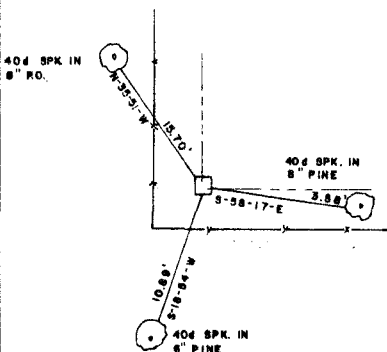

Field Book No. J-244 Date SEP. 1977

LEGEND

- ▲ — MONUMENT FOUND
- △ — MONUMENT SET
- — ORIGINAL CORNER
- — IRON PIN FOUND
- — IRON PIN SET

CURTIS B GUINN SURVEYING
STONEWALL, OKLA.

Curtis B. Guinn

REGISTERED LAND SURVEYOR NO. 605

Under the Supervision of
U.S. ARMY CORPS OF ENGINEERS
TULSA DISTRICT, OKLAHOMA