

**PARTIAL BOUNDARY SURVEYS  
WISTER RESERVOIR  
POTEAU RIVER, OKLAHOMA**

Performed Under Contract Number **DACW56-70-C-0086**

**SEC 5      T 5 N      R 24 E      COUNTY LEFLORE**

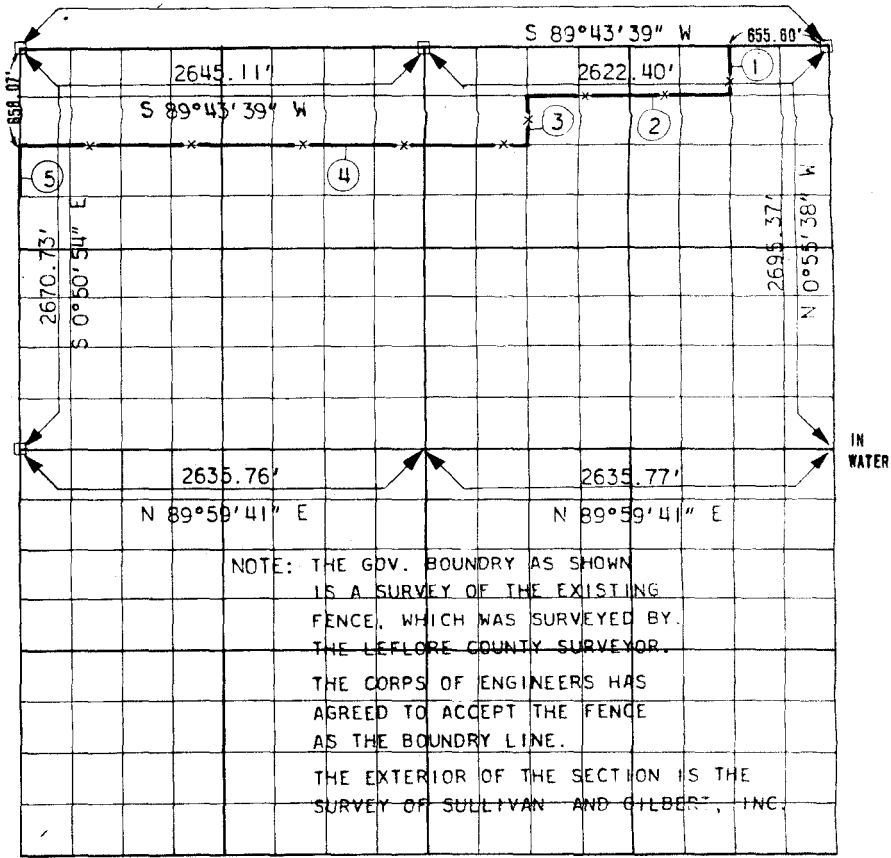

Course No.	Distance	Bearing	Course No.	Distance	Bearing
1	320.48'	S 0°49'58" W			
2	1300.57'	S 89°16'23" W			
3	325.94'	S 0°13'11" E			
4	3299.78'	S 89°42'12" W			
5	326.86'	S 0°30'40" E			

CERTIFICATE OF SURVEY Field Book No. 1-164 Date 7-18-70

I HEREBY CERTIFY THAT THE ABOVE PLAT IS A TRUE AND CORRECT REPRESENTATION OF THE SURVEY MADE IN SECTION 5, T 5 N, R 24 E LEFLORE COUNTY, OKLAHOMA.

**SULLIVAN & GILBERT, INC.**

Under the Supervision of

**U.S. ARMY ENGINEER DISTRICT, TULSA  
CORPS OF ENGINEERS**

**LEGEND**  
 Δ MONUMENT  
 □ ORIGINAL CORNER  
 ○ IRON PIN

*[Signature]*  
 REGISTERED PROFESSIONAL ENGINEER